

AGENDA

Raymore City Council Regular Meeting
City Hall – 100 Municipal Circle
Monday, March 25, 2019

7:00 p.m.

1. Call to Order.

2. Roll Call.

3. Pledge of Allegiance.

4. Presentations/Awards.

- Harriet Lawrence, Arts Commission Chairwoman

5. Personal Appearances.

6. Staff Reports.

- A. Status of Capital Improvements (pg 7)
- B. Public Works (pg 15)
- C. Parks and Recreation (pg 17)
- D. Police Department
- E. Communications Report
- F. Monthly Financial Report (pg 23)

7. Committee Reports.

8. Consent Agenda.

The items on the Consent Agenda are approved by a single action of the City Council. If any Councilmember would like to have an item removed from the Consent Agenda and considered separately, he/she may so request.

- A. City Council Minutes, March 11, 2019 (pg 33)

9. Unfinished Business. Second Reading.

- A. Regulation of Open Burning

Reference: - Agenda Item Information Sheet (pg 43)

- Bill 3439 (pg 45)

Due to recent changes made to the Missouri open burning regulation that eliminated many of the state requirements on open burning, staff is proposing to add Chapter 285: Regulations for Open Burning to the City Code of Ordinances.

- City Council, 03/11/2019: Approved 7-0

B. Nullify Current Annexation Plan of Intent

Reference: - Agenda Item Information Sheet (pg 49)
- Bill 3440 (pg 51)
- Current Annexation Plan of Intent (pg 53)

In 2006 there was an effort to annex three distinct areas situated east of the current City boundary. A plan of intent was prepared for each of the three proposed annexation areas. With the current discussion on annexation of areas east of the current City boundary it is appropriate to nullify the three Plan of Intents to Annex documents.

- City Council, 03/11/2019: Approved 7-0

C. Award of Contract - Municipal Circle Street Light Installation

Reference: - Agenda Item Information Sheet (pg 113)
- Bill 3442 (pg 115)
- Proposal (pg 117)

This project calls for the replacement of decorative lighting along Skyline and Broadmoor Drive within the Municipal Complex. Staff is recommending award of this contract to Black & McDonald.

- City Council, 03/11/2019: Approved 7-0

10. New Business. First Reading.

A. Award of Contract - Buckingham Ct. Street Light Installation

Reference: - Agenda Item Information Sheet (pg 121)
- Bill 3444 (pg 123)
- Proposal (pg 125)

This project calls for the installation of street lights at Buckingham Ct. and 163rd St. Staff is recommending award of this contract to Black & McDonald.

11. Public Comments. Please identify yourself for the record and keep comments to a maximum of five minutes.

12. Mayor/Council Communication.

13. Adjournment.

Items provided under "Miscellaneous" in the Council Packet:

- City Council Work Session notes, 02/18/19 (pg 129)
-

EXECUTIVE SESSION (CLOSED MEETING)

The Raymore City Council may enter an executive session before or during this meeting, if such action is approved by a majority of Council present, with a quorum, to discuss:

- Litigation matters as authorized by § 610.021 (1),
- Real Estate acquisition matters as authorized by § 610.021 (2),
- Personnel matters as authorized by § 610.021 (3),
- Other matters as authorized by § 610.021 (4-21) as may be applicable.

Any person requiring special accommodation (i.e., qualified interpreter, large print, hearing assistance) in order to attend this meeting, please notify this office at (816) 331-3324 no later than forty eight (48) hours prior to the scheduled commencement of the meeting.

Hearing aids are available for this meeting for the hearing impaired. Inquire with the City Clerk, who sits immediately left of the podium as one faces the dais.

Staff Reports

Status of Capital Improvements - Projects not yet started

Category	Project	Fiscal Year	Budget Amount	Milestone/Next Steps
Parks & Recreation	Trail Lighting	2017	\$100,000	
Stormwater	Cul-de-sac Program	2017	\$100,000	
Buildings & Grounds	City Hall Exterior Painting	2019	\$47,000	
Parks & Recreation	T.B. Hanna Park Security Camera	2019	\$15,525	
Parks & Recreation	Memorial Park Playground Improvements	2019	\$48,000	
Parks & Recreation	Memorial Park Arboretum Light Replacement	2019	\$26,000	
Sanitary	Harold Estates Sanitary Sewer Extension	2019	\$500,000	
Sanitary	Evan Brook Sewer Repair	2019	\$18,000	
Transportation	Right of Way Infrastructure Repairs	2019	\$150,000	
Transportation	Shadowood Settlement Investigation	2019	\$30,000	

Status of Capital Improvements - Projects in planning/bid stage

Category	Project	Fiscal Year	Budget Amount	Milestone/Next Steps
Buildings & Grounds	City Hall Lower Level Fire Suppression Modification	2016	\$45,000	
Stormwater	Detention Pond Rehab/Beautification Partnership	2017	\$50,000	
Stormwater	City Hall Detention Pond	2017	\$80,000	
Stormwater	Municipal Center BMP's	2017	\$80,000	
Community Developm	GO Contingency/T.B. Hanna	2017	\$301,500	
Transportation	Lucy Webb Roundabout Additional Lighting	2018	\$12,000	
Sanitary	Lift Station Emergency Generators	2018	\$94,500	
Water	Sensus Meter Reading System	2018	\$150,000	
Community Developm	GO Project Support	2018	\$217,394	
Transportation	Street Light Installation	2018	\$15,000	
Sanitary	Sanitary Sewer Inflow and Infiltration Reduction	2019	\$126,075	
Sanitary	Owen Good Force Main Repairs	2019	\$700,000	
Stormwater	Annual Curb Replacement Program	2019	\$200,000	
Transportation	Annual Curb Replacement Program	2019	\$400,000	
Transportation	Annual Street Preservation Program	2019	\$800,000	
Water	Hydrant Replacement	2019	\$112,000	
Stormwater	Culvert Replacement	2019	\$35,000	
Buildings & Grounds	Municipal Circle Light Replacement	2019	\$50,000	
Transportation	Maintenance of Thoroughfare Routes	2019	\$200,000	

Status of Capital Improvements - Projects in planning/bid stage

Category	Project	Fiscal Year	Budget Amount	Milestone/Next Steps
Buildings & Grounds	Parks Maintenance Facility Door Access System	2019	\$8,400	
Stormwater	Storm/Sanitary Sewer Camera	2019	\$110,000	

Status of Capital Improvements - Projects under construction

Category	Project	Fiscal Year	Budget Amount	Milestone/Next Steps
Parks & Recreation	Hawk Ridge Park Walking Trail - Lake Loop	2015	\$160,000	
Transportation	Construction of Sunset Lane Gap	2016	\$350,000	
Parks & Recreation	Hawk Ridge Park Phase (I-b) ADA Dock	2016	\$45,000	
Parks & Recreation	Hawk Ridge Park Phase (I-c) Restroom	2016	\$90,000	
Buildings & Grounds	City Hall Front Entry Repair	2017	\$242,000	
Buildings & Grounds	Public Works Facility Roof Repair	2017	\$203,000	
Buildings & Grounds	Security Cameras at Parks & Public Works	2017	\$35,000	
Buildings & Grounds	Internet and Public Wifi in the Parks	2017	\$33,500	
Water	Sensus Meter Reading System	2017	\$150,000	
Buildings & Grounds	City Hall Lobby Modifications	2018	\$40,000	
Buildings & Grounds	City Hall LED Lighting Upgrades	2018	\$13,250	
Community Developm	GO Hawk Ridge Park Support	2018	\$382,606	
Parks & Recreation	Recreation Park Picnic Pavilion	2018	\$210,000	
Transportation	Johnston Drive Street Light	2018	\$8,000	
Parks & Recreation	Recreation Park Pedestrian Bridge Replacements	2018	\$55,000	
Parks & Recreation	Hawk Ridge Park Security Cameras	2019	\$31,000	
Parks & Recreation	Recreation Park Ballfield Lights	2019	\$90,000	
Parks & Recreation	Recreation Park Pond	2019	\$150,000	

Status of Capital Improvements - Projects under construction

Category	Project	Fiscal Year	Budget Amount	Milestone/Next Steps
Parks & Recreation	Projector and Screen Raymore Activity Center	2019	\$13,200	

Status of Capital Improvements - Projects finished with major construction

Category	Project	Fiscal Year	Budget Amount	Milestone/Next Steps
Sanitary	Sanitary Sewer Inflow and Infiltration Reduction	2018	\$123,000	
Buildings & Grounds	Public Works LED Lighting Upgrades	2018	\$10,500	
Stormwater	Annual Curb Replacement Program	2018	\$100,000	
Stormwater	North Washington Street Culvert Replacement	2018	\$33,000	
Stormwater	Stormwater Culvert Replacement	2018	\$28,000	
Transportation	Annual Curb Replacement Program	2018	\$400,000	
Transportation	Annual Street Preservation Program	2018	\$800,000	
Transportation	Maintenance of Thoroughfare Routes	2018	\$125,000	
Sanitary	Sanitary Sewer Inflow and Infiltration Reduction	2018	\$123,000	
Stormwater	Permeable Pavers Crosswalks	2018	\$176,685	
Transportation	Hubach Hill Road Street Light	2018	\$8,000	
Buildings & Grounds	Building Door Access System	2019	\$36,000	

Status of Capital Improvements - Projects finalized out and accepted by City Council						
Category	Project	Fiscal Year	Budget Amount	Total Expenditure	Remaining Funds	Additional Notes
Buildings & Grounds	Police Firing Range	2016	\$46,842		N/A	N/A Jan. 28, 2019 Moved to the Restricted Revenue Fund for future lease expenses
Parks & Recreation	Ward Park Shelter Facility	2017	\$6,500	\$2,647	\$3,853	Completed in-house, final acceptance not required; proj 289
Parks & Recreation	Raymore Arboretum	2017	\$10,000	\$7,875	\$2,125	Completed in-house, final acceptance not required; proj 300
Buildings & Grounds	City Hall Phone System	2017	\$45,000	\$46,147	-\$1,147	Accepted Oct, 8, 2018
Stormwater	FY17 Stormwater Improvements	2017	\$74,000	\$77,691	-\$3,691	Resolution 18-32 June 11, 2018; proj 278
Sanitary	Silvertop Sewer Replacement	2017	\$69,247	\$60,062	\$9,185	Bill 3299 9/26/17 increased budget by \$9,247. Resolution 18-50 Sept 24, 2018; proj 274
Transportation	Annual Curb Replacement Program	2018	\$400,000	\$398,954	\$1,046	proj 294
Stormwater	Annual Curb Replacement Program	2018	\$100,000	\$100,000	\$0	proj 294
Parks & Recreation	Recreation Park Pedestrian Safety E	2018	\$100,000	\$100,412	-\$412	Resolution 18-65, Oct. 22, 2018; proj 291
Transportation	Annual Sidewalk Program	2018	\$117,000	\$92,786	\$24,214	Resolution 19-06, Jan. 28, 2019; proj 310
Sanitary	Owen Good Overflow Valve Replace	2018	\$30,000	\$29,899	\$101	Resolution 19-09 Feb 11, 2019; proj 312; C/O 1 of \$2,916 paid from Fund 50 so project didn't go over. Actual project cost \$32,814.60
Water	Star Drive Water Main	2019	\$53,000	\$28,909	\$24,091	Completed as an emergency repair, site resoration still to be completed. PO19-9643; proj 324

Status of Capital Improvements - Projects finalized and accepted by City Council											
Category	Project	Fiscal Year	Bond Amount	GO Premium Applied	GO Interest Earnings	Capital Funds Applied	Total Funding Available	Total Expenditure	Remaining Funds	Additional Notes	
Parks GO Bond	Centerview	2017	\$1,500,000	\$200,000		\$1,815,250	\$3,515,250	\$3,611,409	-\$96,159	proj 227	
Parks GO Bond	Activity Center at Recreation Park	2017	\$2,843,000	\$109,573	\$115,118	\$278,758	\$3,346,449			proj 229	
Parks GO Bond	Hawk Ridge Park Additional Signage	2017	\$85,000	\$198,227			\$283,227			proj 253	
Parks GO Bond	Hawk Ridge Park Amphitheater	2017	\$675,100				\$675,100			proj 253	
Parks GO Bond	Hawk Ridge Park Parking Lot Expansion & ADA Playground	2017	\$700,000				\$700,000			proj 253	
Parks GO Bond	Recreation Park Trail Rehabilitation	2017	\$55,000				\$55,000	\$55,000		proj 237-205	
Parks GO Bond	T.B. Hanna Station Amenities	2017	\$600,000			\$301,500	\$901,500				
Transportation GO Bond	Foxridge Drive	2016	\$700,000				\$700,000	\$701,110	-\$1,110	proj 249	
Transportation GO Bond	Johnston Drive	2016	\$350,000	\$80,000		\$54,750	\$484,750	\$437,538	\$47,212	proj 243	
Transportation GO Bond	Kentucky Construction	2016	\$700,000	\$199,669	\$22,160		\$921,829	\$67,851	\$853,978	proj 242	
Transportation GO Bond	58 Highway Overlay	2016	\$1,400,000				\$1,400,000	\$1,335,604	\$64,396	proj 245	



PUBLIC WORKS MONTHLY REPORT

March 2019

ENGINEERING DIVISION

Projects Under Construction

- 155th Street - Phase III Overlay Madison to Kurzweil
- Hawkridge Park

Projects Under Design

- Kentucky Road
- FY 2019 Curb Replacement Program
- FY 2019 Street Preservation
- Owen Good Force Main Replacement
- Dean Avenue Meter Vault

Development Under Construction

- Heritage Hills
- Edgewater
- Meadowood
- Westbrook at Creekmoor

Developments Under Review

- Prairie View of the Good Ranch
- Dean Commercial Site

OPERATIONS & MAINTENANCE DIVISION

- 3 Water Taps
- 6 Sewer Inspections
- 3 Water Inspections
- 339 Line Locates
- 125 City Hall Work Orders
- 11 Driveway Approach Inspections
- 7 Sidewalk Inspections
- 4 Final ROW Inspections
- 9 Meter Conversions
- 44 Feet of Sewer Main Televised
- 339 Potholes Patched
- 100 Service Requests Completed

MONTHLY REPORT

March 2019

HIGHLIGHTS

- Parks and Recreation Director Nathan Musteen and staff members Steve Rulo, John McLain and Katie VanKeulen attended the 60th Annual Missouri Parks and Recreation Association Conference and Exhibit Hall at the Branson Convention Center.
- Athletic Coordinator Todd Brennon held a coaches meeting for the spring recreation soccer season.
- Parks maintenance staff worked several winter weather events
- Park maintenance staff prepared and serviced equipment in preparation for the spring mowing season.
- Recreation Coordinator Katie VanKeulen prepared and held the 1st Spring Craft Show on March 9 at the RAC. Over forty vendors participated in the event with an estimated 500 patrons attending the event.
- Park maintenance staff repaired field equipment and began preparing athletic fields for the upcoming soccer and baseball/softball seasons.
- Park maintenance staff worked on the post office building at T.B. Hanna Station in preparation for the upcoming restoration project.
- The 2019 youth basketball league ended on March 9th.
- The recreation soccer practices began in early March. Athletic Coordinator Todd Brennon participated in the South Metro Sports soccer scheduling meeting, games are set to begin March 23.
- The youth volleyball coaches meeting was held March 7, practices began March 11 and games are scheduled to begin April 6..
- Director Nathan Musteen attended the South Metro Parks & Recreation Directors meeting.





- Recreation Superintendent John McLain attended the National Parks and Recreation Revenue Management School.
- Athletic Coordinator Todd Brennon participated in the volleyball and soccer scheduling meeting of the South Metro Sports Group. The meeting was held at Centerview on March 12.
- Recreation Coordinator Katie VanKeulen began stuffing Easter Eggs in preparation for the upcoming Easter Festival on April 20. Over 15,000 eggs will be stuffed with candy and prizes.
- Recreation Coordinator Katie VanKeulen held the Spring Break Camp at the RAC. Twenty-one kids registered for the camp
- Parks Maintenance installed nets and set goals in place on the soccer fields in preparation of opening day on March 23.
- Parks and Recreation Director Nathan Musteen worked on the Christopher and Dana Reeve Foundation Grant.
- Parks and Recreation Director Nathan Musteen and Parks Superintendent Steve Rulo worked with CFS Engineers to finalize scope of work for improvements at T.B. Hanna Station.
- Park restrooms at Memorial Park and the Soccer Concession stand were prepped and opened for the soccer season.
- Recreation staff prepared for the summer program guide scheduled for distribution in May.

PARKS & RECREATION BOARD

March 12 - 5 Year Capital Improvement program
March 26 - Action Items scheduled: Screen Printing Contract and Pepsi Americas Contract Amendment, Budget Amendment

CENTERVIEW

- Wedding
- Memorial Service
- Bible Study
- HOA Meetings
- Hope Haven Breakfast
- Garden Club
- Tri-County Art League Meeting
- Book Club Meeting
- Chamber Of Commerce Luncheon
- Police Training
- Cass County Democratic Party Meeting



- Family Art Day

RAC - Raymore Activity Center

- Birthday Partys (2)
- Sport Practices
- Karate classes
- Basketball games
- Yoga class
- Fitness class
- Volleyball practices
- Spring Break Camp

RECREATION PROGRAMS & SPECIAL EVENTS

YOUTH BASEBALL & SOFTBALL LEAGUES



Tee Ball

The Tee Ball League is for boys and girls ages 5 years old by scheduled practice start date or currently in Kindergarten. This program is designed to emphasize fun, participation and teamwork. Girls and boys will be combined. Volunteer coaches are used for this program.

Recreation Baseball/Softball

The Recreation Baseball/Softball Leagues are for boys and girls Grades 1 through 8. This program is designed with an emphasis on fun, participation and teamwork. Participants are guaranteed playing time in the field and at bat. We use volunteer coaches and they are allowed to bring in five kids to their roster. The rest of the roster will be completed by a blind draw by the Parks and Recreation office. Scores are kept during the games and are tracked throughout the season. Each child receives a participation award at the conclusion of the season. This league is part of the South Metro Sports Group so some

divisions may travel to other cities to play games.

DIVISION	FEES
T-Ball Kindergarten Co-Ed	\$65
1st/2nd Grade Girls Coach Pitch	\$85
1st/2nd Grade Boys Machine Pitch	\$85
3rd/4th Grade Girls Player Pitch Softball	\$95
3rd/4th Grade Boys Player Pitch Baseball	\$95
5th/6th & 7th/8th Grade Girls Softball	\$95
5th/6th & 7th/8th Grade Boys Baseball	\$95

Season: April -June

Location: Recreation Park

Register by: Friday, March 29, 5 p.m.

CITY OF RAYMORE'S

FRIDAY FOOD fest

March
22nd

6 to
8:30
p.m.

JOIN US AT
**MEMORIAL
PARK**



**FOOD
TRUCKS**

**LIVE
MUSIC**
6:30-8 P.M.

**FAMILY
FUN**

TOUCH A TRUCK



April 6
9 a.m. to 12 p.m.
Recreation Park

Join Raymore Parks & Recreation for a FREE open house of large vehicles and equipment trucks. Get up close and personal with fire trucks, dump trucks, lift trucks, earth movers, motor coaches, and MORE! There will also be give-aways for the kids while supplies last.

Sponsored by
R.L. Hannah & Sons Trucking, Inc.



FREE UMPIRE TRAINING

Our parks will be hopping all summer long with softball and baseball games. Want to be an umpire? We're offering free training to prepare umpires for the season!

Each session will cover different topics. Topics covered will include mechanics, correct field positioning, how to handle disputes, correct uniform attire and more.

For more information and to apply, contact Athletic Coordinator Todd Brennan at TBrennon@Raymore.com or 816-322-2791.

Applicants must be at least 15 years old.

Indoor training: Tuesday, May 7 and Tuesday May 14 6:30-8 p.m. at Centerview, 227 Municipal Circle	On field training: Thursday May 9 and Thursday May 16 5:30-7 p.m. at Recreation Park, 1011 S. Madison St.
--	---



City of Raymore's Annual

EASTER FESTIVAL

April 20 • Memorial Park
Hunt begins at 10 a.m.
Arrive by 9:45 a.m.

Ages 4th grade & under
(Bring your own basket!)

FREE activities include:

- 15,000 eggs to hunt
- Pictures with the Easter Bunny
- Refreshments
- And more!

Watch for the
Coloring Contest in
the Classroom, in
cooperation with the
Raymore-Peculiar
School District.





FINANCE MONTHLY REPORT

This report, consisting of a Financial Summary, Investment Summary and Grant Summary, has been prepared for the fiscal period February 1, 2019 to February 28, 2019.

February Financial Summary

Some notes regarding this month's summary operating report:

General Fund

Revenue:

Overall, at 33.33% of the way through the fiscal year, General Fund revenues are generally tracking as expected with total collected revenue of 45.18% of budget. Inter-fund transfers are being completed on a monthly basis with the exception of the Capital Funds Transfer. The Capital Funds Transfers will occur throughout the year after the capital project has been accepted by the Council and final payments have been made.

- Property tax revenues collected are tracking as expected at 96.13%. Staff expects this revenue source to come in at budget.
- Franchise Tax revenues as a whole are tracking below straight line. This revenue source varies depending on the weather, staff will continue to monitor this closely throughout the year.
- Sales tax revenues as a whole are tracking slightly below straight line budget at 32.28%. City sales taxes are at 32.37% while state shared gasoline and vehicle taxes are at 31.33%.
- Fees and Permit revenues collected are tracking ahead of straight line budget at 54.52%. This is primarily due to Engineering Inspection Fees & Plan Review Fees for 2 new phases in the Creekmoor Subdivision.
- License revenues collected are tracking as expected at 67.17% of straight line budget. Occupational license revenues collected are tracking as expected. Staff anticipates additional revenue throughout the spring for new builders to the area. Liquor licenses are due in May and processed after the public hearing.
- Municipal Court revenues collected are slightly above straight line budget at 38.67%. Staff will continue to monitor this revenue source closely throughout the year.

Expenditures:

Departmental spending is tracking normally. Most of the departments are right at straight line expectation or slightly higher due to the three pay-periods occurring this year in November.

- The Information Technology Department has replaced the majority of the computers scheduled for replacement, and has renewed 50% of the annual software maintenance agreements, putting it above straight line budget.
- The Emergency Management Department is currently at 36.49% of straight line budget primarily due to the payment of the siren maintenance contract.

Parks & Recreation Fund

Revenue:

Revenues are at 46.70% of budget 33.33% of the way through the year; normal for this time of the year. Recreation revenues are expected to increase in March with baseball/softball registrations as well as spring break camp registrations. This will be followed by revenues associated with summer youth camp registrations in April, camp fees throughout the summer and flag football and volleyball in the fall. Revenue associated with the facility rental of Centerview is above straight line budget at 39.69%. Staff will continue to monitor this revenue closely throughout the year.

Expenditures:

Both the Parks and Recreation departments are showing the same operational expenditure pattern as in years past, and are tracking normally. Expenditures are expected to increase as the number of programs offered goes up.

Enterprise Fund

Revenue:

Utility revenues as a whole are tracking at 31.69% of straight line budget. Staff will continue to monitor all utility revenue closely throughout the year.

Expenditures:

Enterprise Fund expenditures tracking below straight line budget but at expectations.

01 -GENERAL FUND
 FINANCIAL SUMMARY

	PRIOR YEAR ENDING PO BAL.	PRIOR YEAR PO ADJUST.	REMAINING PRIOR YEAR PO BALANCE	CURRENT BUDGET	CURRENT PERIOD	YEAR TO DATE ACTUAL	TOTAL ENCUMBRANCE	BUDGET BALANCE	% OF BUDGET
<u>REVENUE SUMMARY</u>									
<u>NON-DEPARTMENTAL</u>									
PROPERTY TAXES	0.00	0.00	0.00	1,500,359.00	36,697.37	1,442,258.33	0.00	58,100.67	96.13
FRANCHISE TAXES	0.00	0.00	0.00	2,245,694.00	154,972.57	676,114.58	0.00	1,569,579.42	30.11
SALES TAXES	0.00	0.00	0.00	3,543,609.00	292,585.50	1,144,029.59	0.00	2,399,579.41	32.28
FEES AND PERMITS	0.00	0.00	0.00	237,788.00	13,046.80	129,653.34	0.00	108,134.66	54.52
LICENSES	0.00	0.00	0.00	133,053.00	9,173.75	89,366.66	0.00	43,686.34	67.17
MUNICIPAL COURT	0.00	0.00	0.00	320,884.00	35,349.59	124,096.72	0.00	196,787.28	38.67
MISCELLANEOUS	(8.08)	8.08	0.00	388,342.00	10,099.73	346,287.31	7.07	42,047.62	89.17
TRANSFERS - INTERFUND	0.00	0.00	0.00	1,464,280.00	126,407.94	490,977.96	0.00	973,302.04	33.53
TOTAL NON-DEPARTMENTAL	(8.08)	8.08	0.00	9,834,009.00	678,333.25	4,442,784.49	7.07	5,391,217.44	45.18
TOTAL REVENUES	(8.08)	8.08	0.00	9,834,009.00	678,333.25	4,442,784.49	7.07	5,391,217.44	45.18
<u>EXPENDITURE SUMMARY</u>									
NON-DEPARTMENTAL	0.00	0.00	0.00	932,190.00	67,333.33	269,333.32	0.00	662,856.68	28.89
ADMINISTRATION	499.70	499.70	0.00	1,047,981.00	80,771.05	299,532.47	15,201.98	733,246.55	30.03
INFORMATION TECHNOLOGY	0.00	0.00	0.00	457,560.60	30,022.16	182,995.79	3,142.73	271,422.08	40.68
ECONOMIC DEVELOPMENT	0.00	0.00	0.00	186,783.00	10,043.25	58,758.80	1,500.00	126,524.20	32.26
COMMUNITY DEVELOPMENT	22.28	22.28	0.00	674,032.00	51,261.61	224,346.23	167.33	449,518.44	33.31
ENGINEERING	121.34	121.34	0.00	420,592.00	33,927.05	144,506.05	2,351.88	273,734.07	34.92
STREETS	0.00	0.00	0.00	864,408.00	61,139.86	249,139.47	30,465.07	584,803.46	32.35
BUILDING & GROUNDS	5,832.79	5,832.79	0.00	374,280.20	28,288.29	117,910.66	(3,859.65)	260,229.19	30.47
STORMWATER	0.00	0.00	0.00	301,313.00	24,277.82	103,619.05	7.60	197,686.35	34.39
COURT	0.00	0.00	0.00	124,399.00	11,055.41	42,598.01	0.00	81,800.99	34.24
FINANCE	0.00	0.00	0.00	625,566.00	41,882.61	218,971.98	4,161.88	402,432.14	35.67
COMMUNICATIONS	0.00	0.00	0.00	302,946.00	14,709.96	72,773.61	574.20	229,598.19	24.21
PROSECUTING ATTORNEY	0.00	0.00	0.00	24,940.00	2,000.00	6,000.00	2,000.00	16,940.00	32.08
POLICE	1,851.00	1,851.00	0.00	4,314,707.00	297,444.40	1,348,695.91	9,064.04	2,956,947.05	31.47
EMERGENCY MANAGEMENT	0.00	0.00	0.00	130,550.00	8,760.00	45,724.66	1,916.45	82,908.89	36.49
TOTAL EXPENDITURES	8,327.11	8,327.11	0.00	10,782,247.80	762,916.80	3,384,906.01	66,693.51	7,330,648.28	32.01
REVENUES OVER/(UNDER) EXPENDITURES	(8,335.19)	8,335.19	0.00	(948,238.80)	(84,583.55)	1,057,878.48	(66,686.44)	(1,939,430.84)	104.53-

25 -PARK FUND
 FINANCIAL SUMMARY

	PRIOR YEAR ENDING PO BAL.	PRIOR YEAR PO ADJUST.	REMAINING PRIOR YEAR PO BALANCE	CURRENT BUDGET	CURRENT PERIOD	YEAR TO DATE ACTUAL	TOTAL ENCUMBRANCE	BUDGET BALANCE	% OF BUDGET
<u>REVENUE SUMMARY</u>									
<u>NON-DEPARTMENTAL</u>									
<u>PARKS DIVISION</u>									
PROPERTY TAXES	0.00	0.00	0.00	402,780.00	9,877.23	388,188.87	0.00	14,591.13	96.38
MISCELLANEOUS	0.00	0.00	0.00	7,967.00	1,109.84	9,931.91	0.00	(1,964.91)	124.66
FACILITY RENTAL REVENUE	0.00	0.00	0.00	6,080.00	100.00	170.00	0.00	5,910.00	2.80
TRANSFERS - INTERFUND	0.00	0.00	0.00	450,000.00	37,500.00	150,000.00	0.00	300,000.00	33.33
TOTAL PARKS DIVISION	0.00	0.00	0.00	866,827.00	48,587.07	548,290.78	0.00	318,536.22	63.25
<u>RECREATION DIVISION</u>									
CONCESSION REVENUE	0.00	0.00	0.00	62,000.00	5.50	431.50	0.00	61,568.50	0.70
FACILITY RENTAL REVENUE	0.00	0.00	0.00	22,200.00	0.00	2,328.75	0.00	19,871.25	10.49
PROGRAM REVENUE	0.00	0.00	0.00	227,520.00	35,347.50	59,439.75	(40.00)	168,120.25	26.11
TOTAL RECREATION DIVISION	0.00	0.00	0.00	311,720.00	35,353.00	62,200.00	(40.00)	249,560.00	19.94
<u>CENTERVIEW</u>									
FACILITY RENTAL REVENUE	0.00	0.00	0.00	50,205.00	4,892.50	19,924.99	0.00	30,280.01	39.69
PROGRAM REVENUE	0.00	0.00	0.00	2,600.00	390.00	2,025.00	0.00	575.00	77.88
TOTAL CENTERVIEW	0.00	0.00	0.00	52,805.00	5,282.50	21,949.99	0.00	30,855.01	41.57
<u>RAYMORE ACTIVITY CENTER</u>									
MISCELLANEOUS	0.00	0.00	0.00	2,340.00	0.00	0.00	0.00	2,340.00	0.00
CONCESSION REVENUE	0.00	0.00	0.00	7,650.00	455.00	590.00	0.00	7,060.00	7.71
FACILITY RENTAL REVENUE	0.00	0.00	0.00	13,050.00	595.00	1,532.50	0.00	11,517.50	11.74
PROGRAM REVENUE	0.00	0.00	0.00	146,800.00	6,935.01	19,860.01	0.00	126,939.99	13.53
TOTAL RAYMORE ACTIVITY CENTER	0.00	0.00	0.00	169,840.00	7,985.01	21,982.51	0.00	147,857.49	12.94
TOTAL REVENUES	0.00	0.00	0.00	1,401,192.00	97,207.58	654,423.28	(40.00)	746,808.72	46.70
<u>EXPENDITURE SUMMARY</u>									
PARKS DIVISION	0.00	0.00	0.00	732,989.00	48,796.53	212,657.43	4,672.00	515,659.57	29.65
RECREATION DIVISION	0.00	0.00	0.00	537,076.00	32,987.81	144,555.54	664.94	391,855.52	27.04
CENTERVIEW	182.79	182.79	0.00	49,255.00	2,561.45	6,428.22	79.72	42,747.06	13.21
RAYMORE ACTIVITY CENTER	0.00	0.00	0.00	81,172.00	4,044.11	13,085.82	878.90	67,207.28	17.20
TOTAL EXPENDITURES	182.79	182.79	0.00	1,400,492.00	88,389.90	376,727.01	6,295.56	1,017,469.43	27.35
REVENUES OVER/(UNDER) EXPENDITURES	(182.79)	182.79	0.00	700.00	8,817.68	277,696.27	(6,335.56)	(270,660.71)	8,765.82

50 -ENTERPRISE FUND
 FINANCIAL SUMMARY

	PRIOR YEAR ENDING PO BAL.	PRIOR YEAR PO ADJUST.	REMAINING PRIOR YEAR PO BALANCE	CURRENT BUDGET	CURRENT PERIOD	YEAR TO DATE ACTUAL	TOTAL ENCUMBRANCE	BUDGET BALANCE	% OF BUDGET
<u>REVENUE SUMMARY</u>									
<u>NON-DEPARTMENTAL</u>									
MISCELLANEOUS	0.00	0.00	0.00	40,107.00	4,008.60	31,093.70	0.00	9,013.30	77.53
UTILITY REVENUE	0.00	0.00	0.00	7,973,028.00	605,409.55	2,503,739.60	0.00	5,469,288.40	31.40
TOTAL NON-DEPARTMENTAL	0.00	0.00	0.00	8,013,135.00	609,418.15	2,534,833.30	0.00	5,478,301.70	31.63
<u>DEBT SERVICE</u>									
<u>SRF SEWER BONDS</u>									
MISCELLANEOUS	0.00	0.00	0.00	8,337.00	0.00	4,553.65	0.00	3,783.35	54.62
TRANSFERS - INTERFUND	0.00	0.00	0.00	145,000.00	12,083.33	48,333.32	0.00	96,666.68	33.33
TOTAL SRF SEWER BONDS	0.00	0.00	0.00	153,337.00	12,083.33	52,886.97	0.00	100,450.03	34.49
TOTAL REVENUES	0.00	0.00	0.00	8,166,472.00	621,501.48	2,587,720.27	0.00	5,578,751.73	31.69
<u>EXPENDITURE SUMMARY</u>									
NON-DEPARTMENTAL	0.00	0.00	0.00	600,000.00	50,000.00	200,000.00	0.00	400,000.00	33.33
WATER	5,622.50	5,032.50	590.00	3,166,261.00	208,807.25	762,213.08	(3,029.37)	2,407,077.29	23.98
SEWER	35,034.20	19,004.20	16,030.00	3,135,624.00	172,614.10	820,381.74	(13,693.08)	2,328,935.34	25.73
SOLID WASTE	0.00	0.00	0.00	1,164,598.00	94,549.08	275,166.36	0.00	889,431.64	23.63
SRF SEWER BONDS	0.00	0.00	0.00	153,337.50	0.00	4,213.41	0.00	149,124.09	2.75
TOTAL EXPENDITURES	40,656.70	24,036.70	16,620.00	8,219,820.50	525,970.43	2,061,974.59	(16,722.45)	6,174,568.36	24.88
REVENUES OVER/(UNDER) EXPENDITURES	(40,656.70)	24,036.70	(16,620.00)	(53,348.50)	95,531.05	525,745.68	16,722.45	(595,816.63)	1,016.84-

Investment Monthly Report

Investments Held at 02/28/2019

Purchase Date	Receipt #	Institution	Description	Restricted	Maturity Date	Principal	Par **	Yield	Market*
06/27/18	802849	CBR	CD	Fund 50	06/29/19	673,823.35	673,823.35	1.7500	673,823.35
08/24/18	108041765	Commerce	CD		08/26/19	2,000,000.00	2,000,000.00	2.3200	2,000,000.00
10/02/18	108041857	Commerce	US TREASURY		09/12/19	2,000,000.00	2,000,000.00	2.5500	2,000,000.00
11/21/18	900320	CBR	CD		11/21/19	2,000,000.00	2,000,000.00	2.7000	2,000,000.00
12/07/18		NASB	CD		12/09/19	2,500,000.00	2,500,000.00	2.8000	2,500,000.00
10/18/12		MOSIP	MOSIP POOLE- GENERAL FUND		NA	2,074,477.66	2,074,477.66	2.4100	2,074,477.66
06/03/16		MOSIP	MOSIP POOLE - GO BOND	GO Bond	NA	993,363.95	993,363.95	2.4100	993,363.95
09/01/16		MOSIP	MOSIP POOLE - GO BOND	GO Bond	NA	1,077,838.15	1,077,838.15	2.4100	1,077,838.15
05/03/18	108041463	Commerce	CD		05/03/19	1,000,000.00	1,000,000.00	2.0000	1,000,000.00

Investment Total

14,319,503.11

14,319,503.11

14,319,503.11

*Market value listed above is the value of the investment at month end

Average Annual Rate of Return: **2.4659**

** Par value listed above is the actual amount if less than one year or the calculated annual earnings showing a one-year duration

Investment by Maturity

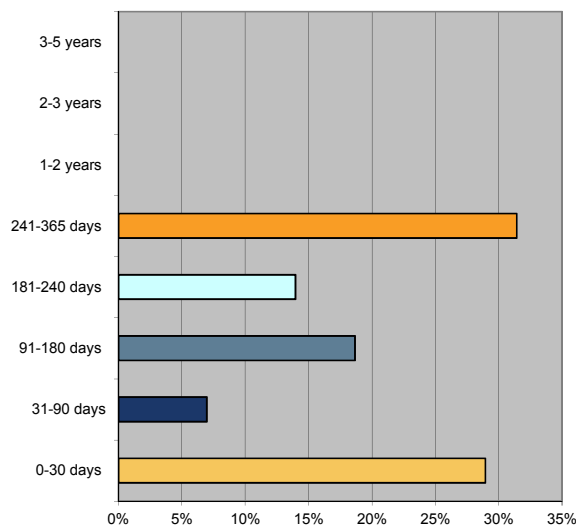

Diversification by Type



Listing of Investments Matured During the Month

Month	Receipt #	Institution	Description	Restricted	Maturity Date	Principal	Par **	Yield	Days Held
-------	-----------	-------------	-------------	------------	---------------	-----------	--------	-------	-----------

Average Rate of Return on Maturities:

February Grant Summary

New Grant Applications	Grantor	Award Amt. Requested / Match Required	Project / Item	Notification Timeline	Awarded / Denied

Current Grant Awards:	Grantor	Award Amt. / Match Required	Eligible Amount Expended to Date	Awards/ Reimbursements Rec'd. to Date	Grant Deadline
Police:					
State & Community Hwy. Safety Grant - DWI (Oct. 2018 - Sept. 2019)	MoDOT (Traffic & Hwy. Safety Division)	\$8,000.00 (no match)	\$789.46	\$0.00	9/30/19
State & Community Hwy. Safety Grant - HMV (Oct. 2018 - Sept. 2019)	MoDOT (Traffic & Hwy. Safety Division)	\$5,500.00 (no match)	\$797.42	\$797.42	9/30/19
Parks:					
Recreational Amenity Cost Sharing Program - Community Assistance Program (CAPS)	MO Dept of Conservation	\$178,000 (75% Contribution by CAPS)	\$0.00	\$0.00	As Project is Complete
Emergency Management:					
Emergency Mgmt. Performance Grant - 2018 (Jan. - Dec. 2018)	FEMA	\$52,878.80 (50% match)	\$50,972.15	\$37,262.94	12/31/18
Community Development:					
Community Development	AARP	\$15,000	\$12,349.52	\$15,000.00	11/05/2018

Past Grant Awards:	Grantor	Award Amount / Match Req'd.	Eligible Amount Expended to Date	Awards/ Reimbursements Rec'd. to Date	Grant Deadline
Bulletproof Vest Partnership program (2016) ¹	U.S. Dept. of Justice	\$5,005.00 (50% match)	\$4,804.55	\$4,804.55	8/31/18

¹ Bulletproof Vest reimbursements have a 2-yr drawdown period

Consent Agenda

THE RAYMORE CITY COUNCIL MET IN REGULAR SESSION MONDAY, MARCH 11, 2019 IN COUNCIL CHAMBERS AT 100 MUNICIPAL CIRCLE, RAYMORE, MISSOURI. MEMBERS PRESENT: MAYOR TURNBOW, COUNCILMEMBERS ABDELGAWAD, BARBER, BERENDZEN, BURKE, CIRCO, HOLMAN, AND TOWNSEND, CITY MANAGER JIM FEUERBORN, AND CITY STAFF MEMBERS.

- 1. Call To Order.** Mayor Turnbow called the regular meeting to order at 7:00 p.m.
- 2. Roll Call.** Recording Secretary Margie Sullivan called roll; quorum present to conduct business. Councilmember Kellogg and City Attorney Jonathan Zerr absent. Zach Enterline attended for Mr. Zerr.

3. Pledge of Allegiance.

4. Presentations/Awards.

Terri McCourt, Dana F. Cole & Co., presented the City's audit report for the FY 2018 financial statements.

5. Personal Appearances.

6. Staff Reports.

Development Services Director Jim Cadoret provided a review of the staff report included in the Council packet, upcoming items of the Board of Adjustment and Planning Commission, and provided updates on upcoming commercial projects.

Parks & Recreation Director Nathan Musteen provided an update of upcoming events and projects.

Chief of Police Jan Zimmerman announced an animal vaccination clinic will be held on April 27.

Emergency Management Director Ryan Murdock discussed severe weather, the upcoming severe storm spotter training class, and urged citizens to sign up for the severe weather notifications.

City Manager Jim Feuerborn announced agenda items for the March 18, 2019 Council work session.

7. Committee Reports.

8. Consent Agenda.

A. City Council Minutes, February 25, 2019

MOTION: By Councilmember Barber, second by Councilmember Holman to approve the Consent Agenda as presented.

DISCUSSION: None

VOTE:	Councilmember Abdelgawad	Aye
	Councilmember Barber	Aye
	Councilmember Berendzen	Aye
	Councilmember Burke, III	Aye
	Councilmember Circo	Aye
	Councilmember Holman	Aye
	Councilmember Kellogg	Absent
	Councilmember Townsend	Aye

9. Unfinished Business. Second Readings.

A. Award of Contract - RAC Projector/Screen

BILL 3438: "AN ORDINANCE OF THE CITY OF RAYMORE, MISSOURI AUTHORIZING THE CITY MANAGER TO ENTER INTO AN AGREEMENT WITH KANSAS CITY AUDIO VISUAL FOR THE PURCHASE AND INSTALLATION OF A PROJECTOR AND SCREEN FOR THE RAYMORE ACTIVITY CENTER IN THE AMOUNT OF \$11,133.95 AND AUTHORIZING THE CITY MANAGER TO APPROVE CHANGE ORDERS WITHIN ESTABLISHED BUDGET CONSTRAINTS."

Recording Secretary Margie Sullivan conducted the second reading of Bill 3438 by title only.

MOTION: By Councilmember Barber, second by Councilmember Holman to approve the second reading of Bill 3438 by title only.

DISCUSSION: None

VOTE:	Councilmember Abdelgawad	Aye
	Councilmember Barber	Aye
	Councilmember Berendzen	Aye
	Councilmember Burke, III	Aye
	Councilmember Circo	Aye
	Councilmember Holman	Aye
	Councilmember Kellogg	Absent
	Councilmember Townsend	Aye

Mayor Turnbow announced the motion carried and declared Bill 3438 as **Raymore City Ordinance 2019-026.**

10. New Business. First Readings.

A. Regulation of Open Burning

BILL 3439: "AN ORDINANCE OF THE CITY OF RAYMORE, MISSOURI ESTABLISHING CHAPTER 285: REGULATION OF OPEN BURNING, OF THE CITY OF RAYMORE, CODE OF ORDINANCES."

Recording Secretary Margie Sullivan conducted the first reading of Bill 3439 by title only.

Development Services Director Jim Cadoret provided a review of the staff report included in the Council packet. Due to recent changes made to the Missouri open burning regulation that eliminated many of the state requirements on open burning, staff is proposing to add Chapter 285: Regulations for Open Burning to the City Code of Ordinances. The South Metropolitan Fire Protection District urged communities in its jurisdiction to adopt local regulations that mirror the previous State regulations. If approved, the effective date of the regulations will be April 1, 2019.

Staff answered general questions of clarification from Council.

MOTION: By Councilmember Barber, second by Councilmember Holman to approve the first reading of Bill 3439 by title only.

DISCUSSION: None

VOTE:	Councilmember Abdelgawad	Aye
	Councilmember Barber	Aye
	Councilmember Berendzen	Aye
	Councilmember Burke, III	Aye
	Councilmember Circo	Aye
	Councilmember Holman	Aye
	Councilmember Kellogg	Absent
	Councilmember Townsend	Aye

B. Nullify Current Intent to Annex Area

RESOLUTION 19-14: "A RESOLUTION OF THE CITY OF RAYMORE, MISSOURI NULLIFYING RESOLUTION NO. 06-04: 'A RESOLUTION RESPECTING THE ANNEXATION OF UNINCORPORATED TERRITORY, AND THE EXTENSION OF THE CORPORATE LIMITS, OF THE CITY OF RAYMORE, PURSUANT TO SECTION 71.015 OF THE REVISED STATUTES OF MISSOURI, AS AMENDED.'"

Recording Secretary Margie Sullivan conducted the reading of Resolution 19-14 by title only.

Special Council Corey Henry provided a review of the staff report included in the Council packet. The current Intent to Annex was established by Resolution 06-04 on January 9, 2006. With the current discussion on annexation of areas east of the current City boundary, it is appropriate to nullify the existing Intent to Annex Area.

MOTION: By Councilmember Barber, second by Councilmember Holman to approve the reading of Resolution 19-14 by title only.

DISCUSSION: None

VOTE:	Councilmember Abdelgawad	Aye
	Councilmember Barber	Aye
	Councilmember Berendzen	Aye
	Councilmember Burke, III	Aye
	Councilmember Circo	Aye
	Councilmember Holman	Aye
	Councilmember Kellogg	Absent
	Councilmember Townsend	Aye

C. Nullify Current Annexation Plan of Intent

BILL 3440: "AN ORDINANCE OF THE CITY OF RAYMORE, MISSOURI REPEALING ORDINANCE NO. 26055: 'AN ORDINANCE AMENDING, AND RESTATING BILL NO. 1943, PROVIDING FOR THE ANNEXATION OF, UNINCORPORATED TERRITORY, AND THE EXTENSION OF, THE CORPORATE LIMITS OF THE CITY OF RAYMORE, ALL PURSUANT TO SECTION 71.015 OF THE REVISED STATUTES OF MISSOURI, AS AMENDED; REPEALING ORDINANCE NO. 26056: 'AN ORDINANCE AMENDING AND RESTATING, BILL NO. 1944 PROVIDING FOR, THE ANNEXATION OF UNINCORPORATED TERRITORY, AND THE EXTENSION OF THE CORPORATE LIMITS OF THE CITY OF RAYMORE, ALL PURSUANT TO SECTION 71.015 OF THE REVISED STATUTES OF MISSOURI, AS AMENDED; AND REPEALING ORDINANCE NO. 26057: 'AN ORDINANCE AMENDING AND, RESTATING BILL NO. 1945, PROVIDING FOR THE ANNEXATION OF, UNINCORPORATED TERRITORY, AND THE EXTENSION OF THE CORPORATE LIMITS OF THE CITY OF RAYMORE, ALL PURSUANT TO SECTION 71.015 OF THE REVISED STATUTES OF MISSOURI, AS AMENDED.'"

Recording Secretary Margie Sullivan conducted the first reading of Bill 3440 by title only.

Special Council Corey Henry provided a review of the staff report included in the Council packet. In 2006 there was an effort to annex three distinct areas situated east of the current City boundary. A plan of intent was prepared for each of the three proposed annexation areas. With the current discussion on annexation of areas east of the current City boundary it is appropriate to nullify the three Plan of Intent documents.

MOTION: By Councilmember Barber, second by Councilmember Holman to approve the first reading of Bill 3440 by title only.

DISCUSSION: None

VOTE:	Councilmember Abdelgawad	Aye
	Councilmember Barber	Aye
	Councilmember Berendzen	Aye
	Councilmember Burke, III	Aye
	Councilmember Circo	Aye
	Councilmember Holman	Aye
	Councilmember Kellogg	Absent
	Councilmember Townsend	Aye

D. Establish Intent to Annex Area

RESOLUTION 19-15: "A RESOLUTION OF THE CITY OF RAYMORE, MISSOURI DESCRIBING THE INTENDED FUTURE CITY BOUNDARIES, THROUGH ANNEXATION."

Recording Secretary Margie Sullivan conducted the reading of Resolution 19-15 by title only.

Special Council Corey Henry provided a review of the staff report included in the Council packet. With the current discussion on annexation of areas east of the current City boundary, it is appropriate to establish a new Intent to Annex Area description and map.

City Manager Jim Feuerborn stated that this can be shared with Lee's Summit and Lake Winnebago as a precursor to creating a Memorandum of Understanding with the communities regarding annexation and also provides a legal remedy should the entities decide to encroach into those areas.

MOTION: By Councilmember Barber, second by Councilmember Holman to approve the reading of Resolution 19-15 by title only.

DISCUSSION: None

VOTE:	Councilmember Abdelgawad	Aye
	Councilmember Barber	Aye
	Councilmember Berendzen	Aye
	Councilmember Burke, III	Aye
	Councilmember Circo	Aye
	Councilmember Holman	Aye
	Councilmember Kellogg	Absent
	Councilmember Townsend	Aye

E. Award of Contract - Municipal Circle Street Light Installation

BILL 3442: "AN ORDINANCE OF THE CITY OF RAYMORE, MISSOURI AUTHORIZING THE MAYOR AND CITY MANAGER, TO ENTER INTO A CONTRACT WITH BLACK & MCDONALD FOR THE MUNICIPAL CIRCLE STREET LIGHT INSTALLATION PROJECT IN THE AMOUNT OF \$29,740.44 AND AUTHORIZING THE CITY MANAGER, TO APPROVE CHANGE ORDERS WITHIN ESTABLISHED BUDGET CONSTRAINTS."

Recording Secretary Margie Sullivan conducted the first reading of Bill 3442 by title only.

Public Works Director Mike Krass provided a review of the staff report included in the Council packet. This project calls for the replacement of decorative lighting along Skyline and Broadmoor Drive within the Municipal Complex. Staff is recommending award of this contract to Black & McDonald.

MOTION: By Councilmember Barber, second by Councilmember Holman to approve the first reading of Bill 3442 by title only.

DISCUSSION: None

VOTE:	Councilmember Abdelgawad	Aye
	Councilmember Barber	Aye
	Councilmember Berendzen	Aye
	Councilmember Burke, III	Aye
	Councilmember Circo	Aye
	Councilmember Holman	Aye
	Councilmember Kellogg	Absent
	Councilmember Townsend	Aye

F. Multi-Year Curb Replacement Program

RESOLUTION 19-16: "A RESOLUTION OF THE CITY OF RAYMORE, MISSOURI ADOPTING A MULTI-YEAR CURB REPLACEMENT PROGRAM."

Recording Secretary Margie Sullivan conducted the reading of Resolution 19-16 by title only.

Public Works Director Mike Krass provided a review of the staff report included in the Council packet. The City is engaged in a multi-year curb replacement program. Resolution 19-16 approves the 2019 Curb Replacement Program with suggested amendment.

MOTION: By Councilmember Barber, second by Councilmember Holman to approve the reading of Resolution 19-16 by title only.

DISCUSSION: Councilmember Abdelgawad expressed gratitude that the plan includes some curbs in Morningview.

VOTE:

Councilmember Abdelgawad	Aye
Councilmember Barber	Aye
Councilmember Berendzen	Aye
Councilmember Burke, III	Aye
Councilmember Circo	Aye
Councilmember Holman	Aye
Councilmember Kellogg	Absent
Councilmember Townsend	Aye

11. Public Comments.

12. Mayor/Council Communication.

Mayor Turnbow and Councilmembers noted the new art in the Council Chambers, recognized staff and Mr. Feuerborn on the GFOA Distinguished Budget award for the 14th consecutive year.

Councilmember Barber expressed appreciation for the annual curb program.

Councilmember Burke reminded residents that yard waste pick up has started for the year.

Councilmember Townsend recognized Economic Development Director Matt Tapp for his work on development of the City behind the scenes.

Mayor Turnbow congratulated Benton House and Brightside Children’s Center on their expansions.

13. Adjournment.

MOTION: By Councilmember Barber, second by Councilmember Holman to adjourn.

VOTE:

Councilmember Abdelgawad	Aye
Councilmember Barber	Aye
Councilmember Berendzen	Aye
Councilmember Burke, III	Aye
Councilmember Circo	Aye
Councilmember Holman	Aye
Councilmember Kellogg	Absent
Councilmember Townsend	Aye

The regular meeting of the Raymore Council adjourned at 7:43 p.m.

Respectfully submitted,

Margie Sullivan
Recording Secretary**

***These minutes transcribed by Erica Hill*

Unfinished Business



CITY OF RAYMORE
AGENDA ITEM INFORMATION FORM

DATE: March 11, 2019

SUBMITTED BY: Jim Cadoret

DEPARTMENT: Development Services

<input checked="" type="checkbox"/> Ordinance	<input type="checkbox"/> Resolution	<input type="checkbox"/> Presentation	<input type="checkbox"/> Public Hearing
<input type="checkbox"/> Agreement	<input type="checkbox"/> Discussion	<input type="checkbox"/> Other	

TITLE / ISSUE / REQUEST

Bill 3439: Establishing Chapter 285: Regulation on Open Burning

STRATEGIC PLAN GOAL/STRATEGY

2.1.4: Expand strategies that enforce building safety and code requirements

FINANCIAL IMPACT

Award To:
Amount of Request/Contract:
Amount Budgeted:
Funding Source/Account#:

PROJECT TIMELINE

Estimated Start Date	Estimated End Date
----------------------	--------------------

STAFF RECOMMENDATION

Approval

OTHER BOARDS & COMMISSIONS ASSIGNED

Name of Board or Commission:
Date:
Action/Vote:

LIST OF REFERENCE DOCUMENTS ATTACHED

REVIEWED BY:

Jim Feuerborn

BACKGROUND / JUSTIFICATION

The Missouri Open Burning regulation has been amended effective March 30, 2019, to remove state-level restrictions on individuals burning their own vegetative waste. The new state regulations allow a municipality to adopt its own open burning regulations.

The South Metropolitan Fire Protection District is urging communities in its jurisdiction to adopt local regulations that mirror the previous State regulations. The Fire District also intends to adopt open burning regulations to restrict open burning outside City Limits.

Bill 3439 proposes to establish Chapter 285: Regulation on Open Burning in the City Code of Ordinances. In general, the proposed ordinance will ban the open burning of household wastes, construction or demolition waste, and other similar materials. The ordinance will allow for open burning of vegetative waste and untreated wood provided certain conditions are met, including the requirement that all open burning occur no closer than 200 yards from the nearest structure. Effective date of the regulations will be April 1, 2019.

BILL 3439

ORDINANCE

"AN ORDINANCE OF THE CITY OF RAYMORE, MISSOURI, ESTABLISHING CHAPTER 285: REGULATION OF OPEN BURNING IN THE CITY OF RAYMORE CODE OF ORDINANCES."

WHEREAS, the Missouri Department of Natural Resources recently amended the Code of State Regulations on open burning and discontinued issuing residential burn permits and conducting enforcement action; and

WHEREAS, the City can further limit or restrict open burning beyond State regulations by adopting a local open burning ordinance; and

WHEREAS, it is in the interest of the public health, safety and welfare for the City to regulate open burning within the corporate limits of the City.

NOW, THEREFORE, BE IT ORDAINED BY THE CITY COUNCIL OF THE CITY OF RAYMORE, MISSOURI, AS FOLLOWS:

Section 1. Chapter 285: Regulation on Open Burning, is hereby established in the City of Raymore Code of Ordinances as follows:

CHAPTER 285: REGULATION ON OPEN BURNING

SECTION 285.010: APPLICABILITY

The regulations contained in this chapter apply to all property located within the corporate limits of the City of Raymore.

SECTION 285.020: DEFINITIONS

Air Curtain Incinerator: A device that operates by forcefully projecting a curtain of air across an open chamber or open pit in which combustion occurs.

Household Waste: Garbage, trash, and other discarded materials that are generated from residential activities in a household.

Open Burning: The burning of materials where the products of combustion are emitted into the open air without passing through a chimney or stack.

Salvage Operation: Any business, trade, industry, or other activity conducted in whole or in part for the purpose of salvaging or reclaiming any product or material.

Trade Waste: Waste materials from any business, institution or industry.

Untreated Wood: Wood that has not been chemically preserved, painted, stained, or composited. Untreated wood does not include plywood, particleboard, chipboard, and wood with other than minimal quantities of paint, coating, or finish.

Vegetative Waste: Tree trunks, tree limbs, tree trimmings, vegetation, and yard waste.

SECTION 285.030: GENERAL PROVISIONS

- A. Open burning that causes or constitutes a public health hazard, a hazard to vehicular or air traffic, is composed of material listed in Section 285.040, or violates any other rule or statute of the State of Missouri, is not allowed unless specified otherwise.
- B. The existence of a public health hazard is to be determined by the Chief of the South Metropolitan Fire Protection District, or their designee.
- C. All open burning shall be done in compliance with the Missouri Code of State Regulations.

SECTION 285.040: PROHIBITION OF MATERIALS TO BE BURNED

The following materials must not be disposed of by open burning:

- 1. Petroleum-based materials, including but not limited to tires, asphalt roofing material, carpet and used oils;
- 2. Asbestos containing materials;
- 3. Trade waste, except untreated wood;
- 4. Construction or demolition waste, except untreated wood;
- 5. Salvage operation waste;
- 6. Household waste; or
- 7. Durable goods.

SECTION 285.050: OPEN BURNING OF VEGETATIVE WASTE ALLOWED

Open burning of vegetative waste and untreated wood is allowed under the following conditions:

- 1. Only vegetative waste and untreated wood may be open burned;
- 2. Burning is to take place only between sunrise and sunset;
- 3. Burning is to occur at least two hundred (200) yards from the nearest structure not owned by the party conducting the burning, unless an air-incinerator is used and:
 - a. waivers are obtained from the owner or occupant of the structure; and
 - b. approval is granted by the South Metropolitan Fire Protection District.

4. Burning is to be supervised at all times; and
5. A permit shall be obtained from the South Metropolitan Fire Protection District prior to initiation of any open burning.

SECTION 285.060: LAND CLEARING

Open burning of vegetative waste from land clearing operations is allowed under the following conditions:

1. Burning is to occur at least two hundred (200) yards from the nearest occupied structure;
2. Burning of more than eighty (80) cubic yards of vegetative waste or untreated wood must use an Air-Curtain Incinerator;
3. Air-Curtain Incinerator operations must take place at least fifty (50) yards from any occupied structure; and
4. A permit shall be obtained from the South Metropolitan Fire Protection District prior to initiation of any open burning.

SECTION 285.070: FIRE PITS AND PATIO FIREPLACES

Open burning in fire pits and patio fireplaces are allowed on all properties at any time under the following conditions:

1. Only small twigs, branches and untreated wood shall be burned;
2. No leaves shall be burned;
3. No household waste, construction or demolition waste, or any other material prohibited under Section 285.040 shall be burned; and
4. Owner must maintain control over any open burning.

Section 2. Effective Date. The effective date of approval of this Ordinance shall be April 1, 2019, subject to the Mayor's signature and attestation by the City Clerk.

Section 3. Severability. If any section, subsection, sentence, clause, phrase, or portion of this Ordinance is for any reason held invalid or unconstitutional by any court of competent jurisdiction, such portion shall be deemed a separate, distinct, and independent provision, and such holding shall not affect the validity of the remaining portions thereof.

DULY READ THE FIRST TIME THIS 11TH DAY OF MARCH, 2019.

BE IT REMEMBERED THAT THE ABOVE ORDINANCE WAS APPROVED AND ADOPTED THIS 25TH DAY OF MARCH, 2019, BY THE FOLLOWING VOTE:

Councilmember Abdelgawad
Councilmember Barber
Councilmember Berendzen
Councilmember Burke III
Councilmember Circo
Councilmember Holman
Councilmember Kellogg
Councilmember Townsend

ATTEST:

APPROVE:

Jean Woerner, City Clerk

Kristofer P. Turnbow, Mayor

Date of Signature



CITY OF RAYMORE
AGENDA ITEM INFORMATION FORM

DATE: March 11, 2019

SUBMITTED BY: Jim Cadoret

DEPARTMENT: Development Services

<input checked="" type="checkbox"/> Ordinance	<input type="checkbox"/> Resolution	<input type="checkbox"/> Presentation	<input type="checkbox"/> Public Hearing
<input type="checkbox"/> Agreement	<input type="checkbox"/> Discussion	<input type="checkbox"/> Other	

TITLE / ISSUE / REQUEST

Bill 3440: Nullify 2006 Annexation Plan of Intent

STRATEGIC PLAN GOAL/STRATEGY

3.3: Cultivate a climate for prosperous growth and development

FINANCIAL IMPACT

Award To:
Amount of Request/Contract:
Amount Budgeted:
Funding Source/Account#:

PROJECT TIMELINE

Estimated Start Date	Estimated End Date
----------------------	--------------------

STAFF RECOMMENDATION

Approval

OTHER BOARDS & COMMISSIONS ASSIGNED

Name of Board or Commission:
Date:
Action/Vote:

LIST OF REFERENCE DOCUMENTS ATTACHED

2006 Annexation Plan of Intent

REVIEWED BY:

Jim Feuerborn

BACKGROUND / JUSTIFICATION

In 2006 there was an effort to annex three distinct areas situated east of the current City boundary. The City approved a plan of intent that covered each of the three proposed annexation areas. With the current discussion on annexation of areas east of the current City boundary, it is appropriate to nullify the Plan of Intent to Annex documents.

BILL 3440

ORDINANCE

"AN ORDINANCE OF THE CITY OF RAYMORE, MISSOURI, REPEALING ORDINANCE NO. 26055 'AN ORDINANCE AMENDING AND RESTATING BILL NO. 1943 PROVIDING FOR THE ANNEXATION OF UNINCORPORATED TERRITORY AND THE EXTENSION OF THE CORPORATE LIMITS OF THE CITY OF RAYMORE ALL PURSUANT TO SECTION 71.015 OF THE REVISED STATUTES OF MISSOURI, AS AMENDED; REPEALING ORDINANCE NO. 26056 'AN ORDINANCE AMENDING AND RESTATING BILL NO. 1944 PROVIDING FOR THE ANNEXATION OF UNINCORPORATED TERRITORY AND THE EXTENSION OF THE CORPORATE LIMITS OF THE CITY OF RAYMORE, ALL PURSUANT TO SECTION 71.015 OF THE REVISED STATUTES OF MISSOURI, AS AMENDED; AND REPEALING ORDINANCE NO. 26057 'AN ORDINANCE AMENDING AND RESTATING BILL NO. 1945 PROVIDING FOR THE ANNEXATION OF UNINCORPORATED TERRITORY AND THE EXTENSION OF THE CORPORATE LIMITS OF THE CITY OF RAYMORE, ALL PURSUANT TO SECTION 71.015 OF THE REVISED STATUTES OF MISSOURI, AS AMENDED.'"

WHEREAS, the City of Raymore, Missouri (the "City") previously attempted to annex areas of unincorporated territory in Cass County; and,

WHEREAS, the annexation attempt complied with state law requirements for annexation, including passing Ordinances with the City's plan of intent to provide services to the areas it was seeking to annex; and,

WHEREAS, the City desires to repeal the Ordinances the City Council passed for the annexation attempt, as well as the previous plans of intent in their entirety.

NOW, THEREFORE, BE IT ORDAINED BY THE CITY COUNCIL OF THE CITY OF RAYMORE, MISSOURI, AS FOLLOWS:

Section 1. Ordinance No. 26055 and the Plan of Intent for the area more particularly described as attached hereto as Exhibit A, is repealed in its entirety.

Section 2. Ordinance No. 26056 and the Plan of Intent for the area more particularly described as attached hereto as Exhibit A, is repealed in its entirety.

Section 3. Ordinance No. 26057 and the Plan of Intent for the area more particularly described as attached hereto as Exhibit A, is repealed in its entirety.

Section 4. Effective Date. The effective date of approval of this Ordinance shall be coincidental with the Mayor's signature and attestation by the City Clerk.

Section 5. Severability. If any section, subsection, sentence, clause, phrase, or portion of this Ordinance is for any reason held invalid or unconstitutional by any court of competent jurisdiction, such portion shall be deemed a separate, distinct, and independent provision, and such holding shall not affect the validity of the remaining portions thereof.

DULY READ THE FIRST TIME THIS 11th DAY OF MARCH, 2019.

BE IT REMEMBERED THAT THE ABOVE ORDINANCE WAS APPROVED AND ADOPTED THIS 25th DAY OF MARCH, 2019, BY THE FOLLOWING VOTE:

Councilmember Abdelgawad
Councilmember Barber
Councilmember Berendzen
Councilmember Burke III
Councilmember Circo
Councilmember Holman
Councilmember Kellogg
Councilmember Townsend

ATTEST:

APPROVE:

Jean Woerner, City Clerk

Kristofer P. Turnbow, Mayor

Date of Signature

**Building Relationships.
Building Community.**





BUILDING RELATIONSHIPS • BUILDING COMMUNITY

CITY OF RAYMORE PLAN OF INTENT

PREPARED BY OLSSON ASSOCIATES



TABLE OF CONTENTS

INTRODUCTION.....PAGE 4

EXECUTIVE SUMMARY.....PAGE 7

CHARACTERIZATION OF ANNEXATION AREAS.....PAGE 10

MAJOR CITY SERVICES.....PAGE 15

ASSESSMENT AND TAXATION.....PAGE 26

REASONABLENESS AND NECESSITY OF ANNEXATION.....PAGE 30

RECOMMENDATION.....PAGE 32

EFFECTIVE DATE OF ANNEXATION.....PAGE 33



ATTACHMENTS

- ▣ CITY OF RAYMORE STRATEGIC GOALS - ATTACHMENT A
- ▣ GROWTH MANAGEMENT PLAN: ANNEXATION ADDENDUM - ATTACHMENT B
- ▣ CITY OF RAYMORE BILL 1969: ANNEXATION AREA 1 - ATTACHMENT C
- ▣ CITY OF RAYMORE BILL 1970: ANNEXATION AREA 2 - ATTACHMENT D
- ▣ CITY OF RAYMORE BILL 1971: ANNEXATION AREA 3 - ATTACHMENT E
- ▣ MAP OF THREE ANNEXATION AREAS - ATTACHMENT - F
- ▣ MAP OF AREA 1 - ATTACHMENT G
- ▣ MAP OF AREA 2 - ATTACHMENT H
- ▣ MAP OF AREA 3 - ATTACHMENT I
- ▣ COSTS TO PROVIDE MAJOR SERVICES - ATTACHMENT J
- ▣ EXISTING LAND-USE: AREA 1 - ATTACHMENT K
- ▣ EXISTING LAND-USE: AREA 2 - ATTACHMENT L
- ▣ EXISTING LAND-USE: AREA 3 - ATTACHMENT M
- ▣ SCHOOL DISTRICT MAP - ATTACHMENT N
- ▣ RECOMMENDED SEWER SYSTEM IMPROVEMENTS - ATTACHMENT O
- ▣ EMERGENCY SIREN MAP - ATTACHMENT P



INTRODUCTION

The City of Raymore's Strategic Plan (**See Attachment A**) outlines as one of its goals a desire to Develop an annexation plan and relate it to the Growth Management Plan and the Capital Improvement Plan.

According to the Growth Management Plan (**See Attachment B**), "Raymore has transformed from a community happy to be growing to one that demands quality in all growth. The changing perspective also raises questions about where to grow and how to accommodate growth in a fiscally efficient manner." The plan goes on to say that annexation should be prioritized based on the availability of infrastructure and economic development potential and should be evaluated using the following criteria:

- Will annexation substantially increase Raymore's tax base or revenue producing ability?
- Is the annexation necessary to control short-term development in an area which is important to Raymore's long-term growth plans?
- Are the annexation plans of adjacent communities threatening the long-term growth potential of Raymore?
- Does the annexation add an area with short-term development potential which can be easily serviced by existing infrastructure?
- Is land in Raymore's long-term growth area being inappropriately developed under county development regulations?
- Will the annexation overburden City resources?

On January 9, 2006, the Raymore City Council introduced three ordinances to annex property currently in unincorporated Cass County, setting July 17, 2006 as the date for the required public hearing. Following additional consideration and contemplation of the importance of this issue to the Raymore community, the City Council amended those ordinances, setting May 15, 2006 as the public hearing date. **See Attachment C, D, and E for copies of the ordinances and Attachment F for a map of all three areas.**

Introduction of these ordinances are the first steps in a very deliberate process necessary for a city to undertake what is considered an involuntary annexation. Missouri State Statute 71.015 requires the following steps.

- 1) **Ordinance:** An ordinance must be introduced that outlines that the area meets the requirement that it is 15 percent contiguous; is reasonable and necessary to the development of the municipality; development of a plan of intent; conducting a public hearing prior to adoption of the ordinance; and the effective date of the annexation.
- 2) **Public Hearing:** A public hearing must be conducted prior to the adoption of the aforementioned ordinance. Property owners must be notified by certified mail not less than 30 nor more than 60 days prior to the hearing. The public hearing must also be published once per week for three consecutive weeks and in one publication not more than 20 or less than 10 days prior to the public hearing.
- 3) **Plan of Intent:** At the public hearing, a plan of intent must be presented as more fully described below.
- 4) **Ordinance Adoption:** The ordinance can be adopted following the public hearing.
- 5) **Elections:** Elections must be conducted in the existing municipality and in the annexation area.
- 6) **Declaratory Judgment:** A petition must be filed in circuit court for declaratory judgment finding that the annexation area meets the fifteen percent contiguous requirement; that the annexation is reasonable and necessary for the proper development of the municipality; and that the annexing municipality can furnish the normal municipal services to the annexation area within three years of the effective date of annexation.



The City has undertaken a study regarding the costs and benefits of such annexation to both the current residents of Raymore as well as those who would become residents. Per state statute, that analysis is provided in this Plan of Intent.

Included in this plan is:

1) ***A Review of the Proposed Annexation Area***

This section considers the following characteristics of the three areas under consideration.

- ☐ Population
- ☐ Topography
- ☐ Existing Land-use
- ☐ Zoning Development Patterns
- ☐ Transportation
- ☐ Utilities
- ☐ Health Services
- ☐ Parks and Recreation
- ☐ Fire Protection
- ☐ Law Enforcement
- ☐ Schools

This review is necessary so that the City of Raymore has a grounded understanding of existing conditions within the proposed annexation areas.

2) ***Major Services Provided by the City of Raymore***

This section outlines the services currently provided by the City of Raymore; policies regarding that service provision; how those services would be provided in the newly annexed areas; the time frame in which the services will be provided; and the estimated operating and capital costs of services.

3) ***Assessment and Taxation***

Annexation of any area potentially results in a change of taxation to the residents within the area as well as a change in revenue to the City. This plan provides an analysis of both and informs prospective residents how their taxes will change should they be annexed by the City of Raymore.

4) ***Zoning***

According to state law, a city cannot simply declare that newly annexed property is zoned to a particular designation. Any new zoning must be pursuant to the notice and public hearing requirements included in the Zoning Enabling Act.

The City has gone on record in a letter to residents that “The City is in the process of changing its zoning code so that property annexed into the City will not be required to change its zoning. The Council understands that many land owners do not have an interest in developing their land at this time.” What this means is that the City intends to revise its zoning code to provide for zoning designations that will provide a level of regulation very similar to that currently being experienced in the unincorporated areas being considered for annexation. New zoning designations are being created for rural land-uses of 1-3 acres and more than 3 acres. Once these designations are in place, the City



would initiate efforts to convert newly annexed areas from County zoning to City zoning, keeping the existing land-use the same.

This report outlines how the City would address land-use, zoning issues, and code enforcement.

5) ***Effective Date and Recommendation***

As a result of the analysis of the information contained within this Plan of Intent, a recommendation regarding the annexation and appropriate effective date is included.

Considering the information in the Plan of Intent and the City of Raymore's stated goals for annexation as outlined in its Growth Management Plan, a recommendation is provided regarding the annexation.



EXECUTIVE SUMMARY

Each of the proposed annexation areas is predominantly rural in character. There are some areas that are more urban in nature, but they are faced with sub-standard infrastructure, minimal law enforcement, and few codes to protect property values.

As the City proceeds with annexation, it must realize the challenges such growth will bring along with significant opportunity. As well, the City must address the very differing interests of those residents in the areas under consideration and those of current Raymore residents.

Benefits to the annexed area will include:

- A safer environment because of increased police presence and responsiveness and emergency preparedness programs.
- Orderly development as a result of the City's progressive land-use and zoning policies.
- Enhanced health and safety due to Raymore's code that respects individual properties and preserves quality neighborhoods.
- Continued full access to Raymore's parks and recreation programs and amenities.
- Full participation in City of Raymore issues that affect the annexed areas because of their proximity to the City.

Benefits to current Raymore residents are broader in scope, not immediate and require a vision for the future. They include:

- Greater possibility for economic development and associated tax revenues to support City services.
- An ability to influence development around them.
- Securing the land for Raymore's future success rather than other communities' endeavors.
- A window of three to six years to plan and prepare for the increased growth and demand for services.

Annexing these three areas does not come without challenges. However, with careful policy development, planning and execution, these can proactively be addressed.

Sanitary Sewers: Sanitary sewers are necessary for development, yet they are costly to construct. According to the City's current policy, new development is responsible for necessary sanitary sewers. Such would be the case in the newly annexed area.

Roadway Maintenance: The roadways in the annexation areas are not constructed to City standards. Maintenance of the roadways and snow removal will require additional personnel and equipment. Improvement of these roadways will be costly.

Police Protection: While not densely populated, the annexation areas under consideration are significant in square mileage. This affects primarily the police department's response time. To address that issue, additional personnel and equipment will have to be secured.

Code Enforcement: The City of Raymore's codes are designed to enhance every citizen's quality of life. There are areas within unincorporated Cass County that will eventually be required to abide by those codes. Education, assistance and time will be provided for these new citizens and property owners to comply with new codes.

Financial Considerations: The City will receive additional property tax, franchise fees and motor vehicle

CITY OF RAYMORE
PLAN OF INTENT



and gas tax revenue, should the annexation become a reality. More information is provided below. However, in the near term, these revenues will not fully fund the service delivery necessitated by the annexation. **See Attachment J for costs to provide major services.**

Should all three areas be annexed, it is anticipated that \$407,075 in increased revenues will be generated.

Real Property Taxes:	\$176,989
Personal Property Taxes:	\$ 94,665
Franchise Fees:	\$ 74,547
Gas and Motor Vehicle Taxes:	\$ 60,874

Real and personal property tax revenues will be allocated to the appropriate fund according to the corresponding tax levy and all franchise and gas and motor vehicle taxes deposited to the general operating fund.

General Operating Fund:	\$232,021
Debt Retirement:	\$149,048
Parks Fund:	\$ 26,006

In comparison, \$335,000 in annual on-going costs and \$135,000 in initial capital expenditures are estimated. These costs include an additional three street maintenance workers, two police officers, a code enforcement officer, street maintenance supplies, and contributions to the vehicle replacement fund. Capital expenditures include a revision to the sanitary sewer master plan, a police car, a street maintenance truck, and two emergency warning sirens.

Should only Area No. 1 be annexed, \$65,318 of the \$115,480 in new revenues is available to finance \$210,200 in annual ongoing costs and \$99,000 in initial capital costs. \$42,710 would be available for debt services, and \$ 7,452 is available for parks expenditures.

Should only Area No. 2 be annexed, \$98,262 of the \$174,985 in new revenues is available to finance \$212,700 in annual on-going costs and \$99,000 in initial capital costs. \$65,325 is available for debt service; \$11,398 is available for parks expenditures.

Should only Area No. 3 be annexed, \$68,441 of the \$116,610 in new revenue generated would be available for the \$214,100 in annual ongoing costs and \$99,000 in initial capital costs. \$41,013 would be available for debt service and \$7,156 would be available for parks funds.

Operating costs for each of the individual areas assume one street maintenance worker, two police officers, a code enforcement officer and contributions to the vehicle replacement fund regardless of what area or combinations thereof are annexed. Differing street maintenance material costs account for the small variation. Capital costs include the sanitary sewer study revision, a police car and a street maintenance truck.

The chart on the following page summarizes the revenue and expenditure information.

**CITY OF RAYMORE
 PLAN OF INTENT**



	AREA 1	AREA 2	AREA 3	ALL AREAS
Single Family Households	186	268	206	660
Population	398	614	445	1,457
Comparison of Combined Revenues to Expenditures				
Taxes				
Real Property	\$51,027	\$78,144	\$47,818	\$176,989
Personal Property	\$26,816	\$40,917	\$26,932	\$94,665
	\$77,843	\$119,061	\$74,750	\$271,654
Franchise Fees				
Electric	\$11,626	\$17,935	\$12,998	\$60,060
Telephone	\$4,083	\$5,883	\$4,522	\$14,487
	\$21,009	\$30,271	\$23,268	\$74,547
Intergovernmental				
Gasoline Tax	\$11,626	\$17,935	\$12,998	\$42,559
State Vehicle Sales Tax & Fees	\$5,003	\$7,718	\$5,594	\$18,315
	\$16,628	\$25,653	\$18,592	\$60,874
	\$115,480	\$174,985	\$116,610	\$407,075
Expenditures				
Operating	\$210,200	\$212,700	\$214,100	\$335,000
Net Effect (on-going)	(\$94,720)	(\$37,715)	(\$97,490)	\$72,075
Capital	\$99,000	\$99,000	\$99,000	\$135,000
Total Net Effect (first year)	(\$193,720)	(\$136,715)	(\$196,490)	(\$62,925)
Fiscal Analysis By Fund				
General Fund				
Revenue	\$65,318	\$98,262	\$68,441	\$232,021
Operating Expenditures	\$210,200	\$212,700	\$214,100	\$335,000
Net Effect (on-going)	(\$144,882)	(\$114,438)	(\$145,659)	(\$102,979)
Capital Expenditures	\$99,000	\$99,000	\$99,000	\$135,000
Total Net Effect (first year)	(\$243,882)	(\$213,438)	(\$244,659)	(\$237,979)
Park Fund				
Revenue	\$7,452	\$11,398	\$7,156	\$26,006
Expenditures	\$0.00	\$0.00	\$0.00	\$0.00
	\$7,452	\$11,398	\$7,156	\$26,006
Debt Service Fund				
Revenue	\$47,710	\$65,325	\$41,013	\$149,048
Expenditures	\$0.00	\$0.00	\$0.00	\$0.00
	\$47,710	\$65,325	\$41,013	\$149,048
Total:	(\$193,720)	(\$136,715)	(\$196,490)	(\$62,925)



CHARACTERIZATION OF ANNEXATION AREAS

BOUNDARIES

ANNEXATION AREA NO. 1: LEGAL DESCRIPTION

All those parts of Sections 1, 2 and 3 all in Township 46 North, Range 32 West, Cass County, Missouri, more particularly described as follows:

Beginning at the Northwest corner of the Northeast $\frac{1}{4}$ of the Northeast $\frac{1}{4}$ of said Section 3; thence South to the Southeast corner of the Southwest $\frac{1}{4}$ of the Northeast $\frac{1}{4}$ of said Section 3; thence West to the Northwest corner of the Southeast $\frac{1}{4}$ of said Section 3; thence South to the Southwest corner of the Southeast $\frac{1}{4}$ of said Section 3; thence East along the South line of said Section 3 to a point 1400 feet West of the Southeast corner of said Section 3; thence North 650 feet; thence East 740 feet; thence South 650 feet to a point on the South line of said Section 3; thence East along the South line of said Section 3 to the Southeast corner of said Section 3; thence East along the South lines of said Sections 1 and 2 to the Southeast corner of said Section 1; thence North along the East line of said Section 1 to the Southeast corner of the North $\frac{1}{2}$ of said Section 1; thence West along the South line of the North $\frac{1}{2}$ of said Section 1 to the Southwest corner of the North $\frac{1}{2}$ of said Section 1; thence North along the West line of said Section 1 to the Northwest corner of said Section 1; thence West along the North lines of said Sections 2 and 3 to the Northwest corner of the Northeast $\frac{1}{4}$ of the Northeast $\frac{1}{4}$ of said Section 3 and the Point of Beginning.

This area comprises about 1.9 square miles. **See Attachment G.**

ANNEXATION AREA NO. 2: LEGAL DESCRIPTION

All those parts of Sections 10, 11, 12, 13 and 14 all in Township 46 North, Range 32 West, Cass County, Missouri, and all those parts of Sections 5, 7, 8, 17 and 18 all in Township 46 North, Range 31 West, Cass County, Missouri, more particularly described as follows:

Beginning at the Southwest corner of the Southeast $\frac{1}{4}$ of the Northeast $\frac{1}{4}$ of said Section 14; thence East along the South line of the North $\frac{1}{2}$ of said Sections 14, 13, 18 and 17 to the Southeast corner of the North $\frac{1}{2}$ of said Section 17; thence North along the East line of said Section 17 to the Northeast corner of said Section 17, said point also being on the existing South city limits line of the City of Lake Winnebago, Missouri; thence West and North along said city limits line to its intersection with the existing West right of way line of Missouri Highway 291, said point also being the Southwest corner of the City of Lake Winnebago; thence Northwesterly along said West right of way line and along said city limits line to its intersection with the existing city limits line of the City of Lee's Summit, Missouri; thence West along the existing City of Lee's Summit city limits line to its intersection with the East line of said Section 6; thence South along the East line of said Section 6 and along the existing city limits line of the City of Lee's Summit, to the Southeast corner of said Section 6; thence West along the South line of said Section 6 and along the existing city limits line of the City of Lee's Summit, to its intersection with the prolongation of the West line of Lot 2, Brigance Acres, a subdivision in the City of Lee's Summit, Cass County, Missouri; thence North along the West line of said Lot 2, and along the existing city limits line of the City of Lee's Summit, to the Southwest corner of said Lot 2; thence West along the South line of said Lot 2 and along the South line of Lot 945, Raintree Lake, a subdivision in the City of Lee's Summit, Cass County, Missouri and along the existing city limits line of the City of Lee's Summit, to the Southwest corner of said Lot 945; thence South along the existing city limits line of the City of Lee's Summit to a point on the South line of said Section 6; thence West along the South line of said Section 6 and along the existing city limits line of the City of Lee's Summit, to the Southwest corner of said Section 6, said point also being on the East line of Section 1, Township 46 North, Range 32 West; thence South along the East line of said Section



1 to the Southeast corner of said Section 1; thence West along the North line of said Sections 12 and 11 to the Northwest corner of said Section 11; thence South along the West line of said Section 11 to the Northwest corner of the South ½ of the Southwest ¼ of said Section 11; thence East along the North line of the South ½ of the Southwest ¼ of said Section 11 to the Northeast corner of the South ½ of the Southwest ¼ of said Section 11; thence North to the Northeast corner of the Southwest ¼ of said Section 11; thence East to the Northeast corner of the Southwest ¼ of said Section 12; thence South to the Northwest corner of Ward Park Place, a subdivision in the City of Raymore, Cass County, Missouri; thence West along the North line of said Ward Park Place to the intersection of the prolongation of said North line with the East line of said Section 12; thence South along the East line of said Sections 12 and 13 to its intersection with the prolongation of the South line of Alexander Creek, a subdivision in Cass County, Missouri; thence West along the South line of said Alexander Creek, to a point on the East line of the Northeast ¼ of the Northwest ¼ of said Section 13; thence North to the Northeast corner of the Northwest ¼ of said Section 13; thence West along the North lines of said Sections 13 and 14 to the Northwest corner of the Northeast ¼ of the Northeast ¼ of said Section 14; thence South to the Southwest corner of the Southeast ¼ of the Northeast ¼ of said Section 14 and to Point of Beginning.

AND

Lot 1, Lot 2 except the North 381.44 feet, Lot 3 except the North 381.44 feet of the East 123.14 feet and except the West 183 feet of said Lot 3, Lots 4-7, Lot 9, Lots 11-13, Lot 15, Lot 17, Lot 20 and Lot 22, all in Willow Hills, a subdivision in Cass County, Missouri.

This area comprises about 4.4 square miles. **See Attachment H.**

ANNEXATION AREA NO. 3: LEGAL DESCRIPTION

All those parts of Sections 13, 14 and 23 all in Township 46 North, Range 32 West, Cass County, Missouri, and all those parts of Sections 17, 18, 19 and 20 all in Township 46 North, Range 31 West, Cass County, Missouri, more particularly described as follows:

Beginning at the Southwest corner of said Section 19; thence East along the South lines of said Sections 19 and 20 to the Southeast corner of said Section 20; thence North along the East lines of said Sections 20 and 17 to the Northeast corner of the South ½ of said Section 17; thence West along the North line of the South ½ of said Sections 17, 18, 13 and 14 to the Northeast corner of the West ½ of the Northeast ¼ of the Southeast ¼ of said Section 14; thence South to the Southeast corner of the West ½ of the Northeast ¼ of the Southeast ¼ of said Section 14; thence West to the Northwest corner of the Southwest ¼ of the Southeast ¼ of said Section 14; thence South to the Southwest corner of the Southeast ¼ of said Section 14; thence East along the South lines of said Sections 13 and 14 to the Southeast corner of said Section 13; thence South along the West line of said Section 19 to the Southwest corner of said Section 19 and the Point of Beginning.

AND

The Southeast ¼ of the Northeast ¼ of said Section 23.

This area comprises about 3.7 square miles. **See Attachment I.**

GENERAL DESCRIPTION

POPULATION

Data from the 2000 United States census indicates that total populations for each of the proposed annexation areas are as follows:



Area 1: 398

Area 2: 614

Area 3: 445

TOPOGRAPHY

The terrain is consistent throughout all three areas: low rolling hills that ebb into small drainage basins. In Area 1 these basins generally drain to the east, in Area 2 they generally drain to the northeast and in Area 3 they generally drain to the southeast. None of the three areas has a major waterway. All water corridors are shallow and sided with natural riparian vegetation. Agricultural practices and, to a lesser extent, residential development, have disturbed a majority of the physical geographic features.

EXISTING LAND-USE/ZONING

Overview: All three areas, which are under the jurisdiction of Cass County, are predominately rural with a vast majority of land being used for crops and grazing of horses and dairy/feed cattle. Each contains sections of residential development, all of which reflect some characteristics of rural suburban developments such as no curbs, sidewalks or streetlights, some privately maintained roads, some gravel roads and many “no outlet” roadways.

Area 1: All 232 parcels are zoned agricultural or residential. Most residences sit on three or more acres except for those in the northern half of the Mullendike neighborhood, which is located in the east portion of the area. (**See Attachment K**).

Area 2: The vast majority of the 354 parcels are zoned agricultural or residential except for: two with special use permits, two with C-2 pending, and six with existing businesses. South Metro Fire Station # 2 is located in the northeast portion of the area west of 291 Highway and a church is located in the east central portion west of 291 Highway. Most residences sit on three or more acres except for those in the southern half of the Mullendike neighborhood located in the central portion of the area. (**See attachment L**).

Area 3: Similarly, most of the 233 parcels are zoned agricultural or residential except for: one C-2 pending, one special use, four vacant C-2, (one existing business) and a church in the south central portion east of Ward Road. A 120-acre parcel in the south central portion is owned by the Raymore-Peculiar School District and another parcel in the southeast portion contains a private paved runway. Most residences sit on three or more acres except for those in the Dikeland neighborhood located in the north central portion of the area. (**See Attachment M**).

DEVELOPMENT PATTERN

A generally scattered low density development pattern is prevalent in all three areas with the Mullendike and Dikeland neighborhoods being the only exceptions. All developments are accessed via county and state roads. Rural homesteads, farms and ranches exist in all three but are most prevalent in Area 2 and Area 3. Most are adjacent to county and state roads.

TRANSPORTATION

Area 1: All main roadway corridors consist of two lanes and are maintained by Cass County Road and Bridges. They include E 155th St on the north, Ward Rd. on the east, E 163rd St (Gore Road) on the south, Kurzweil Rd. in the west portion of the area and S. Prairie Lane Rd. in the central section. A portion of E 155th St. and E. 163rd St (Gore Road) have received more improvements than have the other mentioned roads. No roadway transgresses the interior of this area from its east to west boundaries.



Area 2: All main roadway corridors consist of two lanes and are maintained by Cass County Roads and Bridges and the Missouri and Highway and Transportation Department. They include E 163rd St (Gore Road) on the north, 291 Highway in the eastern section, 58 Highway on the south, S. Prairie Lane Rd. in the western area and Ward Rd. in the west central section. Both highways meet or exceed standards for such roadways. E 171st St is the only east-west roadway which transgresses the interior of this area and does so in the east central portion.

Area 3: All main roadway corridors consist of two lanes and are maintained by Cass County Roads and Bridges and the Missouri Highway and Transportation Department. They include 58 Highway on the north, 291 Highway in the eastern section, E. Hubach Hill Road and E. Lucy Webb Road on the south boundaries, S. Prairie Lane Road in the western area and Ward Rd. in the west central section. Both highways meet or exceed standards for such roadways. E. Lucy Webb Road is the only roadway which transgresses the interior of this area from east boundary to west boundary.

UTILITIES

Area 1: Aquila provides electricity, Cass County Water District #3 provides water and storm water management is restricted to private property owner controls. Since no natural gas is available, propane is widely used for heating. All properties have septic systems for on-site disposal of sanitary waste except for those in the Mullendike neighborhood which has its own sanitary sewer system. All septic systems in the area are regulated by the Cass County Health Department.

Area 2: Aquila provides electricity, Cass County Water Districts #3 and #6 provide water and storm water management is restricted to private property owner controls. Since no natural gas is available, propane is widely used for heating. All properties have septic systems for on-site disposal of sanitary waste except for those in the Mullendike neighborhood which has its own sanitary sewer system. All septic systems in the area are regulated by the Cass County Health Department.

Area 3: Aquila provides electricity to all but the southeastern quarter of the area where Osage Valley Electric is the provider. Cass County Water Districts #6 and #10 provide water and storm water management is restricted to private property owner controls. Since no natural gas is available, propane is widely used for heating. All properties have septic systems for on-site disposal of sanitary waste except for those in the Dikeland neighborhood which has its own sanitary sewer system. All septic systems in the area are regulated by the Cass County Health Department.

HEALTH SERVICES

In all three areas, health services are provided by the Cass County Health Department which offers the WIC nutrition program for women, infants and children and for those meeting income guidelines. The department also offers monthly immunization clinics for all school-age children and stores vital records such as birth (beginning from 1920) and death (starting from 1980). Other services include communicable disease control, environmental sanitation inspections, sewage/water disposal inspections, a bioterrorism unit and services as contracted by the Missouri Department of Health.

PARKS AND RECREATION SERVICES

No parks and recreation services are provided in any of the three areas due to the fact that no such services are provided by Cass County.

FIRE PROTECTION

All three areas are served by the South Metro Fire Protection District (SMFPD) which also provides EMS



as well as many related and unrelated services including but not limited to: free smoke detectors, assisting residents who are locked out of their homes and cars and fire safety inspections. SMFPD is unaware of any large quantities of hazardous materials stored in any of the three areas.

LAW ENFORCEMENT

Law enforcement in all three areas is provided by the Cass County Sheriff's Department. During the period January 1, 2003 through December 31, 2005, deputies made a total of 1,767 emergency and non-emergency responses in all three areas. Emergency responses were identified as those calls for law enforcement assistance/intervention which required immediate dispatch to protect the health, safety and welfare of the public. Non-emergency responses were identified as responses to calls which did not convey present danger to the public. The breakout of all these responses is as follows:

	<i>Area 1</i>	<i>Area 2</i>	<i>Area 3</i>
2003			
Emergency	73 / 48%	102 / 43%	64 / 50%
Non-Emergency	79 / 52%	136 / 57%	65 / 50%
2004			
Emergency	69 / 49%	104 / 52%	169 / 58%
Non-Emergency	72 / 51%	96 / 48%	123 / 42%
2005			
Emergency	87 / 53%	93 / 34%	70 / 40%
Non-Emergency	78 / 47%	183 / 66%	104 / 60%

Requests for law enforcement responses went up in all three areas. Area 1 experienced an 8.5% increase in service requests during the period. Area 2 saw a 16% increase and Area 3 had a 35% increase.

SCHOOLS

Area 1: This entire area is served by the Raymore-Peculiar R-2 School District. Students attend Creekmoor or Timber Creek Elementary Schools, Eagle Glen Intermediate School, Raymore-Peculiar Middle School, Raymore-Peculiar Freshmen Center, Raymore-Peculiar High School.

Area 2: This entire area is served by the Raymore-Peculiar R-2 School District. Students attend Timber Creek Elementary School, Eagle Glen Intermediate School, Raymore-Peculiar Middle School, Raymore-Peculiar Freshmen Center, Raymore-Peculiar High School.

Area 3: The northern and western portion of this area is served by the Raymore-Peculiar R-2 School District. Students attend Timber Creek Elementary School, Eagle Glen Intermediate School, Raymore-Peculiar Middle School, Raymore-Peculiar Freshmen Center, Raymore-Peculiar High School. The Raymore-Peculiar R-2 School District recently purchased 120 acres near the Pleasant Hill R-3 boundary for a new Middle School/ Freshmen Center/High School campus. The southern and eastern portion is served by the Pleasant Hill R-3 School District. Students attend Pleasant Hill Primary School, Pleasant Hill Elementary, Pleasant Hill Middle School, Pleasant Hill High School.

See Attachment N for a map of the school districts.



MAJOR CITY SERVICES

ADMINISTRATION DEPARTMENT

The Administration Department comprises City Administration, City Attorney, Human Resources, Information Technology Services, City Clerk, Economic Development and Municipal Court Administration. The latter three areas are addressed individually.

All divisions of the Administration Department serve the entire Raymore population.

- ▣ City Management/Administration supervises and coordinates all City operations and activities. It advises the Mayor and Council regarding policy matters, implements the policies and directives of the Council including the annual budget and capital program, oversees the City's personnel system and provides information to the public.
- ▣ The City Attorney represents the City in all legal proceedings and is the chief legal advisor to the Mayor, Council, city staff, departments, offices and agencies.
- ▣ Human Resources oversees and executes all personnel and employee functions, including recruiting and hiring, labor relations, employee benefits, training and development and risk management efforts.
- ▣ Information Technology provides comprehensive services to the city of Raymore through four programs: System Administration, Client Support, Capital Asset Replacement and Web Page Development.

EFFECTS OF ANNEXATION

Workload increases associated with annexation of one or more of the three proposed areas are anticipated to be minimal for the aforementioned four areas of Administration. Current staffing levels, with increases that may occur irregardless of annexation, should be capable of adequately handling additional work.

It is estimated that Administration will incur no additional costs due to annexation of any of the three proposed areas.

SERVICE TIME SCHEDULE

Because most of Administration's aforementioned services are internal in nature, they will be provided at the effective date of annexation.

CITY CLERK'S OFFICE

Retention management of all City records is the primary responsibility of the two full-time employees in the City Clerk's Office. Such management includes, but is not limited to, assisting citizens and the media in researching ordinances, contracts and other public information; updating and maintaining the City Code; preparing information for City Council meetings; and serving as a repository for permanent records of all such meetings.

The following services of the City Clerk's Office directly affect both current and future Raymore residents:

- ▣ Issuance of occupational licenses, fireworks permits and liquor licenses
- ▣ Mailing of information packets to all new residents



EFFECTS OF ANNEXATION

Annexation is expected to moderately increase workloads for the two full-time employees in the City Clerk's Office specifically in terms of responding to more requests for information, issuing additional licenses and permits and mailing new resident packets. Currently, occupational licenses are required by all Raymore businesses, no matter their physical size or volume of sales. Approximately 1,100 such licenses were issued in 2005. The Clerk's Office sent out an average of 80 new resident packets every month in 2005. Workload increases however are not expected to be appreciably higher within the time frame under consideration therefore it is estimated that the City Clerk's Office will incur no additional costs due to annexation of any of the three proposed areas.

SERVICE TIME SCHEDULE

City Clerk services will be extended to all three proposed areas at the effective date of annexation.

ECONOMIC DEVELOPMENT DEPARTMENT

Retention and expansion of existing businesses as well as providing assistance to new businesses and industries interested in locating in the City are the primary focuses of the two full-time employees in the Economic Development Department. It is also responsible for creating an environment that will be responsive to the concerns of residents as well as the development community and which will generally improve the quality of life in Raymore.

THE ECONOMIC DEVELOPMENT DEPARTMENT

- ▣ Responds to inquiries from citizens, city staff, developers and representatives of commercial businesses
- ▣ Recruits new businesses
- ▣ Markets the benefits of Raymore to residents and developers

EFFECTS OF ANNEXATION

Annexation is expected to moderately increase workloads for the two full-time employees in the Economic Development Department. Even though this increase is expected to be higher for Area #2, due to the potential for future development in and around the intersection of M-58 and M-291 Highways, and for Area #3, due to the potential for future development in and around the intersection of Hubach Hill Road and 291 Highway, it is expected that current staff can adequately handle the additional work. It is therefore estimated that the Department will incur no additional costs due to annexation.

SERVICE TIME SCHEDULE

Economic Development services will be extended to all three proposed areas upon the effective date of annexation.

FINANCE DEPARTMENT

The Finance Department, through its five full-time employees, provides support, administration, management and reporting for all of Raymore's finances. It sees to it that the City complies with federal, state and local statutes, regulations and codes, thus ensuring accountability and prudent use of public funds.



The following four areas of responsibility directly and indirectly affect the entire Raymore population:

- ▣ Administration/Purchasing manages the Department, coordinates audits, prepares budgets, procures assets, establishes internal controls and procedures and drafts fiscal policy. It also represents the City when financial matters are presented to the public.
- ▣ Accounting reports and records the City's financial activities according to all requirements and Generally Accepted Accounting Principals.
- ▣ Cash and Debt Management provides fiduciary and custodial duties for the City's cash and debt management policies, procedures and activities.
- ▣ Utility Billing provides accurate utility account management to over 6,100 service addresses and coordinates utility services between the Public Works Department and customers.

EFFECTS OF ANNEXATION

It is anticipated that annexation might increase the workloads for three of the Finance Department's six employees when City water service and sewer lines are extended to each of the three annexed areas. At that time, the two utility clerks will send out more utility billings and the receptionist will, in turn, open more payments. All three however should be able to handle the additional work. It is therefore estimated that Finance will incur no additional personnel or capital costs due to annexation of any of the three proposed areas.

SERVICE TIME SCHEDULE

Finance's external utility billing service will be provided to each of the three areas if and when Raymore's water service and sewer lines are extended to them following the effective date of annexation.

MUNICIPAL COURT

As a division of Cass County Circuit Court, Raymore Municipal Court has the jurisdiction to hear and rule on all complaints pertaining to City Ordinances. Its responsibilities, handled by one full-time and one part-time employee, include: maintenance of all files and documents necessary to schedule and conduct trials, pleas, pre-trial hearings, sentencing, probation revocation hearings and post-trial motions related to violations of City ordinances.

Three programs within the Court—Administration, Court Operations and Customer Service—fulfill the aforementioned responsibilities for current and future Raymore residents.

- ▣ Administration is the operational wing of the Court. It operates all probation programs, develops and implements court policies and procedures, new state legislation and city ordinances, and coordinates communication and working relationships among the Court staff, the public, Police Department and affected city staff.
- ▣ Court Operations handles adjudication of all code violations filed by the City Prosecutor. Such violations include, but are not limited to all traffic tickets, common assault, domestic violence, general ordinance violations, drug possession, animal control violations, building/inspection code violations and zoning violations. This program also tracks open court cases and monitors accounts receivable payment plans.



Court sessions are held twice per month on the first and third Thursdays. Approximately 350 cases are scheduled for each docket out of which 275 are actually adjudicated. The maximum number of cases that can be scheduled for a docket is 400.

- Customer Service provides permissible information about court cases and appoints attorneys when necessary. It also collects fines, filing fees and bail bonds.

EFFECTS OF ANNEXATION

Depending upon enforcement, citations may increase for all violations especially code, animal control and traffic, but the effects of such increases on Municipal Court should be the same or similar for each of the three areas. For example, workload increases resulting from annexation of Area 1 should be no greater or less than those resulting from annexation of either of the other two areas, 2 and 3. Because the average number of cases per docket, 350, is below the maximum of 400, elasticity is available to accommodate any increased citations due to the annexation of any of the areas. It is estimated that municipal court will incur no additional expenses as a result of annexation.

SERVICE TIME SCHEDULE

Municipal Court Services will be extended to all three proposed areas at the effective date of annexation.

PARKS AND RECREATION DEPARTMENT

Acquisition, development and maintenance of parks and park lands and maintenance of Raymore city buildings and grounds are handled by the Parks Department in conjunction with the Park Board. Additionally, the Department, which has nine full-time employees, is responsible for planning and sponsoring an array of athletic and recreation programs and special events which are open to all Raymore citizens as well as to residents of surrounding areas including those in the three proposed annexation areas.

Three divisions within the Department, Administration, Recreation and Building and Grounds, fulfill the aforementioned responsibilities for current and future Raymore residents.

- The Administration Division manages all properties overseen by the Park Board. They include five existing parks and other park lands, along with amenities contained therein such as shelters and ball fields.
- The Recreation Division plans, organizes and offers numerous activities, sports programs and special events. It ensures that all functions are offered at appropriate sites and are adequately staffed.
- The Building and Grounds Division maintains all Raymore city buildings and surrounding property as well as all parks and parkland.

EFFECTS OF ANNEXATION

The fee schedule for participating in the City's recreation programs is the same for residents and non-residents. Annexation of one or more of the areas will therefore have no effect on income from recreation program fees. The fee schedule for rental of City facilities, such as park shelters, is lower for residents than for non-residents. Annexation of one or more of the areas may result in a slight decrease in revenues from rentals since residents of those areas will pay the lower resident fees. This decrease should not be appreciable. As well, no operating costs should appreciably increase.



The City's goal is to have 20 acres of park land for each 1,000 residents. Assuming that 1,500 more people would be annexed into Raymore, 30 acres of parkland would be necessary to meet the City's stated goal. Each acre of land is estimated to cost about \$15,000. The City will work within the framework of its land dedication ordinance and seek opportunities with other governmental jurisdictions to acquire this land.

Parks will not incur any additional operating or capital expenditures as a result of the annexation.

SERVICE TIME SCHEDULE

Parks and Recreation services will be extended to all three proposed areas on an as-needed basis at the effective date of annexation.

PUBLIC WORKS DEPARTMENT

Public Works comprises the Engineering, Streets and Stormwater, and Utilities Divisions.

ENGINEERING DIVISION

The Engineering Division is responsible for:

- ▣ Developing and administering the City's Capital Improvements Program.
- ▣ Inspecting development driven infrastructure projects.
- ▣ Implementing the water, sewer, and transportation master plans.
- ▣ Conducting site plan and plat review associated with new development.
- ▣ Implementing the Watershed Management Study.
- ▣ Implementing the NPDES requirements for stormwater quality.
- ▣ Administering the long-range street maintenance/repair/replacement plan.

According to current City policy, the financing and construction of all new roadways within a development are the responsibility of the developer. If off-site improvements are necessary, the developer must provide any necessary right of way as well as place the appropriate share of funding into escrow. Finally, should an off-site improvement be identified as part of the excise tax program, the developer can provide the funding at the inception of the project and may be eligible for reimbursement as excise tax revenue is available.

New development is responsible for all necessary sanitary sewer improvements according to the sewer master plan. Additionally, new development is assessed a sewer connection fee for other capital improvements. Should developers construct projects outlined in the sewer master plan in advance of capital improvements funding, they may be eligible to receive credit for that project.

Current City code also mandates that any property within 100 feet of a property line or, if constructed after 1999 and with a property line within 300 feet of a public sewer, must connect to the City's system. It is the City's intention to incorporate, as part of the revisions to the zoning code for "rural residential" uses, changes to not require connection to a public sewer unless the primary structure is located within 300 feet of a public sewer. Furthermore, it is the City's position that newly annexed properties served by a septic system will not be required to connect to the public sewer system until their private system fails.

EFFECTS OF ANNEXATION

It is not anticipated that there will be any significant impact on the engineering division should any of the areas be annexed.



An 18-inch sanitary sewer main currently serves the northern portion of the area under consideration. Development anticipated in that area most likely cannot be served by this size main. To better determine the size of main necessary in this area, it will be necessary to conduct a revision study of the sewer master plan. The cost of such a study is estimated to be \$25,000.

SERVICE TIME SCHEDULE

New roadway maintenance will be provided according to current city policies three years from the effective date of annexation. No additional costs are anticipated.

Sanitary sewer services now provided to City of Raymore residents will be provided three years after the official effective date of annexation, according to policies existing at the time of annexation approval. No additional costs are anticipated.

STREETS AND STORMWATER

The Streets and Stormwater Division is responsible for:

- Maintenance of streets
- Removal of snow and treatment of ice on roadways
- Repair of the stormwater collection system.

The City currently uses a Pavement Management System to first assess the condition of roadways and then prioritize them according to need. This information is then taken into consideration as the City annually develops its capital improvements program. Each year, about \$500,000 is allocated to roadway maintenance and repair. If any of the three areas are annexed, all streets in them will be analyzed and prioritized just like those within the City's current boundaries.

The City is in the process of implementing street signs according to the Manual on Uniform Traffic Control Devices. All new roadway signs installed or replaced by the City adhere to MUTHCD standards as do signs installed by developers.

The City currently prioritizes snow removal services according to collector streets and snow routes. Roadways brought into the corporate city limits as the result of annexation would be included in that prioritization in terms of how quickly they would be plowed. One consideration is the ability of the City to plow gravel roadways. This necessitates the use of a special rubber blade on the truck. The City does have such a blade and does not anticipate any significant capital expenditure necessary to plow gravel roadways.

The City routinely inspects and maintains its stormwater collection system to comply with its NPDES Phase II permit. A program is in place to provide maintenance, rehabilitation and repairs to the existing system.

EFFECTS OF ANNEXATION

Should all three proposed areas be annexed, it is estimated that 71 additional lane miles will be added to the City's current 250 lane miles. Of those, about 26 miles are gravel; the remainder are asphalt or chip and seal.

For any one area annexed, one additional employee will be necessary at a cost of \$47,000. Thus, if two areas are annexed, the cost will be \$94,000. If three areas are annexed, the cost will be \$141,000.

If one, two or all three areas are annexed, an F750 truck will be necessary. Its cost is estimated to be \$90,000. Also, the City's Vehicle Equipment Replacement Program calls for setting aside funds in the operating budget



for the replacement of new vehicles. The estimated impact on the operating budget of the purchase of the F750 truck is \$10,000 per year.

If Area 1 is annexed, \$12,200 would be needed for salt and rock. If Area 2 is annexed, \$14,700 would be needed for salt and rock. If Area 3 is annexed, \$16,100 would be needed for salt and rock.

Finally, materials for snow removal and street maintenance would have to be increased annually by \$24,000 for rock and \$19,000 for salt.

SERVICE TIME SCHEDULE

Roadway maintenance, snow removal and maintenance and repair of the stormwater collection system will begin immediately in all three areas upon the effective date of annexation.

UTILITIES DIVISION

The Water Utility Division is responsible for:

- ▣ Operation of the water system
- ▣ Maintenance of the water system

The City currently purchases all of its water from the City of Kansas City, Missouri. However, City staff inspects and maintains the distribution system, the Kentucky Pump Station and three storage facilities. As well, it locates valves, maintains an inventory of hydrants, and assures compliance with State and Federal regulations.

EFFECTS OF ANNEXATION

All three of the proposed annexation areas are serviced by Water Districts 3, 6, or 10. According to state law, these districts will continue to serve these areas even should they be annexed by Raymore.

SERVICE TIME SCHEDULE

Since the City will not provide water even if one or more of the three areas is annexed, residents in them will continue to receive water from Water Districts 3, 6 or 10.

SEWER UTILITY DIVISION

The Sewer Utility Division is responsible for:

- ▣ Operation of the sanitary sewer collection system
- ▣ Maintenance of the sanitary sewer collection system

Personnel in this division regularly inspect the system as well as three lift stations so as to ensure compliance with State and Federal standards. The division implements an inflow and infiltration correction program and uses closed circuit television for sewer inspections.

The areas commonly known as Mullendike and Dikeland are existing sewer districts, each with their own board. Both are sub-districts of Middle Big Creek, which is a sub-district of Little Blue Valley. While neither Mullendike nor Dikeland have outstanding debt of their own, Middle Big Creek has between \$7 and \$8 million



in outstanding debt. Mullendike and Dikeland pay for a portion of the Middle Big Creek debt as a portion of their rates.

Additionally, the areas of Mullendike and Dikeland appear to be within the boundaries of Cass County Water Supply District No. 3, and CCWSD No. 3 currently provides the water service to Mullendike and Dikeland.

EFFECTS OF ANNEXATION

- 1) The sewer district has captured the right to provide sewer service in its boundaries.
- 2) The water district has captured the right to provide water service everywhere within its boundaries, including within the sewer districts.
- 3) Where the water district and the sewer district overlap, neither can offer a service that competes with the other.
- 4) The water district and the sewer district have priority over the city to provide these services, within their respective boundaries.

Because of these issues, the City cannot provide service to these areas unless an agreement is reached for such service. Therefore, no increased costs are anticipated at this time.

See Attachment O for recommended sewer system improvements.

SERVICE TIME SCHEDULE

Should the City negotiate an agreement to serve the areas known as Mullendike and Dikeland, Middle Big Creek and Little Blue Valley would require Raymore to continue to charge rates sufficient for to pay the debt service for Mullendike and Dikeland's share of the outstanding bond debt.

POLICE DEPARTMENT

The Police Department has two divisions: Operations and Support Services. Each division is then further subdivided into areas of expertise, staffed by personnel specifically trained for those functions.

OPERATIONS DIVISION

All units within the Operations Division fulfill responsibilities which directly and indirectly affect current and future Raymore residents. Those units are Administrative Services, Patrol and Investigations. Also, a community interaction officer, D.A.R.E., the tactical team, and bicycle patrol activities are operated from this Division.

- ▣ Administrative Services is responsible for overseeing the overall operation of the department, ensuring adequate staffing levels; providing department wide training; and allocating resources.
- ▣ Patrol responds to emergency and non-emergency calls for service, enforces traffic laws and performs preliminary criminal investigations. In addition to four sergeants, this unit has 12 patrol officers, many of whom are trained to provide bicycle patrol and tactical team services. It functions with one sergeant and three officers on each 12-hour shift covering the current corporate limits. The average response time for emergencies is 3 to 3.5 minutes and for non emergencies is 6 to 7 minutes. Response times however depend on the location of the call and the location of the officer responding. Some calls have 8- to 13-minute response times if the responding officer is on another call or at headquarters and others are 10 to 17 minutes if the service address is east of 291. Patrol also operates the

**CITY OF RAYMORE
 PLAN OF INTENT**



community interaction program through which, community policing initiatives such as DARE functions, Neighborhood Watch, Boy Scout Explorers and a Citizen’s Police Academy are provided.

- ▣ The Investigations Unit provides follow up investigative work on criminal activity and is the liaison with the prosecutor’s office. It is staffed by one detective sergeant and three detectives, one of whom provides DARE instruction to fifth grade classes.

EFFECTS OF ANNEXATION

The following chart shows the call volume for each of the areas in 2005.

	<i>Area 1</i>	<i>Area 2</i>	<i>Area 3</i>	<i>Combined Total</i>
<i>Emergency</i>	87	93	70	250
<i>Non-Emergency</i>	78	183	104	365
<i>TOTAL</i>	165	276	174	615

The Raymore Police Department currently responds to about 8,000 calls per year, or about 22 calls per day. That call volume is continually growing, and it is expected that the City will hire additional officers in the next three years, regardless of successful annexation.

If the current areas under consideration are annexed, calls would increase by one to two per day. However, additional patrol and other services would also be provided.

To fully implement all of Patrol’s functions in one, two or all of the proposed annexation areas would necessitate the hiring of two additional police officers at a cost of about \$85,000, and an additional car at a one- time cost of \$24,000 and an ongoing operational cost of \$9,000 per year for the Vehicle Equipment Replacement Program.

SERVICE TIME SCHEDULE

All Patrol Unit services would be provided to the newly annexed area(s) immediately upon the effective date of annexation.

SUPPORT SERVICES DIVISION

The Support Services Division comprises the Animal Control, Communications and Emergency Management Units along with maintaining all police department records, processing permits and licenses, and managing all evidence.

- ▣ Animal Control is staffed by one full-time animal control officer and a part time animal control officer. These officers enforce appropriate regulations, remove and dispose of deceased animals, provide public education and animal adoption counseling. Current City codes pertaining to the keeping of animals are more restrictive than those in Cass County. Raymore allows a combination of four dogs or cats over the age of six months. As well, dogs and cats are required to be kept “harbored” in a fence or on a leash.
- ▣ Communications is staffed by one communications supervisor, six full-time communications officers, and one part-time position. It provides dispatching services for the Raymore Police Department, the Peculiar Police Department, and the South Metro Fire Protection District. Two dispatchers are on



duty at all times, with the exception of 11 p.m. to 7 a.m. Monday through Friday and 11 p.m. to 11 a.m. Saturday and Sunday.

The police chief currently operates as the City's director of emergency management. As such, he coordinates plans and procedures regarding the execution of major emergency and disaster planning and operations. One of the most visible parts of emergency management to any citizen is the tornado warning siren system.

EFFECTS OF ANNEXATION

- ▣ Support Services does not anticipate that volumes will increase to such an extent that additional animal control services will be needed.
- ▣ Annexation of all three areas would result in an additional 11 square miles that currently aren't served by warning sirens. It is estimated that two additional sirens, at a cost of \$18,000 each, would be necessary. ***A map indicating existing sirens and placement of proposed sirens is in Attachment P.***
- ▣ Call volumes to Communications have been steadily increasing, creating a near-term need for two additional dispatchers. It is anticipated that additional dispatchers will be hired in Raymore whether or not annexation takes place. These additional dispatchers handle the increased call volume generated by the area, whether or not it is annexed.
- ▣ The ability of police officers to communicate with one another is essential to their safety and the safety of all citizens. The City just approved the purchase of six voters to expand walkie-talkie communication to the north and to the east. Annexation would require between two and four additional voters at a one-time cost of \$4,500 each. However, these are financed through Cass County's 9-1-1 program and will not be an additional expenditure for the City.
- ▣ The property evidence and supply and records unit functions are each handled by one employee. It is not anticipated that annexation would have an effect on either of these operations.

SERVICE TIME SCHEDULE

All services of the Support Services Division would be provided to one or more of the three areas area immediately upon the effective date of annexation.

COMMUNITY DEVELOPMENT DEPARTMENT

Community Development has two divisions:

- 1) ***Planning and Zoning***
- 2) ***Building Inspections***

- ▣ Planning and Zoning is responsible for comprehensive planning, subdivision plat review, rezoning, conditional use permits, site plan review, GIS, code enforcement and variances. A third planner was included in the 2006 budget, allowing this division to better address current development issues as well as any of those that might be associated with development in the three areas being considered for annexation. The code enforcement officer identifies, investigates and responds to complaints regarding violations of the City Code, including nuisances, weeds, property maintenance, signs and zoning violations. Currently, one code enforcement officer addresses these issues, and supervises community service workers on the weekends.



- Building Inspections ensure that residential, commercial and industrial structures conform to all applicable codes and approved plans. This division is staffed by a building official, two building inspectors and a secretary.

EFFECTS OF ANNEXATION

It is not anticipated that annexation will have any effect on the provision of the services of Geographic Information Systems.

In each of the proposed annexation areas, there are some neighborhoods that under current Raymore city code would have numerous violations. To appropriately address these violations as well as to maintain use of the community volunteers, which must be supervised by a City employee, a second code enforcement officer would be necessary at a cost of \$47,000 regardless of the how many of the areas are annexed.

While it is not anticipated at this time that an additional building inspector would be needed if one or more of the three proposed areas are annexed, it is possible that the occurrence of dangerous buildings would necessitate further consideration.

The City has already said that, in the event of annexation, it would recognize existing land-uses. The City is now considering the adoption of rural zoning districts to better address the needs of current, and potentially future, rural areas in Raymore. These zoning districts will provide for agricultural uses and practices and for the development of acreage style rural residential housing.

Any newly proposed zoning in the newly annexed areas shall be in keeping with the Future Land-use Plan of the City of Raymore Growth Management Plan. As sewer service becomes available, the zoning shall be changed to reflect the anticipated market demands for commercial uses at priority roadway intersections and along key transportation corridors. The intersection of Highway 58 and 291 Highway is one example of such a priority area. Other areas would likely be zoned for residential uses.

If existing land-uses located in the annexation area do not conform to City of Raymore zoning standards, special consideration will be provided to that entity by the City. Where applicable, the City may develop appropriate zoning controls to permit such uses by special permit or in a manner consistent with generally accepted zoning practices in surrounding jurisdictions.

SERVICE TIME SCHEDULE

Community Development services would become available to one or more of the three areas immediately upon the effective date of annexation. It would be the City's intent to begin enforcing codes upon the effective date, with full compliance anticipated by three years from the effective date of annexation.

The City recognizes that development standards in some parts of the potential annexation areas differ significantly than in current areas of the community. The City will work with residents of such areas to phase in enforcement of zoning, codes enforcement, and building inspections. Full enforcement will not begin until three years from the effective date of annexation (i.e. six years from the date that annexation is approved.)



ASSESSMENT AND TAXATION

REAL PROPERTY TAXES

2005 assessed valuations are shown below. Description refers to the dollar value assigned to “land” property by the county assessor.

Real property in Cass County is classified in one of five land-use categories; agricultural, construction, public building, single family and undeveloped. Even though a parcel is placed in one of these categories it may have more than one classification if its total size is more than 10 acres. For example, on a twelve-acre parcel a single family residence sits on one acre and the remaining eleven are used for agricultural purposes. Within that one parcel one acre would be valued at the residential rate and the remaining nine would be valued at the agricultural rate. The parcel would subsequently be categorized as agricultural. A similar nine acre parcel with a single family home on one acre and the remaining eight used for agriculture would be categorized as residential with one acre being valued at the residential rate and the remaining eight acres being valued at the agricultural rate.

AREA # 1

Total Number of Parcels = 232

ASSESSED VALUE

<i>Land-Use Type</i>	<i>Number of Parcels</i>	<i>Residential Use</i>	<i>Agricultural Use</i>	<i>Commercial Use</i>	<i>Totals</i>
Agriculture	10	\$38,490.00	\$247,510.00	\$0.00	\$286,000.00
Construction	20	\$154,680.00	\$0.00	\$0.00	\$154,680.00
Public Building	1	\$0.00	\$0.00	\$0.00	\$0.00
Single Family	186	\$3,344,500.00	\$2,460.00	\$0.00	\$3,346,960.00
Undeveloped	15	\$117,100.00	\$0.00	\$0.00	\$117,100.00
Totals	232	\$3,654,770.00	\$249,970.00	\$0.00	\$3,904,740.00

APPROXIMATE REAL PROPERTY TAX REVENUES TO CITY IF ANNEXED

<i>Fund</i>	<i>Rate</i>	<i>Revenue</i>
General Operating	0.4647	18,145
Debt Service	0.7170	27,997
Parks	0.1251	4,885
Total	1.3068	51,027

AREA # 2

Total Number of Parcels = 354

**CITY OF RAYMORE
 PLAN OF INTENT**



ASSESSED VALUE

<i>Land-Use Type</i>	<i>Number of Parcels</i>	<i>Residential Use</i>	<i>Agricultural Use</i>	<i>Commercial Use</i>	<i>Totals</i>
Agriculture	47	\$351,280.00	\$492,210.00	\$38,700.00	\$882,190.00
Construction	33	\$263,570.00	\$0.00	\$0.00	263,570.00
Commercial	4	\$0.00	\$0.00	\$191,180.00	\$191,180.00
Single Family	268	\$4,519,370.00	\$59,600.00	\$21,600.00	\$4,600,570.00
Undeveloped	2	\$0.00	\$42,200.00	\$0.00	\$42,200.00
Totals	354	\$5,134,220.00	\$594,010.00	\$251,480.00	\$5,979,710.00

APPROXIMATE REAL PROPERTY TAX REVENUES TO CITY IF ANNEXED

<i>Fund</i>	<i>Rate</i>	<i>Revenue</i>
General Operating	0.4647	27,788
Debt Service	0.7170	42,875
Parks	0.1251	7,481
Total	1.3068	78,144

AREA # 3

Total Number of Parcels = 233

ASSESSED VALUE

<i>Land-Use Type</i>	<i>Number of Parcels</i>	<i>Residential Use</i>	<i>Agricultural Use</i>	<i>Commercial Use</i>	<i>Totals</i>
Agriculture	20	\$92,720.00	\$523,650.00	\$0.00	\$616,370.00
Construction	2	\$30,600.00	\$8,550.00	\$0.00	\$39,150.00
Commercial	2	\$0.00	\$0.00	\$50,830.00	\$50,830.00
Single Family	206	\$2,843,380.00	\$96,990.00	\$2,230.00	\$2,942,600.00
Undeveloped	3	\$0.00	\$10,240.00	\$0.00	\$10,240.00
Totals	233	\$2,966,700.00	\$639,430.00	\$53,060.00	\$3,659,190.00

APPROXIMATE REAL PROPERTY TAX REVENUES TO CITY IF ANNEXED

<i>Fund</i>	<i>Rate</i>	<i>Revenue</i>
General Operating	0.4647	17,004
Debt Service	0.7170	26,236
Parks	0.1251	4,578
Total	1.3068	47,818

**CITY OF RAYMORE
 PLAN OF INTENT**



APPROXIMATE REAL PROPERTY TAX REVENUES TO CITY IF ALL 3 AREAS ANNEXED

<i>Fund</i>	<i>Rate</i>	<i>Revenue</i>
General Operating	0.4647	62,937
Debt Service	0.7170	97,108
Parks	0.1251	16,944
Total	1.3068	176,989

If one or more of the three areas is annexed, property owners should expect approximately a 19% annual increase in their real property taxes.

PERSONAL PROPERTY TAXES

The following reflects 2005 assessed valuations.

Average valuation per statement for those located in Raymore - \$5,686.

Average valuation per statement for those located outside of Raymore in the two townships which encompass proposed Annexation Areas 1, 2 and 3 - \$8,845.

AREA # 1

Valuation (\$8,845) times the number of parcels (232) = \$2,052,040.00

<i>Fund</i>	<i>Rate</i>	<i>Revenue</i>
General Operating	0.4647	9,536
Debt Service	0.7170	14,713
Parks	0.1251	2,567
Total	1.3068	26,816

AREA # 2

Valuation (\$8,845) times the number of parcels (354) = \$3,131,130

<i>Fund</i>	<i>Rate</i>	<i>Revenue</i>
General Operating	0.4647	14,550
Debt Service	0.7170	22,450
Parks	0.1251	3,917
Total	1.3068	40,917

CITY OF RAYMORE
 PLAN OF INTENT



AREA # 3

Valuation (\$8,845) times the number of parcels (233) = \$2,060,885

<i>Fund</i>	<i>Rate</i>	<i>Revenue</i>
General Operating	0.4647	9,577
Debt Service	0.7170	14,777
Parks	0.1251	2,578
Total	1.3068	26,932

ALL 3 AREAS

<i>Fund</i>	<i>Rate</i>	<i>Revenue</i>
General Operating	0.4647	33,663
Debt Service	0.7170	51,940
Parks	0.1251	9,062
Total	1.3068	94,665

According to Cass County, the average personal property assessed valuation in the areas proposed for annexation is \$8,845. Based on this, an average resident in an area that is annexed would see a \$115.59 annual increase in their personal property taxes (the average personal property assessed valuation per household of \$8,845 times the Raymore tax levy of 1.3068).



REASONABLENESS AND NECESSITY OF ANNEXATION

The City of Raymore's Strategic plan outlines as one of its goals a desire to Develop an annexation plan and relate it to the Growth Management Plan and the Capital Improvement Plan.

According to the Growth Management Plan, "Raymore has transformed from a community happy to be growing to one that demands quality in all growth. The changing perspective also raises questions about where to grow and how to accommodate growth in a fiscally efficient manner." The plan goes on to say that annexation should be prioritized based on the availability of infrastructure and economic development potential and should be evaluated using a series of criteria. Those criteria and evaluation of them are as follows.

- Will annexation substantially increase Raymore's tax base or revenue producing ability?

Initially, City revenues would increase by \$115,480 in Area 1, \$174,985 in Area 2, and \$116,610 in Area 3 for a combined revenue increase of \$407,075. The potential for future revenue, however, is great. It is anticipated that a new interchange will be constructed at M-291 and Highway. 58. Such an interchange will likely bring commercial and/or industrial development and associated revenue important to providing quality city services.

- Is the annexation necessary to control short-term development in an area which is important to Raymore's long-term growth plans?

In recent years, some new subdivisions have been constructed that do not meet development requirements of the City of Raymore. When such areas are annexed, the associated issues with sub-par infrastructure will become an issue. If too many such developments occur, the cost to serve these areas will be more prohibitive.

In addition, the Raymore-Peculiar school district has purchased property for a significant campus. This will spur development in the area, which should be constructed to City standards and would benefit the citizens of Raymore.

- Are the annexation plans of adjacent communities threatening the long-term growth potential of Raymore?

Since the beginning of the year, the City of Raymore has been contacted by the cities of Lee's Summit and Lake Winnebago regarding their desires to annex some of the same land now being considered by the City of Raymore.

- Does the annexation add an area with short-term development potential which can be easily serviced by existing infrastructure?

There are areas on the fringe of the city that are suitable for development in the short-term that can be serviced by extension of existing infrastructure.

- Is land in Raymore's long-term growth area being inappropriately developed under county development regulations?

Several new subdivisions have been constructed in Cass County or adjacent to the areas under consideration. They are on septic systems; have poor water quality and pressure; and have substandard roads.



- Will the annexation overburden City resources?

If only Area No. 1 is annexed, it is estimated that \$210,200 in ongoing costs and \$99,000 in initial capital costs, for a total of \$309,200, will be required. If only Area No. 2 is annexed, \$212,700 and \$99,000, for total of \$311,700, respectively will be expended. If only Area No. 3 is annexed, \$214,100 and \$99,000, for a total of \$313,100, will be necessary.

If the entire area is annexed, \$335,000 in ongoing costs is estimated and \$135,000 in one time capital costs is estimated. **See chart on page 9.**

The City has sufficient fund balance in its General Fund to make up any operational shortfalls in the short term.

However, the annexation will not be effective for three years from the time of authorization. This time frame allows the City to prepare for the increased expenditures. It also provides the opportunity for additional growth in that area which in turn generates additional revenues.

Annexing each of the three areas would provide the following benefits to those in the areas under consideration:

- A safer environment because of increased police presence and responsiveness and emergency preparedness programs.
- Orderly development as a result of the City's progressive land-use and zoning policies.
- Enhanced health and safety due to Raymore's code that respects individual properties and preserves quality neighborhoods.
- Full participation in City of Raymore issues that affect the annexed areas because of their proximity to the City.

Current Raymore residents benefit from the vision of the annexation and the possibilities of the future. They include:

- Greater possibility for economic development and associated tax revenues to support City services.
- An ability to influence development around them.
- Securing the land for Raymore's future success rather than other communities' endeavors.
- A window of three to six years to plan and prepare for the increased growth and demand for services.

Consequences of not annexing these areas into the City of Raymore include:

- Growth and development will only occur with substandard infrastructure, including sanitary sewers, water service and roadway systems;
- Development that does occur could be non-contiguous separated by several acres and/or square miles of undeveloped land and be low density in nature. The provision of public services, then, is much more expensive.
- Development in these areas will affect the City of Raymore. If the areas are not annexed, the City foregoes its ability to control and manage that development.
- Other communities neighboring these areas could consequently annex them, enhancing their development potential, rather than Raymore's.

To ensure citizens of Raymore have a voice in the development that will ultimately surround them, have the benefit of increased economic development and tax revenues, and are not encroached by neighboring communities, annexing these three areas is reasonable and necessary.



RECOMMENDATION

At this time, the expenditures for ongoing costs necessary upon the effective date of annexation total \$335,000 should all of the areas be annexed. General fund revenues generated from the real and personal property tax levies, franchise fees and motor and gas taxes total \$232,021. The financial analysis, however, is just one part of the story. Many more issues should be taken into consideration in determining whether the City of Raymore should proceed.

In addition, the annexation provides:

- Greater possibility for economic development and associated tax revenues to support City services in the long term.
- An ability to influence development around the current corporate boundaries of the City.
- An ability to secure the land for Raymore's future success rather than other communities' endeavors.

Perhaps most importantly, annexation of these areas allows the City of Raymore to make significant progress towards many of its stated policies. First, annexation is contemplated in its primary goals, including promoting economic development to increase the tax base and provide jobs and developing an annexation plan related to the Growth Management Plan and the Capital Plan. As well, as has already been pointed out, annexation is discussed considerably in the City's Growth Management Plan (**See Attachment B**). That plan states: "The primary purpose of the program will be to protect the City's key interests." But the plan goes on to say that "annexation decisions must balance the problems of assuming short-term service costs against the long-term benefits." If approved, the City has three years in which to plan for these expenditures. As well, it is possible that additional development might have taken place, thereby further increasing the revenues.

For these reasons, it is recommended that the City of Raymore pursue annexation in each of the three areas.



EFFECTIVE DATE OF ANNEXATION

The effective date of annexation shall be three years after the date on which the approval of the annexation by the qualified voters in the City and the proposed annexation occurs; or, if a second vote is necessary, three years after the date on which approval of the annexation by the qualified voters of both the City and the proposed annexation area occurs



ATTACHMENT A

CITY OF RAYMORE



Strategic Goals

Goal 1. Promote economic development in the City to increase the tax base and provide jobs. Explore new and existing funding sources. Use all possible resources.

1. Develop the west side area. Seek retail outlets (e.g. anchor, small and large box businesses).
2. Develop Municipal Circle.
3. Identify potential sites for an industrial park. Seek funds for purchase of land. Follow the Growth Management Plan.
4. Rezone where needed to promote economic development, following the Growth Management Plan.
5. Protect current potential commercial areas.

Goal 2. Enhance communication by and about the City.

1. Establish a customer service protocol or program.
2. Establish a communication program to promote the City, both internally, e.g. to individuals and residential groups, and externally, e.g. to businesses and other governments.*
3. Establish programs and procedures to enhance employees' knowledge about the City and its programs and services.
4. Promote better teamwork by increasing interdepartmental communication and improving communication among Council, staff, boards and commissions.

Goal 3. Improve transportation and other infrastructure.

1. Expedite the U.S. 71 Interchange.
2. Provide improvements to arterials, e.g. Lucy Webb, Kentucky, Madison and Dean Avenue. Review and implement the ten-year road improvement plan.
3. Urge Cass County officials to improve School Road.
4. Develop a financial strategy to maintain and develop infrastructure.
5. Implement the four master plans (Transportation, Water, Sewer, Stormwater).
6. Complete infrastructure mapping.
7. Review priority of infrastructure improvements in the Original Town area.

Goal 4. Increase citizen involvement in City activities.

1. Increase number of citizens who volunteer for service on boards and commissions.
2. Initiate the development of a volunteer program, to include a volunteer coordinator.

Goal 5. Develop an annexation plan and relate it to the Growth Management Plan and the Capital Improvement Plan.

1. Identify annexation areas.
2. Relate the annually adopted CIP to annexation plans.
3. Identify costs and phases related to the Growth Management Plan.



Goal 6. Continue to improve and develop our parks and recreation programs.

1. Establish site and funding for a swimming pool.
2. Establish site and funding for a recreation center.
3. Establish site and funding for a second community park.
4. Continue the trail system to connect neighborhoods and provide safe and pleasant recreation.
5. Explore partnerships with youth organizations related to the Parks and Recreation systems and programs.

Goal 7. Develop a policy to manage growth.

1. Review density for residential use.
2. Enhance building code to assure durability of homes.

Goal 8. Improve partnership relationships with outside entities that affect Raymore (e.g. Cass County, Ray-Pec School District, Water Districts, South Metro Fire Protection District, Library District, MARC, etc.).

1. Maintain and enhance working relationships and communication.
2. Increase board and committee participation and representation.
3. Coordinate and cooperate on services, facilities and programs, procurement, and equipment.
4. Work closely on infrastructure issues such as road building and maintenance, transportation planning, water supply, and sewer building and maintenance.
5. Establish cooperative intergovernmental relationships regarding annexation and infrastructure.

Goal 9. Develop a storm water management plan.

1. Establish and implement a policy to identify additional flow within watershed caused by new or additional development.
2. Plan and establish retention areas to control and manage storm water when full growth is achieved.
3. Investigate a storm water utility program.

Goal 10. Develop a program that enhances staff and elected members' professional development.

1. Include development activities, particularly training.
2. Review evaluation processes for all parts of the process to include City Administrator, Council and Commission activities.
3. Provide proper professional recognition for performance excellence.



ATTACHMENT B

Appendix 1

Annexation

The 1995 Growth Management Plan indicated that, “Due to the large amount of undeveloped land in Raymore, the City can be less aggressive on the issue of annexation. In fact, additional annexations could further strain municipal resources.” Over the last nine years, the growth in the area leads the City to seriously consider an active annexation program. The primary purpose of the program will be to protect the City’s key interests within the current Annexation Plan of Intent area. The previous plan rightly stated this could strain City resources. The City needs a fully developed annexation strategy. The strategy should incorporate key areas to annex and the process by which the City would pursue voluntary annexation and review other municipalities involuntary strategies across the state to identify ways to involuntarily annex key areas, if necessary, without straining public resources.

Recommendation - Annexation

Further annexation should be evaluated using the following criteria:

- Will annexation substantially increase Raymore’s tax base or revenue producing ability;
- Is the annexation necessary to control short-term development in an area which is important to Raymore’s long-term growth plans (e.g., the Highway 291 corridor);
- Are the annexation plans of adjacent communities threatening the long-term growth potential of Raymore;
- Does the annexation add an area with short-term development potential which can be easily serviced by existing infrastructure;
- Is land in Raymore’s long-term growth area being inappropriately developed under County development regulations; and
- Will the annexation overburden City resources.

Annexation decisions must balance the problems of assuming short-term service costs against the long-term benefits. The annexation plan should be developed as the next step to the planning process.



ATTACHMENT C

BILL NO. 1969

ORDINANCE NO. _____

AN ORDINANCE AMENDING AND RESTATING BILL NO. 1943 PROVIDING FOR THE ANNEXATION OF UNINCORPORATED TERRITORY AND THE EXTENSION OF THE CORPORATE LIMITS OF THE CITY OF RAYMORE, ALL PURSUANT TO SECTION 71.015 OF THE REVISED STATUTES OF MISSOURI, AS AMENDED.

WHEREAS, on January 9, 2006, the City Council of the City of Raymore, Missouri introduced Bill No. 1943 as a proposed ordinance to annex property in Cass County, Missouri described therein as the "Annexation Area"; and

WHEREAS, Bill No. 1943 provided for a public hearing to be held on the proposed ordinance on July 17, 2006 at which time a "plan of intent" regarding the provision of municipal services would be presented; and

WHEREAS, since the introduction of Bill No. 1943, the City of Raymore has received numerous inquiries and requests from the citizens of the City and residents in the Annexation Area regarding the proposed annexation and the City's plan for the provision of municipal services to the Annexation Area if it is annexed; and

WHEREAS, in order to provide information and receive public input regarding the proposed annexation and the "plan of intent" for the provision of municipal services to the public at an earlier date, the City Council desires to amend and restate Bill No. 1943 to provide for a new public hearing date, and accordingly Bill No. 1943 is hereby amended and restated as follows:

WHEREAS, the City Council of the City of Raymore, Missouri (the "City") has determined that certain land located in the County of Cass is contiguous to the existing limits of the City and that the length of the contiguous boundary common to the existing City limit and the aforesaid area is at least fifteen percent of the length of the perimeter of the area (the "Initial Determination"); and



WHEREAS, upon making the Initial Determination, the City Council of Raymore declared by Resolution No. 06-04, adopted and approved on January 9, 2006 the City's intent to annex the Annexation Area (as hereinafter defined) into the City and the City Council of the City of Raymore now wishes to propose and adopt an ordinance so providing, all pursuant to and in compliance with the requirements of Section 71.015 of the Revised Statutes of Missouri, as amended (the "Annexation Statute").

NOW, THEREFORE, BE IT ORDAINED BY THE CITY COUNCIL OF THE CITY OF RAYMORE, MISSOURI, AS FOLLOWS:

Section 1. The corporate limits of the City shall, subject to: (i) the obtaining of a favorable vote by the requisite majority of registered voters in accordance with subdivision (6) of the Annexation Statute; and (ii) the obtaining from the Circuit Court of Cass County a declaratory judgment authorizing annexation in accordance with subdivision (5) of the Annexation Statute, be extended so as to include all that part of the County of Cass described and depicted in Exhibit "A", attached to and incorporated by reference in this Ordinance (the "Annexation Area").

Section 2. The City Council has found and determined, and hereby finds and determines that the perimeter of the Annexation Area is adjacent to the corporate limits and contiguous to the present corporate limits of the City of Raymore, Missouri, and that the perimeter of the Annexation Area is 38,197 feet and the length of the contiguous boundary common to the existing corporate limits of the City and the Annexation Area is 10,411 feet, which is equal to at least fifteen percent of the length of the perimeter of the Annexation Area, and, accordingly, the boundaries of the Annexation Area comply with and satisfy the condition precedent set forth in subdivision (1) of the Annexation Statute.

Section 3. The City Council of Raymore has found and determined, and hereby finds and determines that the proposed annexation of the Annexation Area is reasonable and necessary to the proper development of the City.

Section 4. The City of Raymore, Missouri has developed a "plan of intent" to provide services to the proposed Annexation Area on the same basis which services are presently provided to the residents of the City of Raymore.



Section 5 . Prior to the adoption of this Ordinance, a public hearing on this Ordinance and the annexation by the City of the Annexation Area shall have been fixed and held on the 15th day of May, 2006, in the City Council Chambers located at 100 Municipal Circle, Raymore, Missouri 64083 at which time the [plan of intent" and evidence in support thereof [including evidence relating to matters set forth in subdivisions (4)(a) through (e) of the Annexation Statute] was presented. Notice of the hearing shall have been given by publication in a newspaper of general circulation qualified to publish legal matters within the County of Cass at least once per week for three consecutive weeks, with at least one such notice being published not more than twenty days nor less than ten days before the hearing and a good faith effort shall be made to notify by certified mail deposited not less than thirty nor more than sixty days before the date of the hearing all fee owners of record within the Annexation Area.

Section 6. The annexation of the Annexation Area shall be effective thirty-six (36) months following the date of the last election conducted pursuant to subdivision (6) of the Annexation Statute and approving the annexation of the Annexation Area.

Section 7. *Severability.* The portions of this Ordinance shall be severable. In the event that any portion of this Ordinance is found by a court of competent jurisdiction to be invalid, the remaining portions of this Ordinance are valid, unless the court finds the valid portions of this Ordinance are so essential and inseparably connected with and dependent upon the void portion that it cannot be presumed that the City Council of Raymore, Missouri has enacted the valid portions within the invalid ones, or unless the court finds that the valid portions standing alone are incomplete and are incapable of being executed in accordance with the legislative intent.

Section 8. *Effective Date.* The effective date of approval shall be coincidental with the Mayor's signature and attestation by the City Clerk.

FIRST READING: January 9, 2006

FIRST READING AMENDING AND RESTATING: March 27, 2006

CITY OF RAYMORE
PLAN OF INTENT



BE IT REMEMBERED THE PRECEDING ORDINANCE WAS APPROVED AND ADOPTED THIS 27TH DAY OF MARCH, 2006, BY THE FOLLOWING VOTE:

Councilmember Adams	_____
Councilmember Eldridge	_____
Councilmember Goff	_____
Councilmember Hubach	_____
Councilmember Jacobson	_____
Councilmember Seimears	_____
Councilmember Van Hooser	_____
Councilmember Waite	_____

APPROVED:

ATTEST:

Juan Alonzo, Mayor

Susan Gnefkow, City Clerk



ATTACHMENT D

BILL NO. 1970

ORDINANCE NO. _____

AN ORDINANCE AMENDING AND RESTATING BILL NO. 1944 PROVIDING FOR THE ANNEXATION OF UNINCORPORATED TERRITORY AND THE EXTENSION OF THE CORPORATE LIMITS OF THE CITY OF RAYMORE, ALL PURSUANT TO SECTION 71.015 OF THE REVISED STATUTES OF MISSOURI, AS AMENDED.

WHEREAS, on January 9, 2006, the City Council of the City of Raymore, Missouri introduced Bill No. 1944 as a proposed ordinance to annex property in Cass County, Missouri described therein as the "Annexation Area"; and

WHEREAS, Bill No. 1944 provided for a public hearing to be held on the proposed ordinance on July 17, 2006 at which time a "plan of intent" regarding the provision of municipal services would be presented; and

WHEREAS, since the introduction of Bill No. 1944, the City of Raymore has received numerous inquiries and requests from the citizens of the City and residents in the Annexation Area regarding the proposed annexation and the City's plan for the provision of municipal services to the Annexation Area if it is annexed; and

WHEREAS, in order to provide information and receive public input regarding the proposed annexation and the "plan of intent" for the provision of municipal services to the public at an earlier date, the City Council desires to amend and restate Bill No. 1944 to provide for a new public hearing date, and accordingly Bill No. 1944 is hereby amended and restated as follows:

WHEREAS, the City Council of the City of Raymore, Missouri (the "City") has determined that certain land located in the County of Cass is contiguous to the existing limits of the City and that the length of the contiguous boundary common to the existing City limit and the aforesaid area is at least fifteen percent of the length of the perimeter of the area (the "Initial Determination"); and



WHEREAS, upon making the Initial Determination, the City Council of Raymore declared by Resolution No. 06-04, adopted and approved on January 9, 2006 the City's intent to annex the Annexation Area (as hereinafter defined) into the City and the City Council of the City of Raymore now wishes to propose and adopt an ordinance so providing, all pursuant to and in compliance with the requirements of Section 71.015 of the Revised Statutes of Missouri, as amended (the "Annexation Statute").

NOW, THEREFORE, BE IT ORDAINED BY THE CITY COUNCIL OF THE CITY OF RAYMORE, MISSOURI, AS FOLLOWS:

Section 1. The corporate limits of the City shall, subject to: (i) the obtaining of a favorable vote by the requisite majority of registered voters in accordance with subdivision (6) of the Annexation Statute; and (ii) the obtaining from the Circuit Court of Cass County a declaratory judgment authorizing annexation in accordance with subdivision (5) of the Annexation Statute, be extended so as to include all that part of the County of Cass described and depicted in Exhibit "A", attached to and incorporated by reference in this Ordinance (the "Annexation Area").

Section 2. The City Council has found and determined, and hereby finds and determines that the perimeter of the Annexation Area is adjacent to the corporate limits and contiguous to the present corporate limits of the City of Raymore, Missouri, and that the perimeter of the Annexation Area is 93,579 feet and the length of the contiguous boundary common to the existing corporate limits of the City and the Annexation Area is 42,835 feet, which is equal to at least fifteen percent of the length of the perimeter of the Annexation Area, and, accordingly, the boundaries of the Annexation Area comply with and satisfy the condition precedent set forth in subdivision (1) of the Annexation Statute.

Section 3. The City Council of Raymore has found and determined, and hereby finds and determines that the proposed annexation of the Annexation Area is reasonable and necessary to the proper development of the City.

Section 4. The City of Raymore, Missouri has developed a "plan of intent" to provide services to the proposed Annexation Area on the same basis which services are presently provided to the residents of the City of Raymore.



Section 5 . Prior to the adoption of this Ordinance, a public hearing on this Ordinance and the annexation by the City of the Annexation Area shall have been fixed and held on the 15th day of May, 2006, in the City Council Chambers located at 100 Municipal Circle, Raymore, Missouri 64083 at which time the [plan of intent" and evidence in support thereof [including evidence relating to matters set forth in subdivisions (4)(a) through (e) of the Annexation Statute] was presented. Notice of the hearing shall have been given by publication in a newspaper of general circulation qualified to publish legal matters within the County of Cass at least once per week for three consecutive weeks, with at least one such notice being published not more than twenty days nor less than ten days before the hearing and a good faith effort shall be made to notify by certified mail deposited not less than thirty nor more than sixty days before the date of the hearing all fee owners of record within the Annexation Area.

Section 6. The annexation of the Annexation Area shall be effective thirty-six (36) months following the date of the last election conducted pursuant to subdivision (6) of the Annexation Statute and approving the annexation of the Annexation Area.

Section 7. *Severability.* The portions of this Ordinance shall be severable. In the event that any portion of this Ordinance is found by a court of competent jurisdiction to be invalid, the remaining portions of this Ordinance are valid, unless the court finds the valid portions of this Ordinance are so essential and inseparably connected with and dependent upon the void portion that it cannot be presumed that the City Council of Raymore, Missouri has enacted the valid portions within the invalid ones, or unless the court finds that the valid portions standing alone are incomplete and are incapable of being executed in accordance with the legislative intent.

Section 8. *Effective Date.* The effective date of approval shall be coincidental with the Mayor's signature and attestation by the City Clerk.

FIRST READING: January 9, 2006

FIRST READING AMENDING AND RESTATING: March 27, 2006

CITY OF RAYMORE
PLAN OF INTENT



BE IT REMEMBERED THE PRECEDING ORDINANCE WAS APPROVED AND ADOPTED THIS 27TH DAY OF MARCH, 2006, BY THE FOLLOWING VOTE:

Councilmember Adams	_____
Councilmember Eldridge	_____
Councilmember Goff	_____
Councilmember Hubach	_____
Councilmember Jacobson	_____
Councilmember Seimears	_____
Councilmember Van Hooser	_____
Councilmember Waite	_____

APPROVED:

Juan Alonzo, Mayor

ATTEST:

Susan Gnefkow, City Clerk



ATTACHMENT E

BILL NO. 1971

ORDINANCE NO. _____

AN ORDINANCE AMENDING AND RESTATING BILL NO. 1945 PROVIDING FOR THE ANNEXATION OF UNINCORPORATED TERRITORY AND THE EXTENSION OF THE CORPORATE LIMITS OF THE CITY OF RAYMORE, ALL PURSUANT TO SECTION 71.015 OF THE REVISED STATUTES OF MISSOURI, AS AMENDED.

WHEREAS, on January 9, 2006, the City Council of the City of Raymore, Missouri introduced Bill No. 1945 as a proposed ordinance to annex property in Cass County, Missouri described therein as the "Annexation Area"; and

WHEREAS, Bill No. 1945 provided for a public hearing to be held on the proposed ordinance on July 17, 2006 at which time a "plan of intent" regarding the provision of municipal services would be presented; and

WHEREAS, since the introduction of Bill No. 1945, the City of Raymore has received numerous inquiries and requests from the citizens of the City and residents in the Annexation Area regarding the proposed annexation and the City's plan for the provision of municipal services to the Annexation Area if it is annexed; and

WHEREAS, in order to provide information and receive public input regarding the proposed annexation and the "plan of intent" for the provision of municipal services to the public at an earlier date, the City Council desires to amend and restate Bill No. 1945 to provide for a new public hearing date, and accordingly Bill No. 1945 is hereby amended and restated as follows:

WHEREAS, the City Council of the City of Raymore, Missouri (the "City") has determined that certain land located in the County of Cass is contiguous to the existing limits of the City and that the length of the contiguous boundary common to the existing City limit and the aforesaid area is at least fifteen percent of the length of the perimeter of the area (the "Initial Determination"); and



WHEREAS, upon making the Initial Determination, the City Council of Raymore declared by Resolution No. 06-04, adopted and approved on January 9, 2006 the City's intent to annex the Annexation Area (as hereinafter defined) into the City and the City Council of the City of Raymore now wishes to propose and adopt an ordinance so providing, all pursuant to and in compliance with the requirements of Section 71.015 of the Revised Statutes of Missouri, as amended (the "Annexation Statute").

NOW, THEREFORE, BE IT ORDAINED BY THE CITY COUNCIL OF THE CITY OF RAYMORE, MISSOURI, AS FOLLOWS:

Section 1. The corporate limits of the City shall, subject to: (i) the obtaining of a favorable vote by the requisite majority of registered voters in accordance with subdivision (6) of the Annexation Statute; and (ii) the obtaining from the Circuit Court of Cass County a declaratory judgment authorizing annexation in accordance with subdivision (5) of the Annexation Statute, be extended so as to include all that part of the County of Cass described and depicted in Exhibit "A", attached to and incorporated by reference in this Ordinance (the "Annexation Area").

Section 2. The City Council has found and determined, and hereby finds and determines that the perimeter of the Annexation Area is adjacent to the corporate limits and contiguous to the present corporate limits of the City of Raymore, Missouri, and that the perimeter of the Annexation Area is 58,329 feet and the length of the contiguous boundary common to the existing corporate limits of the City and the Annexation Area is 23,120 feet, which is equal to at least fifteen percent of the length of the perimeter of the Annexation Area, and, accordingly, the boundaries of the Annexation Area comply with and satisfy the condition precedent set forth in subdivision (1) of the Annexation Statute.

Section 3. The City Council of Raymore has found and determined, and hereby finds and determines that the proposed annexation of the Annexation Area is reasonable and necessary to the proper development of the City.

Section 4. The City of Raymore, Missouri has developed a "plan of intent" to provide services to the proposed Annexation Area on the same basis which services are presently provided to the residents of the City of Raymore.



Section 5. Prior to the adoption of this Ordinance, a public hearing on this Ordinance and the annexation by the City of the Annexation Area shall have been fixed and held on the 15th day of May, 2006, in the City Council Chambers located at 100 Municipal Circle, Raymore, Missouri 64083 at which time the “plan of intent” and evidence in support thereof [including evidence relating to matters set forth in subdivisions (4)(a) through (e) of the Annexation Statute] was presented. Notice of the hearing shall have been given by publication in a newspaper of general circulation qualified to publish legal matters within the County of Cass at least once per week for three consecutive weeks, with at least one such notice being published not more than twenty days nor less than ten days before the hearing and a good faith effort shall be made to notify by certified mail deposited not less than thirty nor more than sixty days before the date of the hearing all fee owners of record within the Annexation Area.

Section 6. The annexation of the Annexation Area shall be effective thirty-six (36) months following the date of the last election conducted pursuant to subdivision (6) of the Annexation Statute and approving the annexation of the Annexation Area.

Section 7. *Severability.* The portions of this Ordinance shall be severable. In the event that any portion of this Ordinance is found by a court of competent jurisdiction to be invalid, the remaining portions of this Ordinance are valid, unless the court finds the valid portions of this Ordinance are so essential and inseparably connected with and dependent upon the void portion that it cannot be presumed that the City Council of Raymore, Missouri has enacted the valid portions within the invalid ones, or unless the court finds that the valid portions standing alone are incomplete and are incapable of being executed in accordance with the legislative intent.

Section 8. *Effective Date.* The effective date of approval shall be coincidental with the Mayor’s signature and attestation by the City Clerk.

FIRST READING: January 9, 2006

FIRST READING AMENDING AND RESTATING: March 27, 2006

CITY OF RAYMORE
PLAN OF INTENT



BE IT REMEMBERED THE PRECEDING ORDINANCE WAS APPROVED AND ADOPTED THIS 27TH DAY OF MARCH, 2006, BY THE FOLLOWING VOTE:

Councilmember Adams	_____
Councilmember Eldridge	_____
Councilmember Goff	_____
Councilmember Hubach	_____
Councilmember Jacobson	_____
Councilmember Seimears	_____
Councilmember Van Hooser	_____
Councilmember Waite	_____

APPROVED:

ATTEST:

Juan Alonzo, Mayor

Susan Gnefkow, City Clerk



ATTACHMENT F

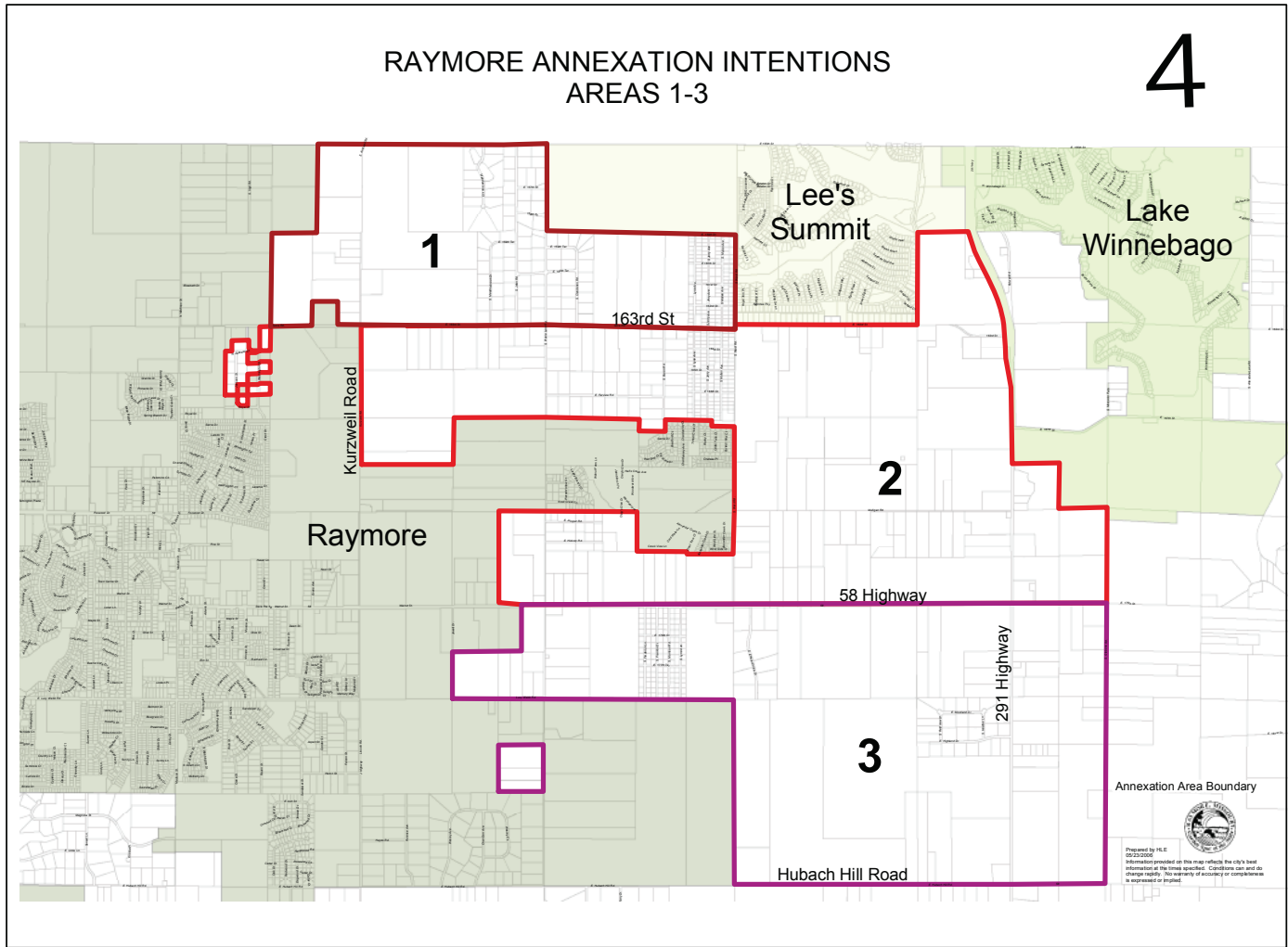



CITY OF RAYMORE PLAN OF INTENT

ATTACHMENT G

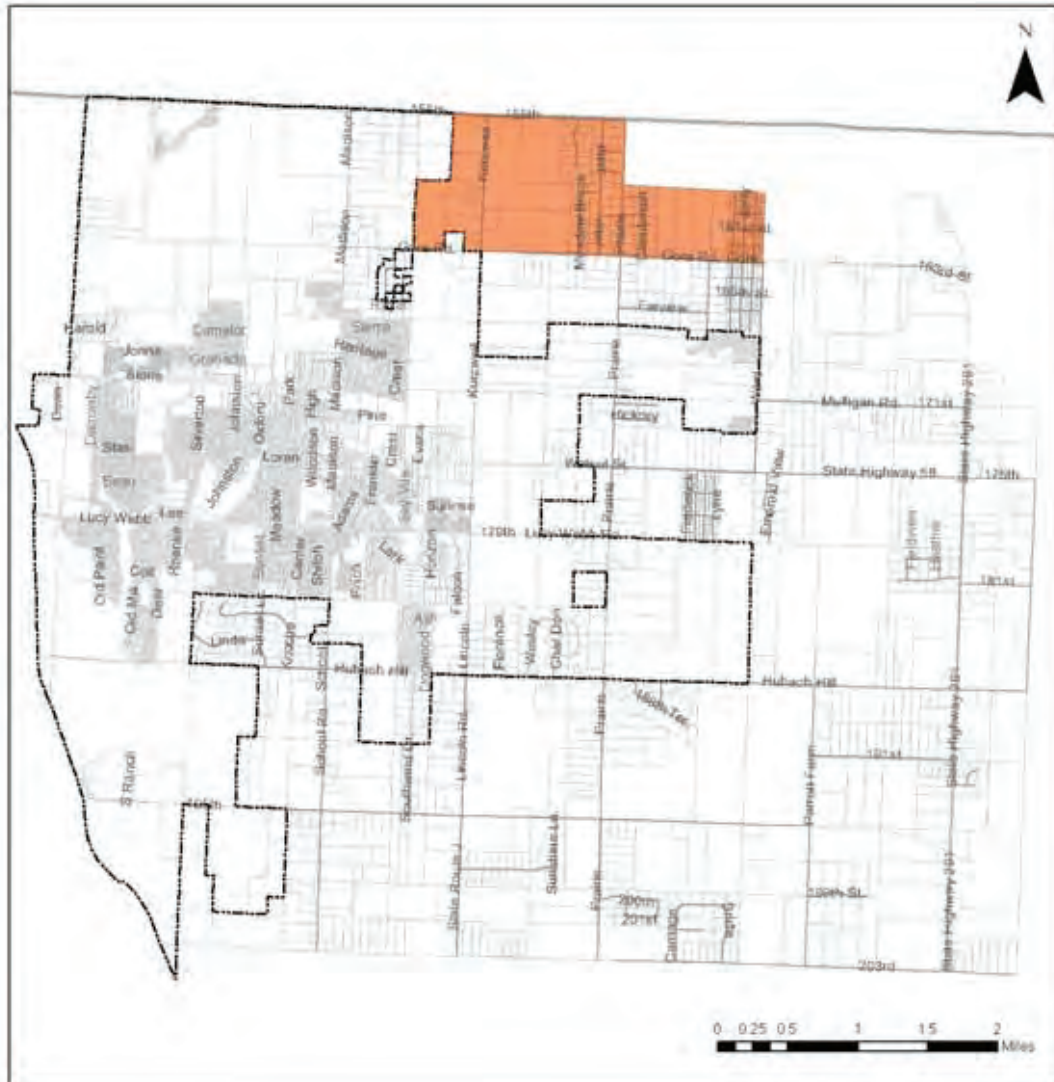

Legend

- Property Lines
- Strategic Area 1
- Raymore Corporate Limits
- Raymore Roads
- Roads
- Cass County



ATTACHMENT H

ANNEXATION
INTENTION
AREA #2

Total Perimeter Length = 93,051 LF
Length Coincident with Corporate Limits = 42,835.8 LF
Percentage of perimeter contiguous with
Corporate Limits = %46

4

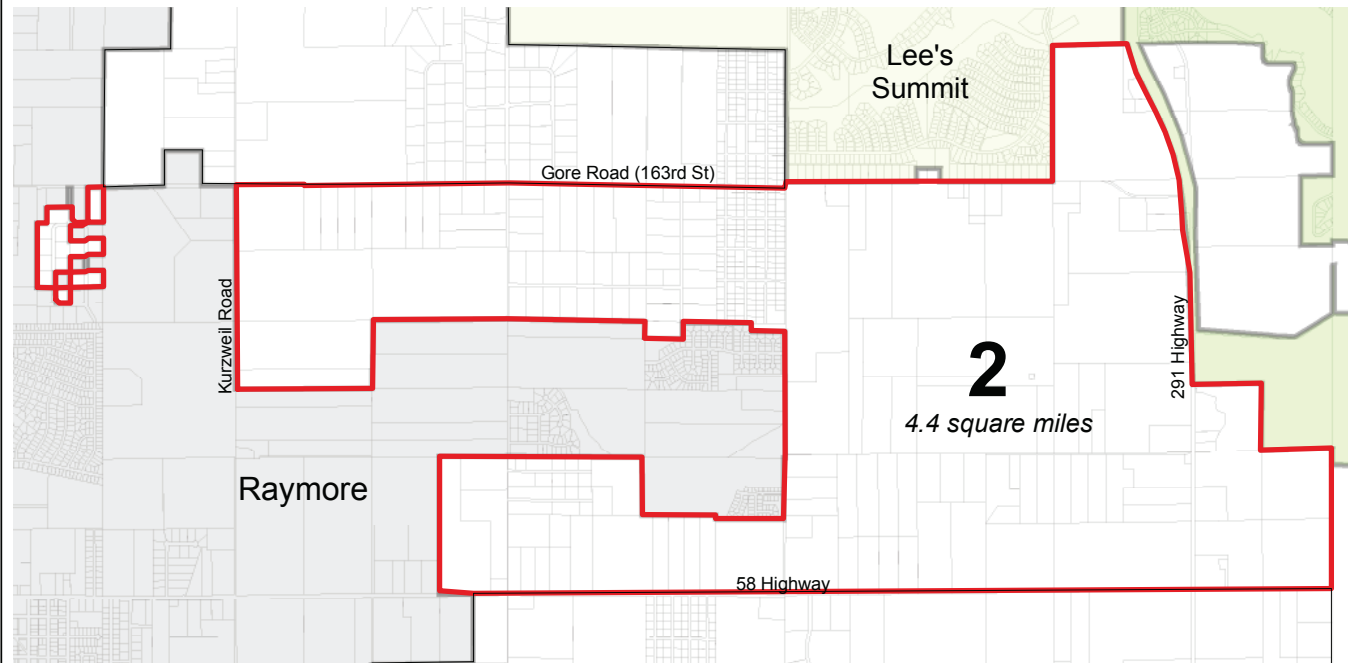



CITY OF RAYMORE PLAN OF INTENT

ATTACHMENT I

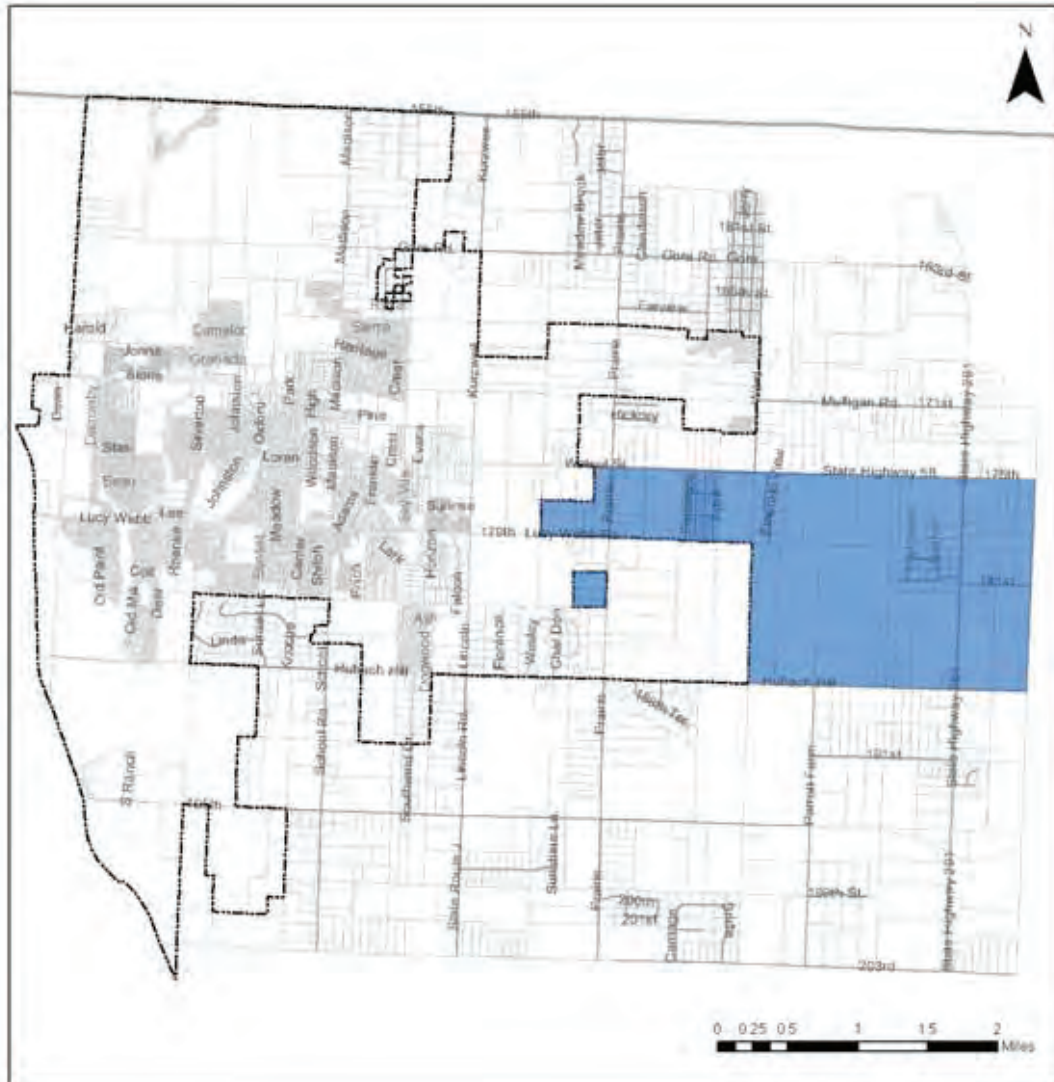

Legend

- Property Lines
- Strategic Area 3
- Raymore Corporate Limits
- Raymore Roads
- Roads
- Cass County



ATTACHMENT J

Costs to Provide Major Services

	Area 1*		Area 2*		Area 3*		Combined**	
	Operating	Capital	Operating	Capital	Operating	Capital	Operating	Capital
Administration Department	\$0	\$0	\$0	\$0	\$0	\$0	\$0	\$0
City Clerk's Office	\$0	\$0	\$0	\$0	\$0	\$0	\$0	\$0
Economic Development Department	\$0	\$0	\$0	\$0	\$0	\$0	\$0	\$0
Finance Department	\$0	\$0	\$0	\$0	\$0	\$0	\$0	\$0
Municipal Court	\$0	\$0	\$0	\$0	\$0	\$0	\$0	\$0
Parks and Recreation Department	\$0	\$0	\$0	\$0	\$0	\$0	\$0	\$0
Public Works Department								
Engineering Division	\$0	\$25,000	\$0	\$25,000	\$0	\$25,000	\$0	\$25,000
Street and Stormwater	\$69,200	\$50,000	\$71,700	\$50,000	\$73,100	\$50,000	\$194,000	\$50,000
Police Department	\$94,000	\$24,000	\$94,000	\$24,000	\$94,000	\$24,000	\$94,000	\$24,000
Emergency Management	\$0	\$0	\$0	\$0	\$0	\$0	\$0	\$36,000
Community Development Department	\$47,000	\$0	\$47,000	\$0	\$47,000	\$0	\$47,000	\$0
Total	\$210,200	\$99,000	\$212,700	\$99,000	\$214,100	\$99,000	\$335,000	\$135,000

*Operating costs for each of the individual areas assume one street maintenance worker, two police officers, a code enforcement officer and contributions to the vehicle replacement fund regardless of what area or combinations thereof are annexed. Differing street maintenance material costs account for the small variation. Capital costs include the sanitary sewer study revision, a police car and a street maintenance truck.

**Should all three areas be annexed, \$335,000 in annual on-going costs and \$135,000 in initial capital expenditures are estimated. These costs include an additional three street maintenance workers, two police officers, a code enforcement officer, street maintenance supplies and contributions to the vehicle replacement fund. Capital expenditures include a revision to the sanitary sewer master plan, a police car, a street maintenance truck and two emergency warning sirens.



CITY OF RAYMORE PLAN OF INTENT

ATTACHMENT K

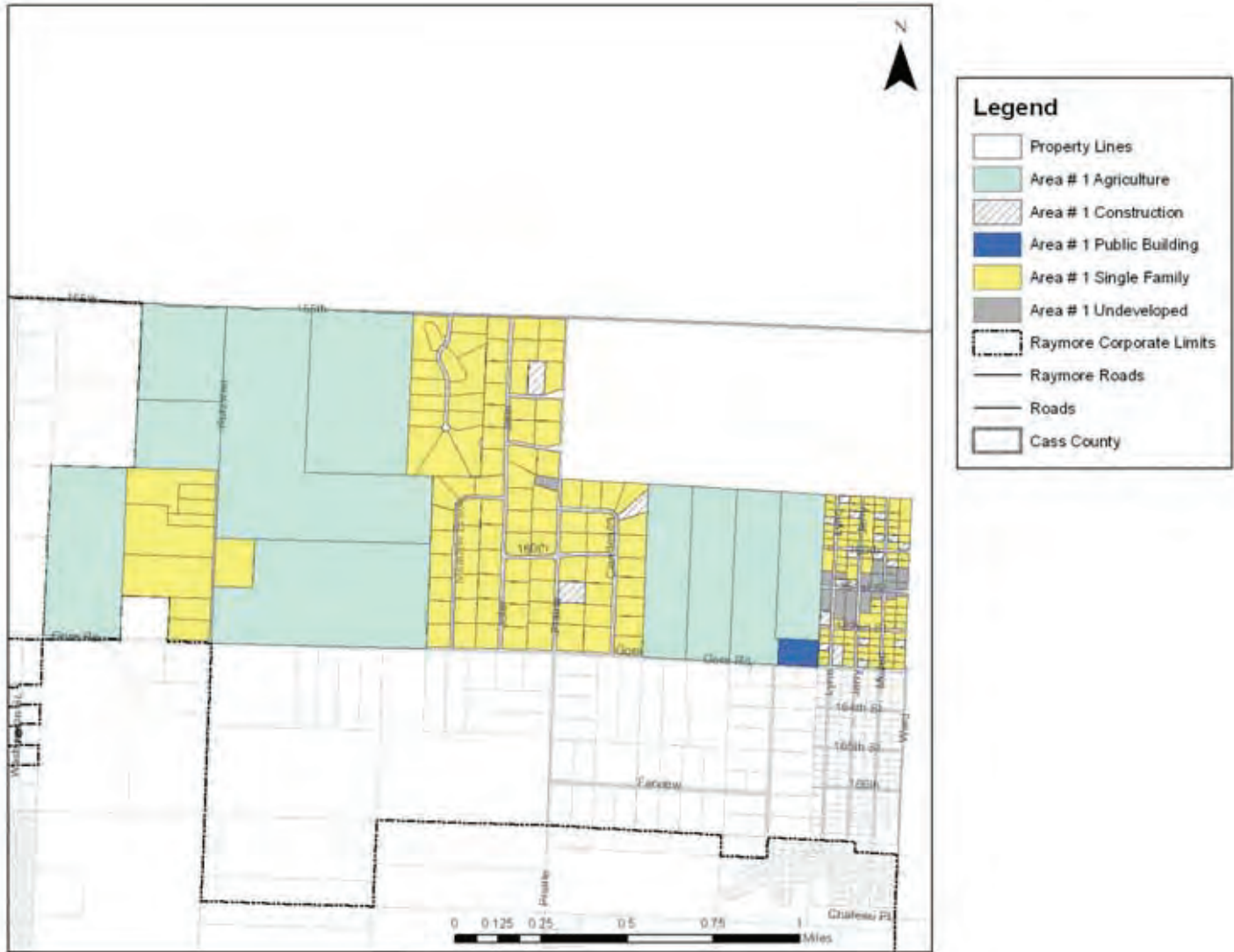



CITY OF RAYMORE PLAN OF INTENT

ATTACHMENT L





ATTACHMENT M





ATTACHMENT N

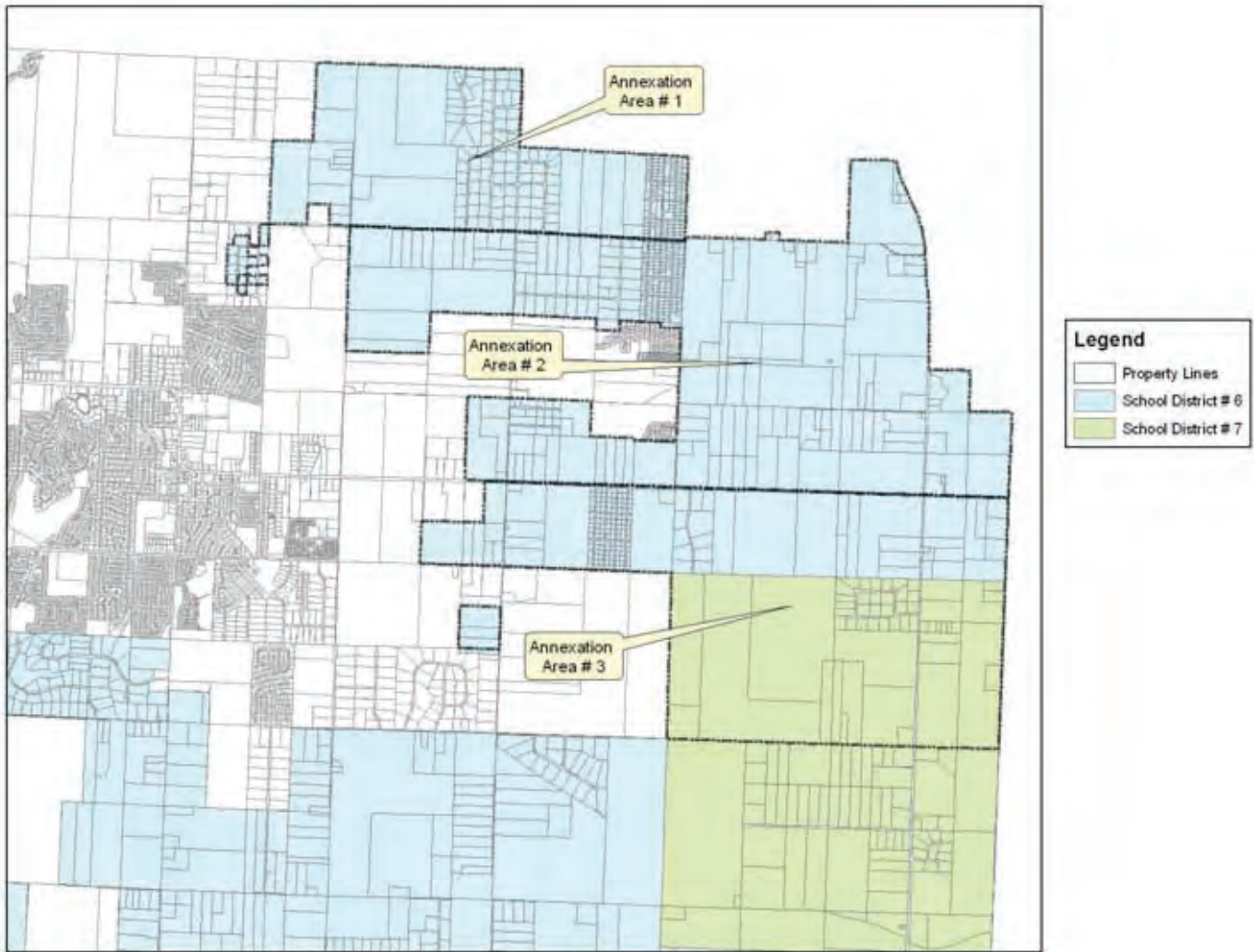

School District #6 - Raymore and Peculiar, Missouri

School District #7 - Pleasant Hill, Missouri

CITY OF RAYMORE
 PLAN OF INTENT



ATTACHMENT O

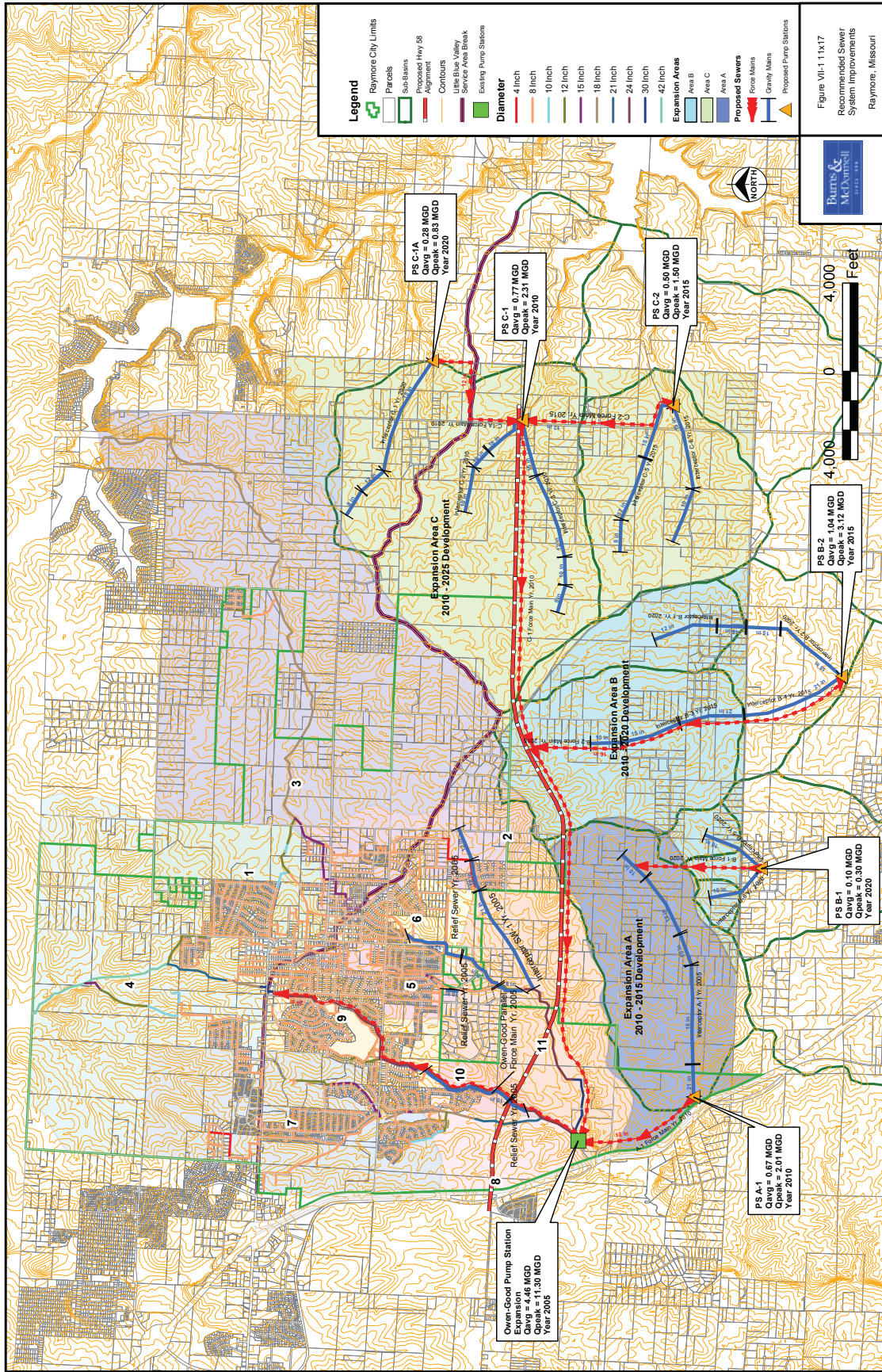



CITY OF RAYMORE PLAN OF INTENT

ATTACHMENT P

RAYMORE, MO OUTDOOR WARNING SIREN COVERAGE AREA MAP

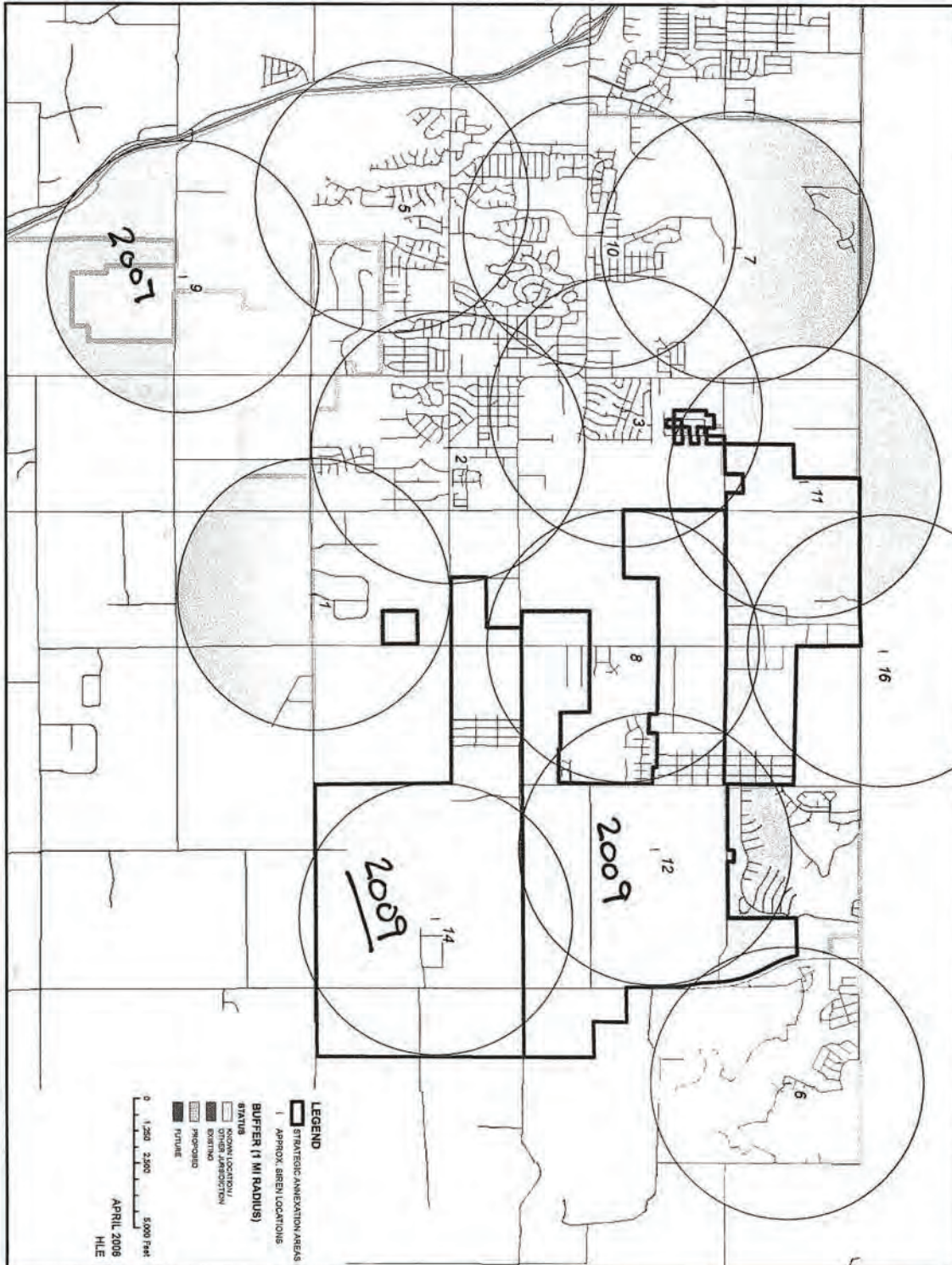



CITY OF RAYMORE
AGENDA ITEM INFORMATION FORM

DATE: March 11, 2019

SUBMITTED BY: Mike Krass

DEPARTMENT: Public Works

<input checked="" type="checkbox"/> Ordinance	<input type="checkbox"/> Resolution	<input type="checkbox"/> Presentation	<input type="checkbox"/> Public Hearing
<input checked="" type="checkbox"/> Agreement	<input type="checkbox"/> Discussion	<input type="checkbox"/> Other	

TITLE / ISSUE / REQUEST

Bill 3442 Approval of Municipal Circle Street Light Installation by Black & McDonald

STRATEGIC PLAN GOAL/STRATEGY

Goal 2.3 Improve Safety for all modes of travel throughout the community

FINANCIAL IMPACT

Award To:	Black & McDonald
Amount of Request/Contract:	\$29,740.44
Amount Budgeted:	\$50,000
Funding Source/Account#:	BERP (05)

PROJECT TIMELINE

Estimated Start Date	Estimated End Date
June 2019	July 2019

STAFF RECOMMENDATION

Approval

OTHER BOARDS & COMMISSIONS ASSIGNED

Name of Board or Commission:
Date:
Action/Vote:

LIST OF REFERENCE DOCUMENTS ATTACHED

Proposal

REVIEWED BY:

Jim Feuerborn

BACKGROUND / JUSTIFICATION

The FY 2019 Capital Budget provides funding to replace street lights along Skyline and Broadmoor Drive within the Municipal Complex.

The City currently utilizes Black & McDonald for streetlight maintenance and repairs throughout the City.

This contract includes the installation of street lights on a case-by-case basis. Staff requested a proposal for this work and received a quote in the amount of \$29,740.44.

Staff recommends award of this work to Black & McDonald under our current contract.

BILL 3442

ORDINANCE

“AN ORDINANCE OF THE CITY OF RAYMORE, MISSOURI, AUTHORIZING THE MAYOR AND CITY MANAGER TO ENTER INTO A CONTRACT WITH BLACK & MCDONALD FOR THE MUNICIPAL CIRCLE STREET LIGHT INSTALLATION PROJECT, IN THE AMOUNT OF \$29,740.44 AND AUTHORIZING THE CITY MANAGER TO APPROVE CHANGE ORDERS WITHIN ESTABLISHED BUDGET CONSTRAINTS.”

WHEREAS, the Municipal Circle Street Light Installation project was included in the 2019 capital budget; and

WHEREAS, the City has contracted with Black & McDonald for Street Light Work; and

WHEREAS, the contract includes provisions for the installation of new street lights on a case by case basis.

NOW, THEREFORE, BE IT ORDAINED BY THE COUNCIL OF THE CITY OF RAYMORE, MISSOURI, AS FOLLOWS:

Section 1. The City Manager is hereby directed and authorized to enter into a contract in the amount of \$29,740.44 with Black & McDonald, for the Municipal Circle Street Light Installation project.

Section 2. The City Manager and City Clerk are hereby authorized to execute the contract hereto as Exhibit A for and on behalf of the City of Raymore.

Section 3. The City Manager is authorized to approve change orders for this project within established budget constraints.

Section 4. Effective Date. The effective date of approval of this Ordinance shall be coincidental with the Mayor’s signature and attestation by the City Clerk.

Section 5. Severability. If any section, subsection, sentence, clause, phrase, or portion of this Ordinance is for any reason held invalid or unconstitutional by any court of competent jurisdiction, such portion shall be deemed a separate, distinct, and independent provision, and such holding shall not affect the validity of the remaining portions thereof.

DULY READ THE FIRST TIME THIS 11TH DAY OF MARCH, 2019.

BE IT REMEMBERED THAT THE ABOVE ORDINANCE WAS APPROVED AND ADOPTED THIS 25TH DAY OF MARCH, 2019, BY THE FOLLOWING VOTE:

Councilmember Abdelgawad
Councilmember Barber
Councilmember Berendzen
Councilmember Burke III
Councilmember Circo
Councilmember Holman
Councilmember Kellogg
Councilmember Townsend

ATTEST:

APPROVE:

Jean Woerner, City Clerk

Kristofer P. Turnbow, Mayor

Date of Signature



Black & McDonald

6001 Front Street, Kansas City, MO. 64120
 Phone: 816-483-0257 Fax: 816-483-2111

Proposal

SUBMITTED TO: CITY OF RAYMORE, MO	DATE: 02/06/2019
ATTENTION: MIKE KRASS	PHONE/FAX: 816-892-3022
ADDRESS: 100 MUNICIPAL CIRCLE	JOB NAME MUNICIPAL CIRCLE
CITY/STATE/ZIP: RAYMORE, MO	JOB LOCATION: 100 MUNICIPAL CIRCLE, RAYMORE, MO
SCOPE OF WORK TO BE PERFORMED: REPLACE (7) EXISTING SHEPHERD HOOK STYLE STREETLIGHT BASES, POLES AND HEADS AROUND MUNICIPAL CIRCLE. INSTALL (1) POLE, BASE AND HEAD TO REPLACE MISSING POLE ON MUNICIPAL CIRCLE.	
ALL MATERIALS INCLUDED PER CITY PLANS AND SPECIFICIATIONS. CITY APPROVAL AND SIGN OFF REQUIRED.	
<p>Exclusions and clarifications:</p> <ol style="list-style-type: none"> 1. Quote does not include sales tax. Taxes will be applied unless project is tax exempt and project tax exemption certificate is provided. 2. Any permits or fees are excluded. 3. Any major traffic control is excluded. 4. Sod Restoration. 5. Quote is valid for 30 days. 	
We propose to complete the project according to the plans for the sum of: Twenty-Nine Thousand, Seven Hundred-Forty Dollars and Forty-Four cents\$29,740.44	
Authorized Signature: <i>Jennifer L. Mathes</i>	
Acceptance of proposal:	Date:

New Business



CITY OF RAYMORE
AGENDA ITEM INFORMATION FORM

DATE: March 25, 2019

SUBMITTED BY: Mike Krass

DEPARTMENT: Public Works

<input checked="" type="checkbox"/> Ordinance	<input type="checkbox"/> Resolution	<input type="checkbox"/> Presentation	<input type="checkbox"/> Public Hearing
<input checked="" type="checkbox"/> Agreement	<input type="checkbox"/> Discussion	<input type="checkbox"/> Other	

TITLE / ISSUE / REQUEST

Bill 3444 Approval of Buckingham Ct. Street Light Installation by Black & McDonald

STRATEGIC PLAN GOAL/STRATEGY

Goal 2.3 Improve Safety for all modes of travel throughout the community

FINANCIAL IMPACT

Award To:	Black & McDonald
Amount of Request/Contract:	\$13,475
Amount Budgeted:	\$15,000
Funding Source/Account#:	Capital Improvement Fund (45)

PROJECT TIMELINE

Estimated Start Date	Estimated End Date
June 2019	July 2019

STAFF RECOMMENDATION

Approval

OTHER BOARDS & COMMISSIONS ASSIGNED

Name of Board or Commission:
Date:
Action/Vote:

LIST OF REFERENCE DOCUMENTS ATTACHED

Proposal

REVIEWED BY:

Jim Feuerborn

BACKGROUND / JUSTIFICATION

The FY 2019 Capital Budget provides funding for street light installation at locations that do not meet current lighting standards. This project will install street lights at the intersection of 163rd Street and Buckingham Court and the Creekmoor Clubhouse entrance.

The City currently utilizes Black & McDonald for streetlight maintenance and repairs throughout the City.

This contract includes the installation of street lights on a case-by-case basis. Staff requested a proposal for this work and received a quote in the amount of \$13,475.

Staff recommends award of this work to Black & McDonald under our current contract.

BILL 3444

ORDINANCE

“AN ORDINANCE OF THE CITY OF RAYMORE, MISSOURI, AUTHORIZING THE CITY MANAGER TO ENTER INTO A CONTRACT WITH BLACK & MCDONALD FOR THE BUCKINGHAM COURT STREET LIGHT INSTALLATION PROJECT, IN THE AMOUNT OF \$13,475 AND TO APPROVE CHANGE ORDERS WITHIN ESTABLISHED BUDGET CONSTRAINTS.”

WHEREAS, Street Light Installation was included in the 2018 capital budget; and

WHEREAS, Black & McDonald is contracted for on-call streetlight repairs and installations.

NOW, THEREFORE, BE IT ORDAINED BY THE COUNCIL OF THE CITY OF RAYMORE, MISSOURI, AS FOLLOWS:

Section 1. The City Manager is authorized to enter into a contract in the amount of \$13,475 with Black & McDonald, for the Buckingham Court Street Light Installation project.

Section 2. The City Manager and City Clerk are authorized to execute the contract, attached as Exhibit A, on behalf of the City of Raymore.

Section 3. The City Manager is authorized to approve change orders for this project within established budget constraints.

Section 4. Effective Date. The effective date of approval of this Ordinance shall be coincidental with the Mayor’s signature and attestation by the City Clerk.

Section 5. Severability. If any section, subsection, sentence, clause, phrase, or portion of this Ordinance is for any reason held invalid or unconstitutional by any court of competent jurisdiction, such portion shall be deemed a separate, distinct, and independent provision, and such holding shall not affect the validity of the remaining portions thereof.

DULY READ THE FIRST TIME THIS 25TH DAY OF MARCH, 2019.

BE IT REMEMBERED THAT THE ABOVE ORDINANCE WAS APPROVED AND ADOPTED THIS 8TH DAY OF APRIL, 2019, BY THE FOLLOWING VOTE:

Councilmember Abdelgawad
Councilmember Barber
Councilmember Berendzen
Councilmember Burke III
Councilmember Circo
Councilmember Holman
Councilmember Kellogg
Councilmember Townsend

ATTEST:

APPROVE:

Jean Woerner, City Clerk

Kristofer P. Turnbow, Mayor

Date of Signature



6001 Front Street, Kansas City, MO. 64120
 Phone: 816-483-0257 Fax: 816-483-2111

Proposal

SUBMITTED TO: CITY OF RAYMORE, MO	DATE: 03/07/2019
ATTENTION: GREG ROKOS	PHONE/FAX:
ADDRESS: 100 MUNICIPAL CIRCLE	JOB NAME MUNICIPAL CIRCLE
CITY/STATE/ZIP: RAYMORE, MO	JOB LOCATION: BUCKINGHAM CT & E 163 ST
ENGINEER/DATE OF PLANS: 03/07/2019	
SCOPE OF WORK TO BE PERFORMED: INSTALL TWO NEW POLES WITH 5' SCREW IN FOUNDATIONS, 6' BRACKET ARMS AND LED STREETLIGHT HEADS. BORE 640' OF 3#6 IN DUCT FROM EXISTING FEED AT POLE RM1372 TO NEW POLE AT COUNTRY CLUB DRIVE ENTRANE. INSTALL ONE 12X12 JUNCTION BOX MID SPAN OF NEW FEED.	
ALL MATERIALS INCLUDED PER CITY PLANS AND SPECIFICIATIONS.	
Exclusions and clarifications:	
<ol style="list-style-type: none"> 1. Quote does not include sales tax. Taxes will be applied unless project is tax exempt and project tax exemption certificate is provided. 2. Any permits or fees are excluded. 3. Any major traffic control is excluded. 4. Sod Restoration. 5. Quote is valid for 30 days. 6. Rock Clause: Prices are for good to fair ground. Boring of rock is not included and will be priced separately per foot. 7. KCP&L Connection fees are not included. 	
We propose to complete the project according to the plans for the sum of: Thirteen thousand, four hundred seventy-five dollars and zero cents.....\$ 13,475.00	
Authorized Signature: <i>Jennifer L. Mathes</i>	
Acceptance of proposal:	Date:

Miscellaneous

THE RAYMORE CITY COUNCIL HELD A WORK SESSION ON MONDAY, FEBRUARY 18, 2019, 7:00 P.M., AT RAYMORE CITY HALL. PRESENT: MAYOR TURNBOW, COUNCILMEMBERS ABDELGAWAD, BARBER, BERENDZEN, BURKE III, CIRCO, HOLMAN, KELLOGG, TOWNSEND. ALSO PRESENT: CITY MANAGER JIM FEUERBORN, CITY ATTORNEY JONATHAN ZERR, AND CITY STAFF MEMBERS.

Mayor Turnbow called the work session to order at 7:00 p.m.

A. Annexation Consultant

The City Council met with Bushyhead LLC to discuss the consultant's findings and recommendations concerning possible future intent to annex areas. Consultants recommended not annexing to the north due to other entities involved losing possible economic growth and opposition from residents. Councilmembers expressed the desire to annex an outlet between 155th Street and 150 Highway to develop a well-maintained access route from Raymore to 150 Highway. They discussed annexing to east and the requirements of annexation. Clarification was made identifying the areas discussed as an intended area of annexation, not as the definitive area of annexation.

Staff is preparing to bring forward an item voiding the current intent to annex area and plan of intent and bringing before the Council a new intent to annex area.

B. Other

The work session of the Raymore City Council adjourned at 7:35 p.m.