

**CITY OF RAYMORE**

100 Municipal Circle · Raymore, MO. 64083  
Phone · 816-892-3045 · Fax · 816-892-3093

**ADDENDUM NO. 1**

Public Works Interior Painting

Project #17-281-201

All plan holders are hereby notified and agree by signature below, that the bid includes consideration of the following changes, amendments, and/or clarifications and costs associated with these changes and are included in the bid.

**Addendum No. 1 - Clarification and addition of site map**

**1. Clarification:** Contractor is to move furniture and items away from walls in order to paint behind. City will remove any attached items from walls and secure computers. City will also clear items away from wall in large shop areas.

**2. Site Map - Green shaded areas are not part of the project.**

**3. Companies in attendance:**

Rio Contracting  
RL Phillips  
Dayco Painting  
Switzer & Associates

Any other questions regarding this proposal shall be submitted to Kim Quade, CPPB by e-mail at [kquade@raymore.com](mailto:kquade@raymore.com) or by phone at (816) 892-3045. There will be no questions allowed after October 27, 2017 at 5 p.m.

I hereby certify that the above have been considered and associated costs have been included in this bid.

Company Name: \_\_\_\_\_

By: \_\_\_\_\_

Title: \_\_\_\_\_

Address: \_\_\_\_\_

City, State, Zip: \_\_\_\_\_

Date: \_\_\_\_\_ Phone: \_\_\_\_\_

Signature of Bidder: \_\_\_\_\_

**ADDENDUM MUST BE SUBMITTED WITH BID**

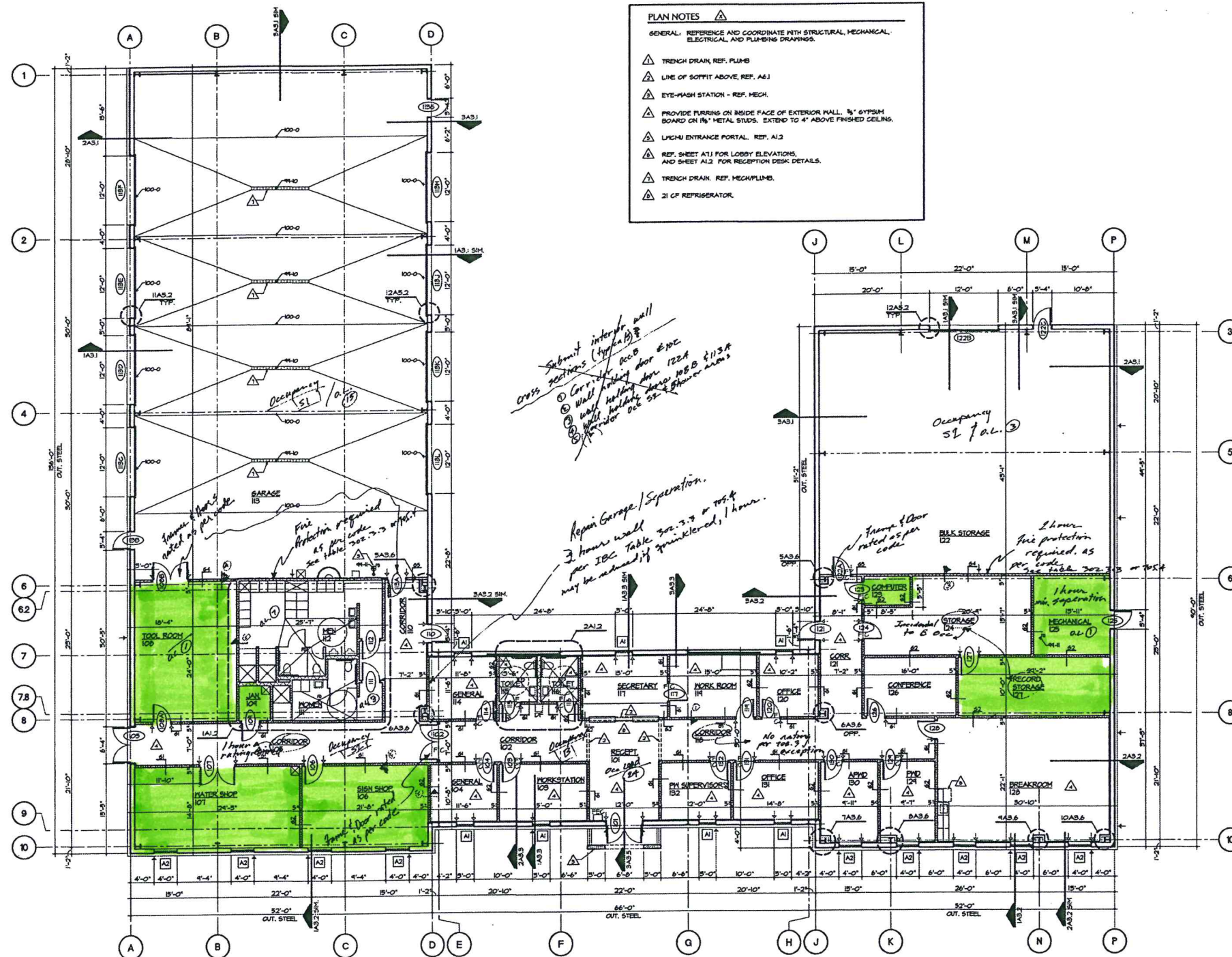

**PLAN NOTES** 

GENERAL: REFERENCE AND COORDINATE WITH STRUCTURAL, MECHANICAL, ELECTRICAL, AND PLUMBING DRAWINGS.

- △ TRENCH DRAIN, REF. PLUMB
- △ LINE OF SOFFIT ABOVE, REF. AS.1
- △ EYE-WASH STATION - REF. MECH.
- △ PROVIDE FURRING ON INSIDE FACE OF EXTERIOR WALL. 1/2" GYPSUM BOARD ON 1 1/2" METAL STUDS. EXTEND TO 4" ABOVE FINISHED CEILING.
- △ UCHU ENTRANCE PORTAL. REF. A1.2
- △ REF. SHEET A1.1 FOR LOBBY ELEVATIONS, AND SHEET A1.2 FOR RECEPTION DESK DETAILS.
- △ TRENCH DRAIN. REF. MECH/PLUMB.
- △ 21 CF REFRIGERATOR

~~Submittal interplay wall~~  
~~sections (typical)~~

Cross sections

- ① Corv. door 200 B \$300
- ② Wall holding door 122 A
- ③ Wall holding door 100 B & 113 A
- ④ Wall holding door 22 & 28 door area

Repair Garage / Separation.  
3 hour wall per IBC Table 302.3.3 or 302.4  
may be reduced, if sprinklered, 1 hour.

Occupancy  
52 / o.l. (3)

✓ frame & door  
rated as per  
code

1 hour  
fire protection  
received, as

1 hour  
min. separation  
15'-11"

A small detail of a green wall with a white border and a small white square.

RECORD  
STORAGE  
121

[illegible]

BREAKROOM  
126

2A9.2 2A9.2 SM

(N)



**PUBLIC WORKS - PLAN**  
1/8" = 1'-0"

**PUBLIC WORKS FACILITY**      **FOR**  
**CITY OF RAYMORE, MISSOURI**  

---

**CITY OF RAYMORE • 100 MUNICIPAL CIRCLE • RAYMORE, MO 64083**

Date  
■ DECEMBER 28, 2004

Revised Date:

Sheet Contents  
■ PUBLIC WORKS FLOOR PLAN

Project Number  
0 4 0 8 0 1

Sheet Number

## A1.1