

Angled parking
typical around the
Municipal Loop
meeting standards for
45 degree parking
and leaving a 12 ft.+
driving lane moving
counter clockwise.

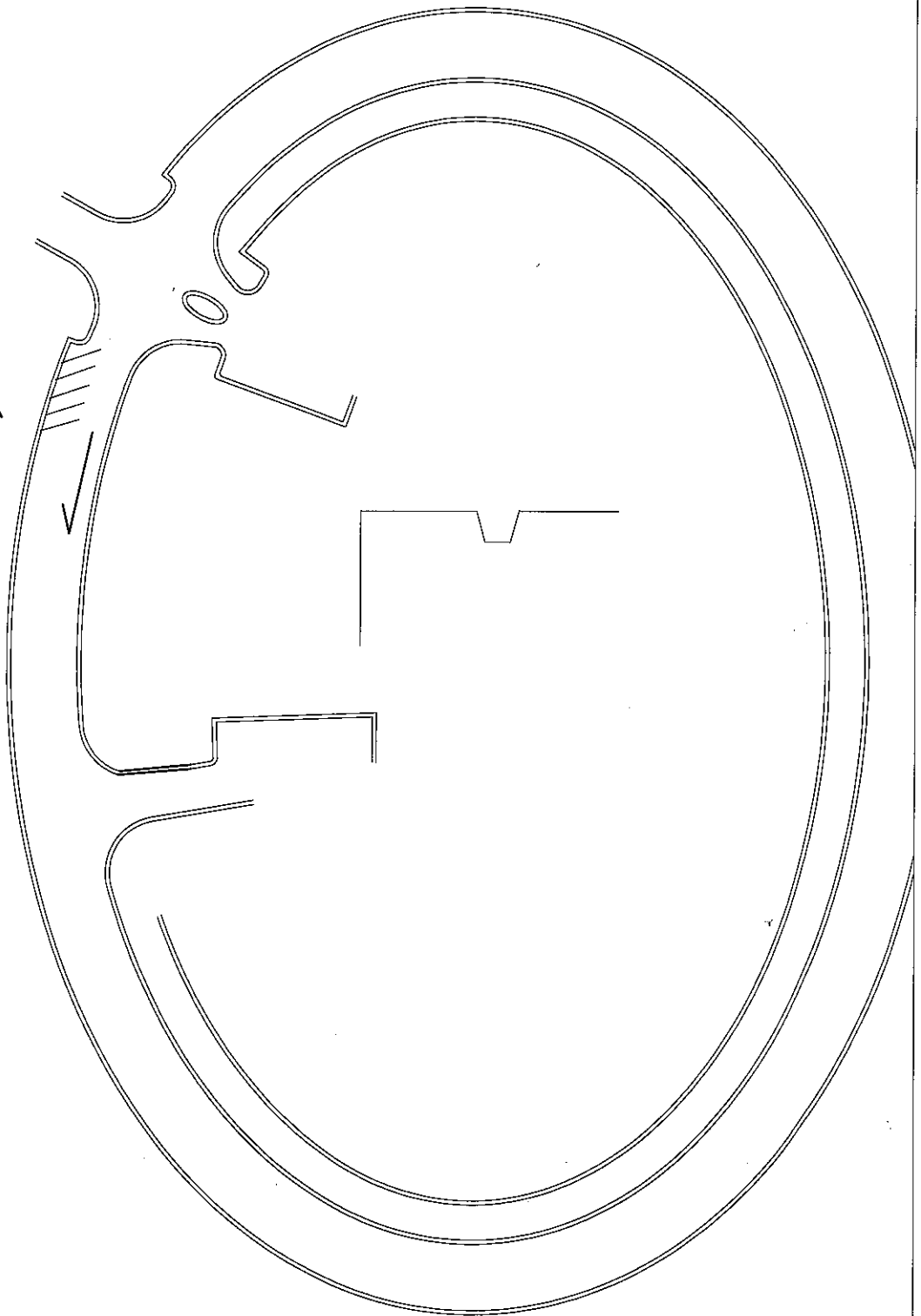

Notes:

1. Location is the southeast corner of the south City Hall parking lot.
2. Use the slab and V-bottom curb details on the Maple street parking plans and City Standard details for the high-back curb, modified by the addition of 3, #4 rebar.
3. Dowel the ADA ramps into the existing sidewalk and the new curb.
4. Line items costs shall include all demolition and disposal necessary to construct the improvements.

