



# City of Raymore

**100 Municipal Circle · Raymore, MO. 64083**

**Phone · 816-892-3045 · Fax · 816-892-3093**

## **ADDENDUM NO. 1**

### 2017 Concrete Projects: Project #17-008

All plan holders are hereby notified and agree by signature below, that the bid includes consideration of the following changes, amendments, and/or clarifications and costs associated with these changes and are included in the bid.

**Addendum No. 1 - Questions, clarifications, plan sheets and REVISED Bid form E with all projects included.**

**1. Question:** Will all projects be awarded?

**Response:** That will depend on budget for the department.

**2. Question:** Will projects be awarded to a single vendor?

**Response:** Yes

**Clarification:**

Project is to be bid using Prevailing Wage 24 not 23.

Testing on concrete is required. Concrete will be tested once a day unless the Project Manager directs otherwise; additional tests or none. Testing will consist of slump, air content and four cylinders; a 7 day break, two 28 day breaks and a reserve cylinder. The per unit price covers all costs associated with the field testing, lab testing and reporting of the results. See the revised bid tabs.

The Maple St Project is to be completed before September 1, 2017

Pre-Bid Attendees were:

Phoenix Concrete & Underground  
Freeman Concrete  
Terry Snelling Construction  
Breit Construction  
SB Wyatt - Orr Wyatt

## BID PROPOSAL FORM E – Project No. 17-008

### 1. Base Bid: Maple Street Parking (#270-201)

Bid Items	Units	Estimated Quantities	\$/Units	Total
Mobilization, Bonds and Insurance	Lump Sum	1		
Construction and Survey Controls	LS	1		
Grading	LS	1		
6 inch thick, concrete paving	Sq Yds	482		
Concrete Testing	Each	5		
V-bottom curb, reinforced	Lin Ft	295		
Wheel Stops	Each	24		
12 inch, CMP storm pipe	Lin Ft	335		
12 inch, CMP flared end section	Each	1		
East Storm Inlet	Each	1		
West Junction Box	Each	1		
Traffic Control	LS	1		
Erosion Control	LS	1		
Sidewalk	Sq Ft	1800		
ADA Ramp	Each	1		
Mail box relocation	Each	1		

### **Total Base Bid for Project Number: 270-201**

\$ \_\_\_\_\_

In blank above insert numbers for the sum of the bid.

\$ \_\_\_\_\_

In blank above write out the sum of the bid.

**Base Bid: Park Maintenance Facility (#271-201)**

Bid Items	Units	Estimated Quantities	\$/Units	Total
Mobilization, Bonds and Insurance	Lump Sum	1		
4" slab at Park Maintenance Building	sq feet	1166		
Concrete Testing	Each	1		

**Total Base Bid for Project Number: 271-201**

\$ \_\_\_\_\_

In blank above insert numbers for the sum of the bid.

\$ \_\_\_\_\_

In blank above write out the sum of the bid.

**3. Base Bid: Memorial Park Improvements (#273-201)**

Bid Items	Units	Estimated Quantities	\$/Units	Total
Mobilization, Bonds and Insurance	Lump Sum	1		
4" slabs at Memorial Park	sq feet	2300		
Sidewalk	Sq feet	300		
Concrete Testing	Each	2		

**Total Base Bid for Project Number: 273-201**

\$ \_\_\_\_\_

In blank above insert numbers for the sum of the bid.

\$ \_\_\_\_\_

In blank above write out the sum of the bid.

**4. Base Bid: Municipal Circle Sidewalk (#272-201)**

Bid Items	Units	Estimated Quantities	\$/Units	Total
Mobilization, Bonds and Insurance	Lump Sum	1		
7" wide sidewalk	sq feet	6405		
ADA Ramp Removal / Replacement	each	4		
Concrete Testing	Each	4		

**Total Base Bid for Project Number: 272-201**

\$ \_\_\_\_\_

In blank above insert numbers for the sum of the bid.

\$ \_\_\_\_\_

In blank above write out the sum of the bid.

**Grand Total Base Bid for all four (4) projects:**

\$ \_\_\_\_\_

In blank above insert numbers for the sum of the bid.

\$ \_\_\_\_\_

In blank above write out the sum of the bid.

**BID OF:** \_\_\_\_\_  
(Firm Name)

**DATE:** \_\_\_\_\_

Any other questions regarding this proposal shall be submitted to Kim Quade, CPPB by email at kquade@raymore.com or by phone at (816) 892-3045. There will be no questions allowed after May 19, 2017 at 5 p.m.

I hereby certify that the above have been considered and associated costs have been included in this bid.

Company Name: \_\_\_\_\_

By: \_\_\_\_\_

Title: \_\_\_\_\_

Address: \_\_\_\_\_

City, State, Zip: \_\_\_\_\_

Date: \_\_\_\_\_ Phone: \_\_\_\_\_

Signature of Bidder: \_\_\_\_\_

**ADDENDUM MUST BE SUBMITTED WITH BID**

# Maple Street Parking

Spring 2017

## The CITY of RAYMORE, MISSOURI

### Sheet Index:

- 1.....Cover Page
- 2.....Plan View
- 3.....Elevations
- 4.....Storm Sewer
- 5.....Details

### Utility Contact Information:

**KCP&L**  
Attention: Engineer  
215 Locust Belt Rd  
Belton, Missouri 64012  
800-303-0752

**AT&T**  
800-288-2020

**Comcast Cable**  
816-795-1100

**Missouri Gas Energy**  
3420 Broadway  
Kansas City, Missouri 64111  
816-756-5252  
Emergency 816-360-5023

**Dish Network**  
888-825-2557

**City of Raymore Water  
Utilities Department**  
100 Municipal Circle  
Raymore, MO 64083  
816-331-1852

**Utility Locates Required  
Before Any Excavation**  
1-800-Dig-Rite  
1-800-344-7483

### Project Description

- This project consists of the following:
1. Construction of two concrete slabs for 24, 60-degree parking stalls.
  2. Construct 295 feet of V-Bottom curb.
  3. Construct 360 linear feet of 5' wide sidewalk with an ADA ramp.
  4. Install 335 feet of 12" CMP with two storm sewer boxes.

The above list is not all inclusive. See plans for details and bid tab for line item quantities.

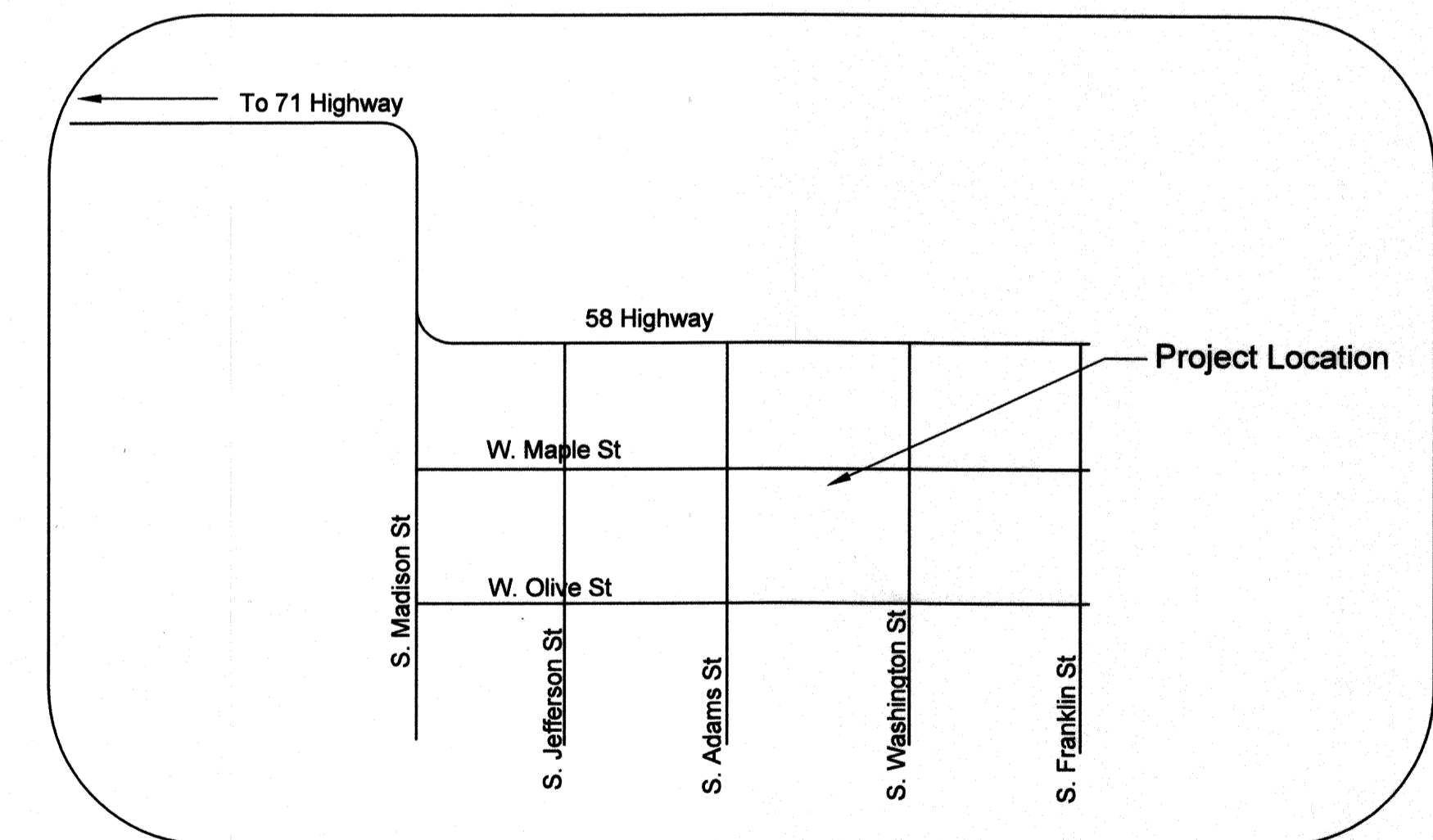

Project located on Maple Street between S. Adams and S. Washington

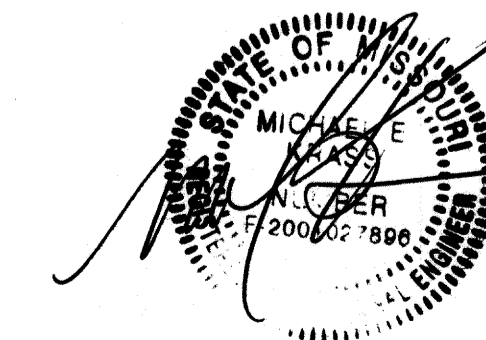

See page #3 for elevation benchmark

Page 1 of 5

Engineering Department  
City of Raymore  
100 Municipal Circle  
Raymore, MO 64083  
816-331-1852 Fax 816-331-8067

**City of Raymore**  
Project: Maple Street Parking  
Spring 2017

Contact Phil Becker at 816-868-6785  
or [jbecker@raymore.com](mailto:jbecker@raymore.com) for any questions  
concerning this project.

First Baptist Church

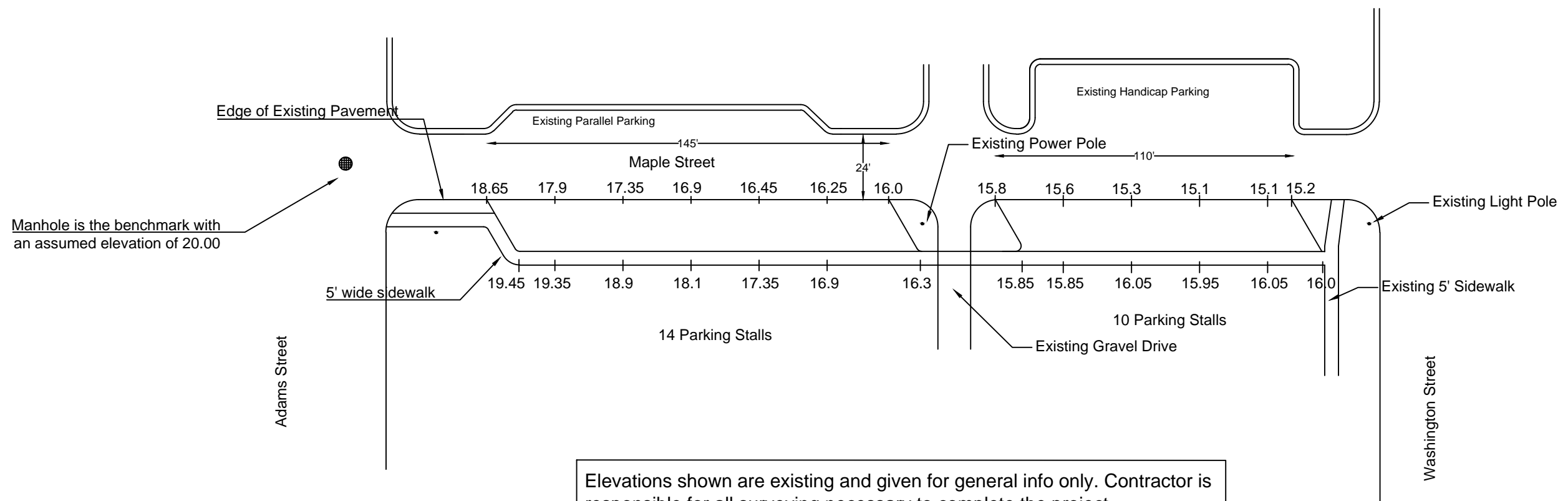

Manhole is the benchmark with an assumed elevation of 20.00

Edge of Existing Pavement

Existing Parallel Parking

Maple Street

Existing Handicap Parking

Existing Power Pole

Existing Light Pole

5' wide sidewalk

14 Parking Stalls

10 Parking Stalls

Existing Gravel Drive

Existing 5' Sidewalk

Adams Street

Washington Street

Elevations shown are existing and given for general info only. Contractor is responsible for all surveying necessary to complete the project.

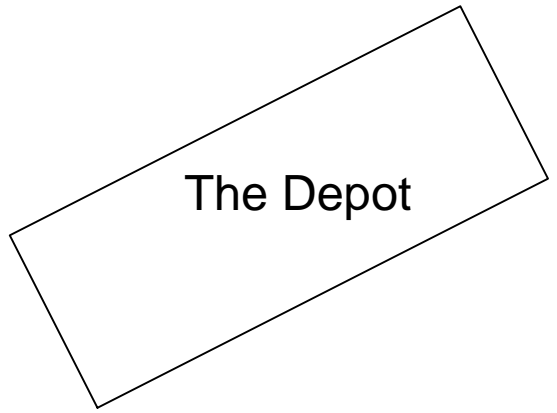

Scale: 1" = 20'

Proposed Maple St. Parking  
City of Raymore  
Spring 2017

# Maple Street Parking - Details

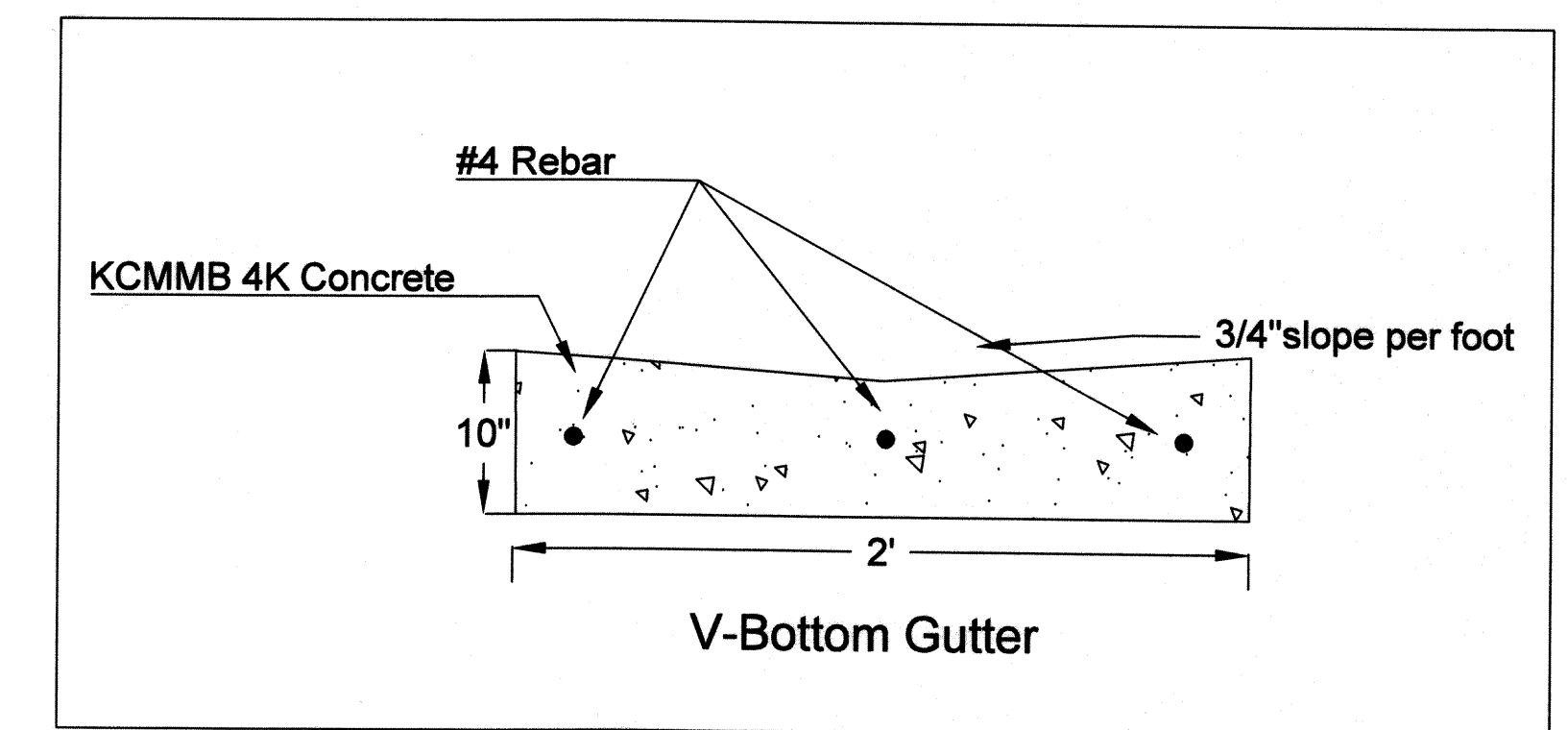
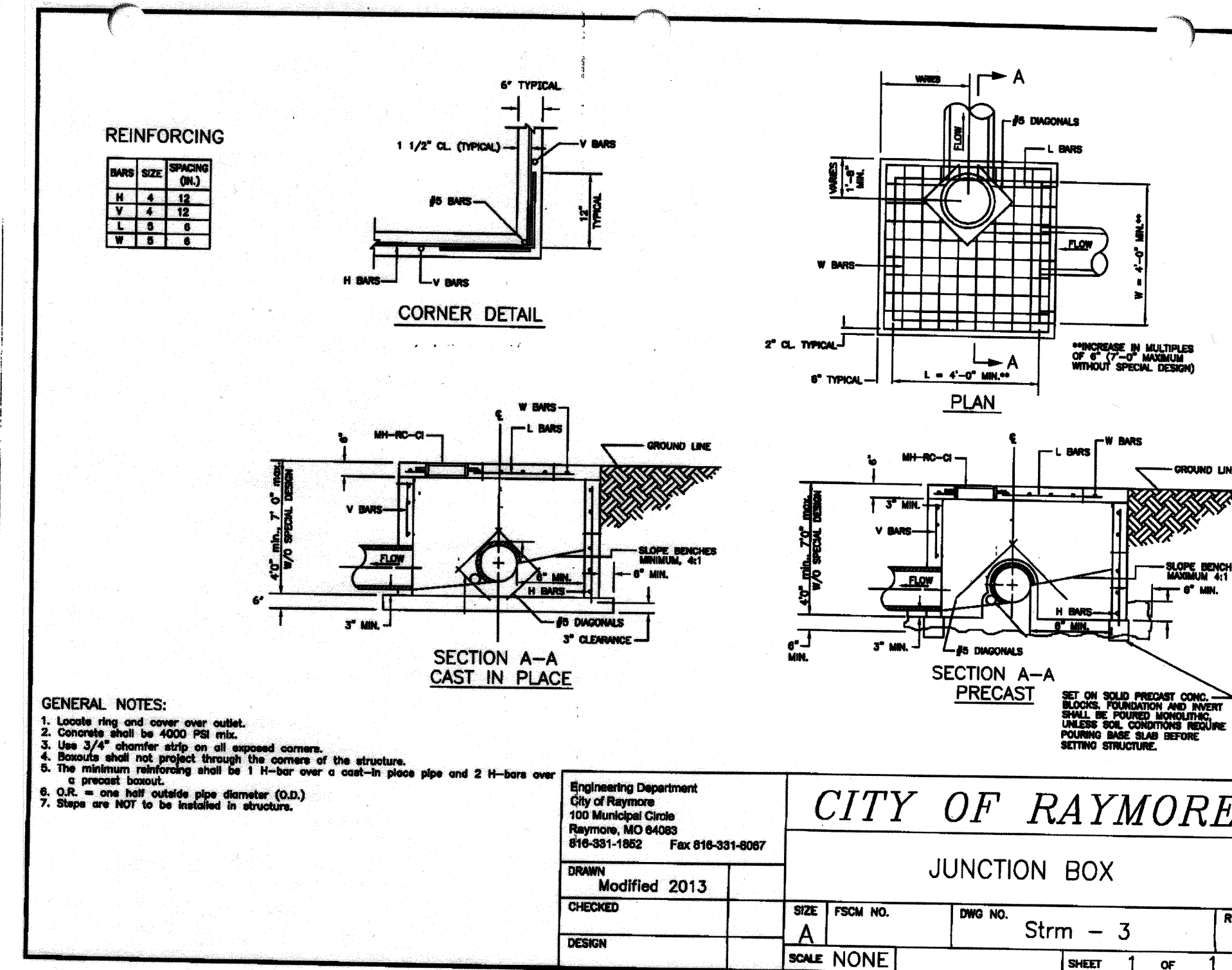
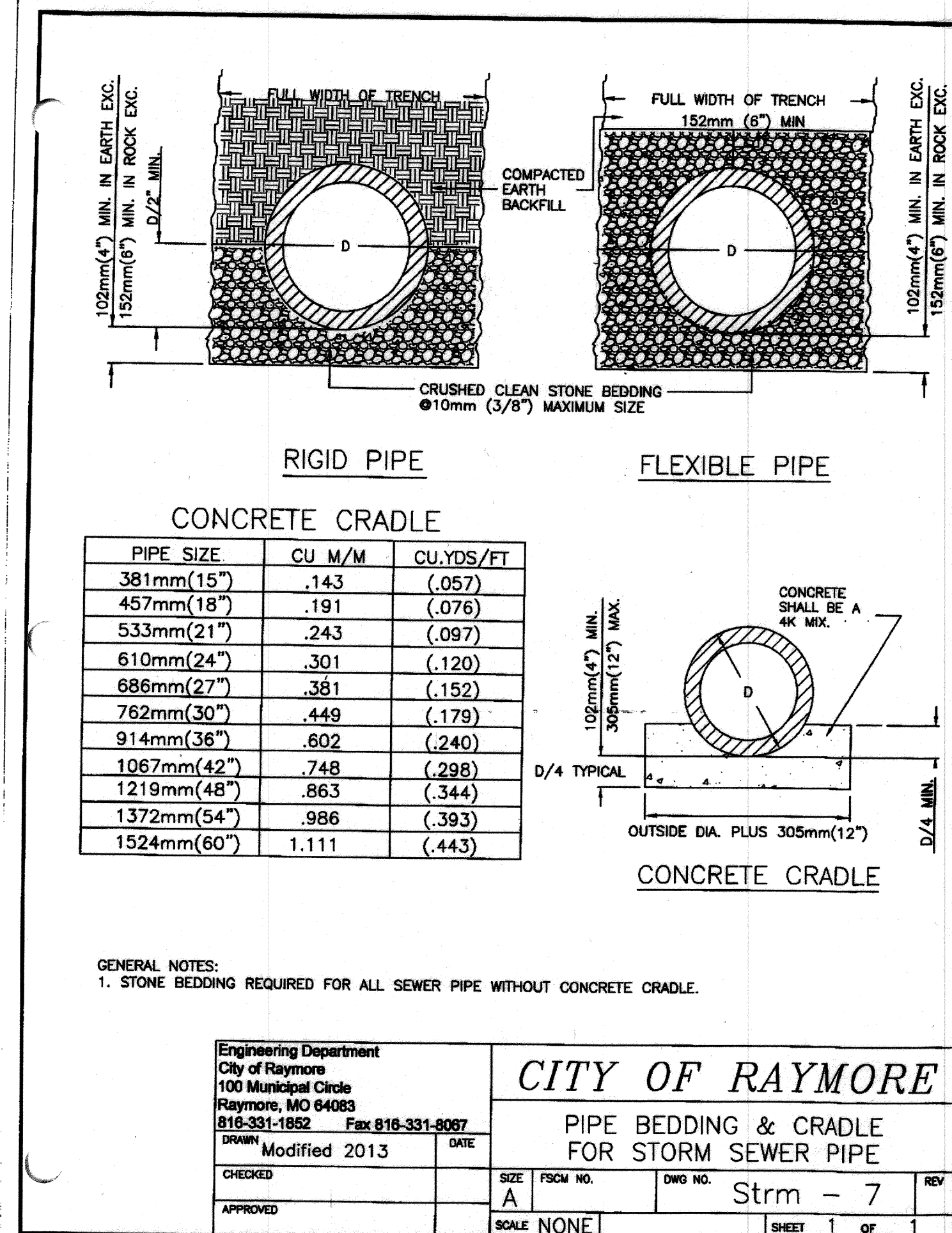
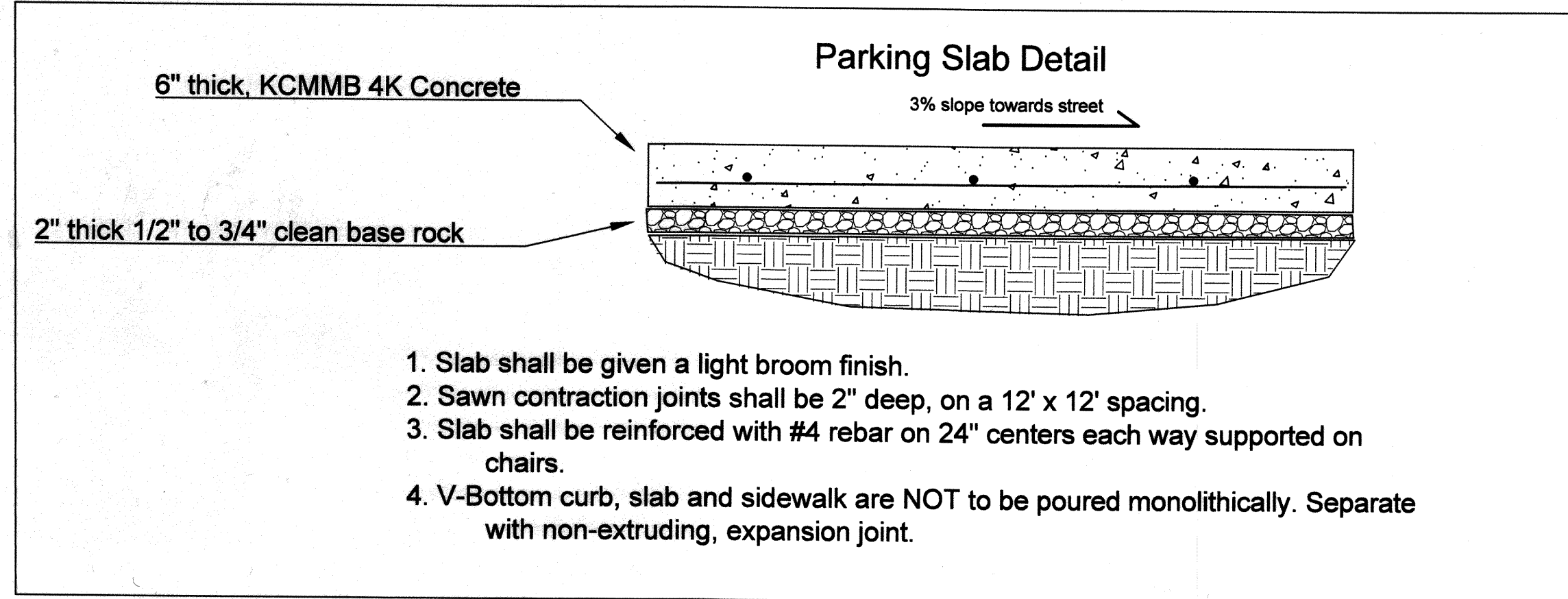



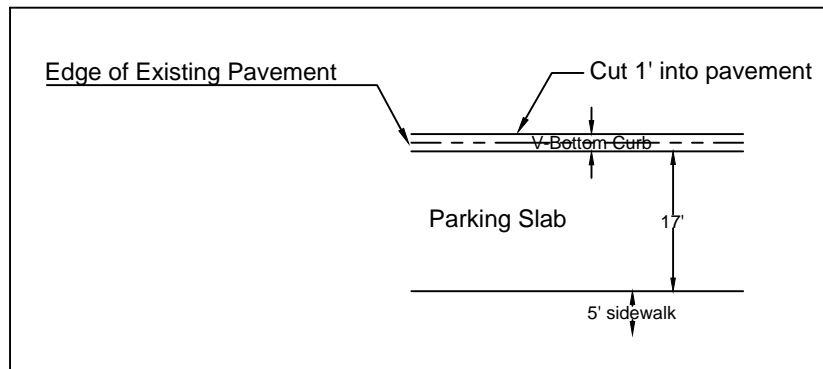
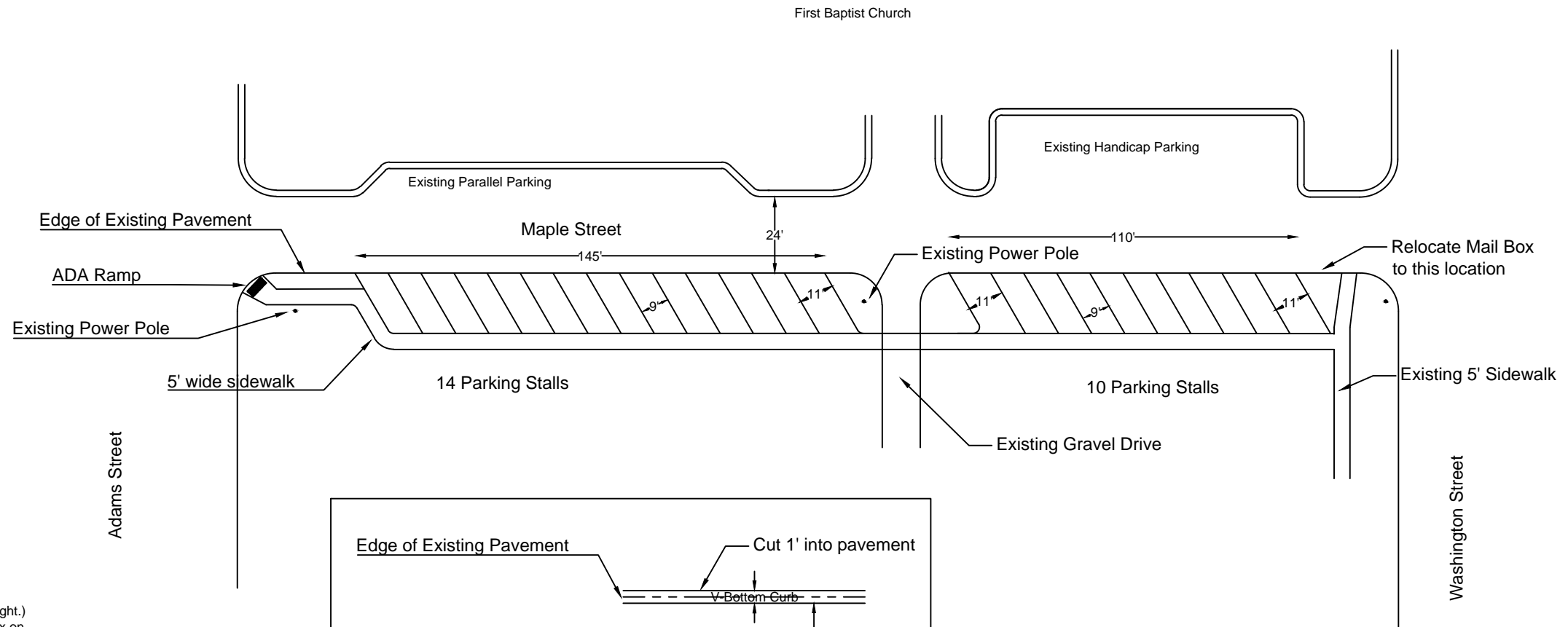

**NOTES:**

1. Saw cut existing pavement in a straight line one foot in from the current edge. (See detail to right.)
2. Dowel sidewalk into the lid of the storm sewer box on one foot centers.
3. V-Bottom curb shall extend thru the gravel drive. Joints are to be 2" deep and sawn at 10' intervals.
4. Use straw wattles where necessary to prevent sediment from leaving the site.
5. Stripe the stalls marked 11' at 9', leaving a two foot walking path.
6. The ADA ramp is to be 6" thick and the detectable warning surface is to ADA Solutions, Inc. brand tile or approved equal. Bricks are not allowed.
7. Sidewalk shall have a light broom finish, tooled joints and picture framed.

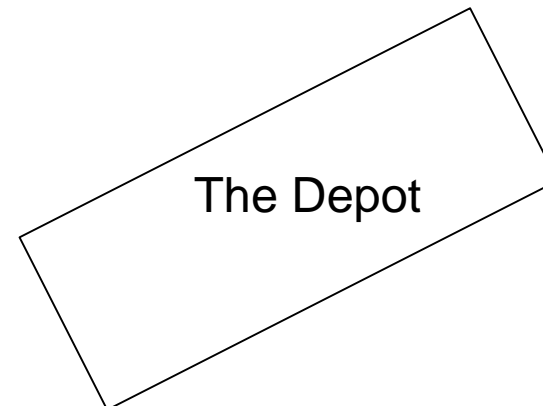
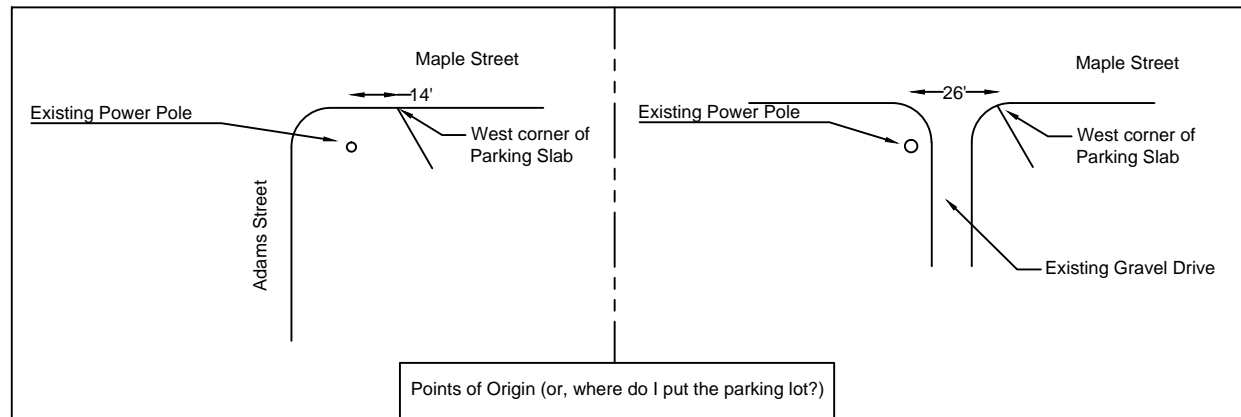

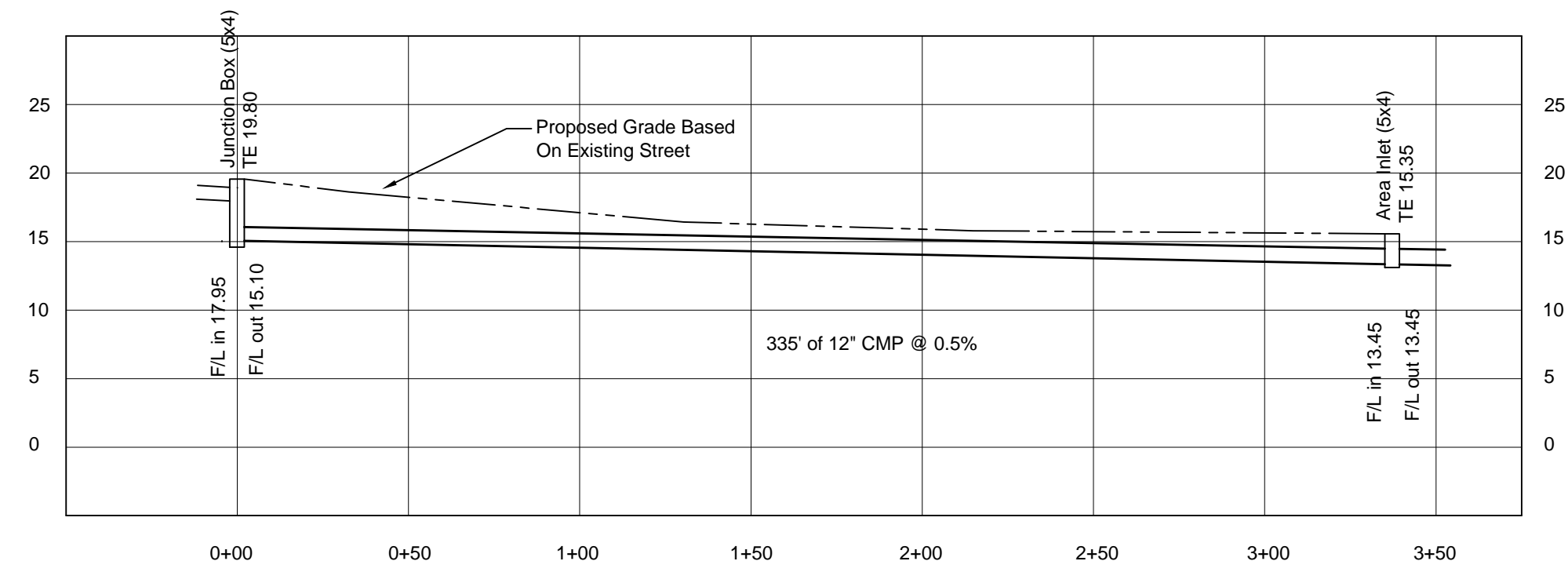
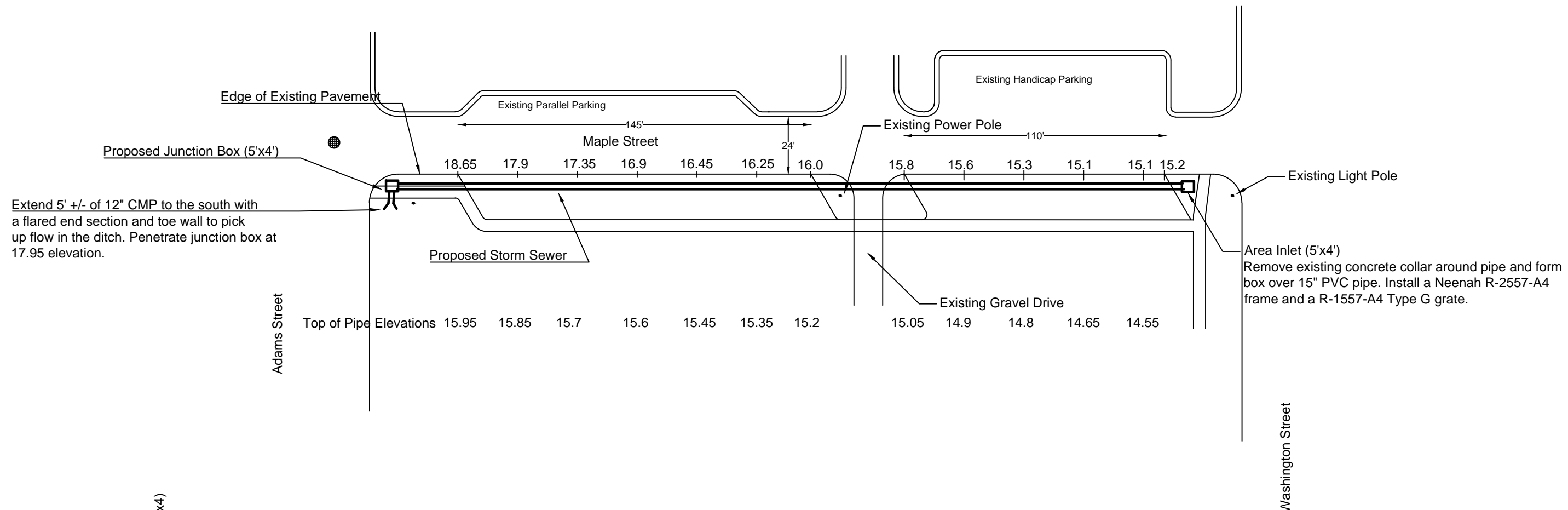

Memorial Park

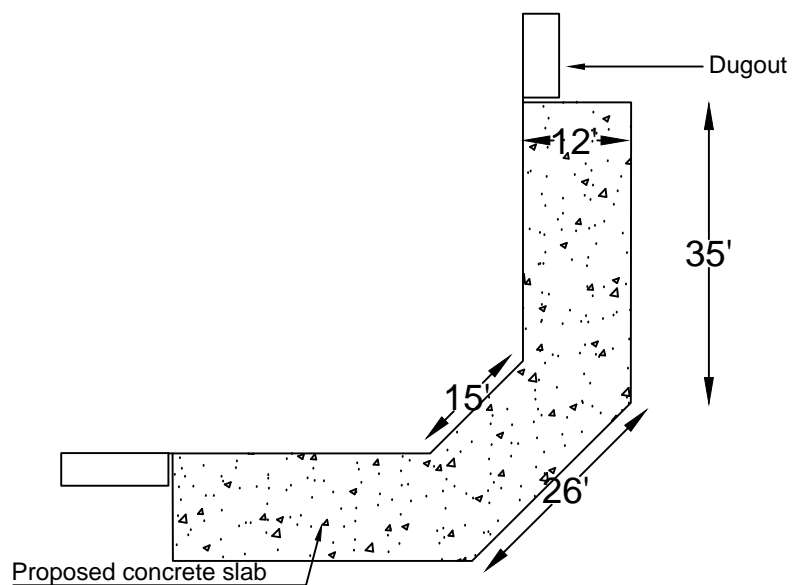

1. Dimensions are approximate. Final layout will be done in the field by the City. Payment is by square foot constructed.
2. Slab is KCMMB 4K mix, #4 rebar on 2 foot centers, on 4" of clean base rock.
3. This sketch is typical for both diamonds.

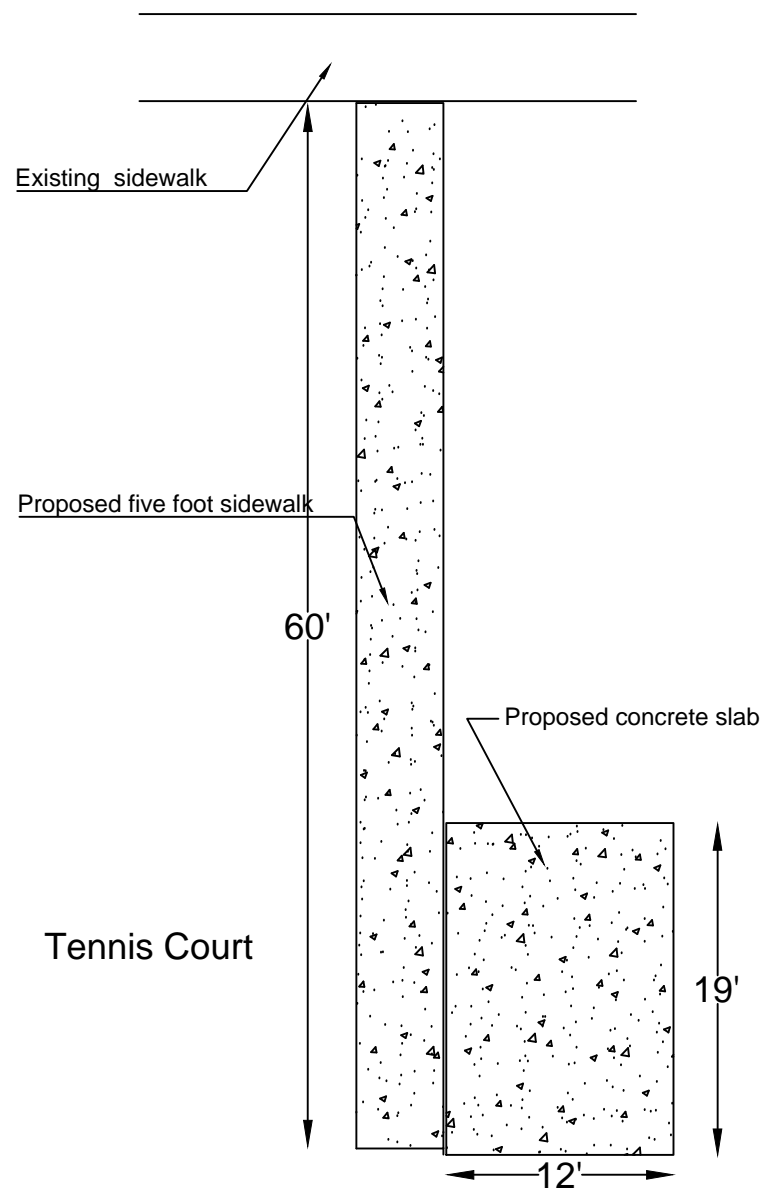

1. Dimensions are approximate. Final layout will be done in the field by the City. Payment is by square foot constructed.
2. Slab is KCMMB 4K mix, #4 rebar on 2 foot centers, on 4" of clean base rock.

Parks Maintenance Building at 909 S. Madison

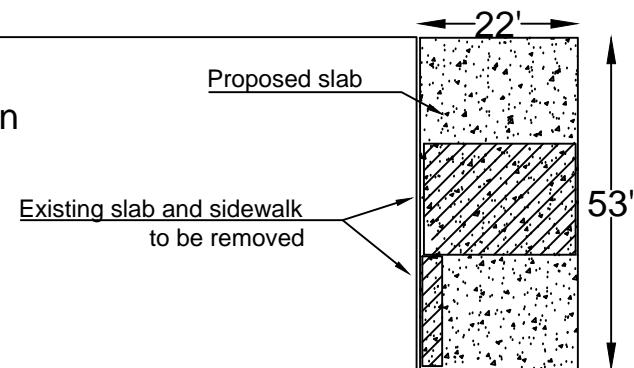

No Scale  
 Park Improvements  
 City of Raymore  
 Spring 2017