

Anastasia Welch →

Jennifer Monheiser

3-22-23

Mark II TS - 800/1000 tons per day

Dumpster Co

potential LF in South R. Co

Mark I single diversion

dept exemption coming to JP

Installed cluster of 60 wells already

as shown in media site location

1/2 mile from Lee Summit, 1/2 mile from Raymore

460 acres that meets 1/2 mile buffer

- Looked at other locations
- This one best 4 business plan
- other pieces we not willing to sell
- they know these owners and are family
they were willing to sell

12, 13, 14, 15, 16, 17 have

26, 22, 23, 24 do not close in 60 days

1-11 under negotiation / contract

have high voltage power lines

some channels / ponds - small wetland

jurisdictional water = corp review

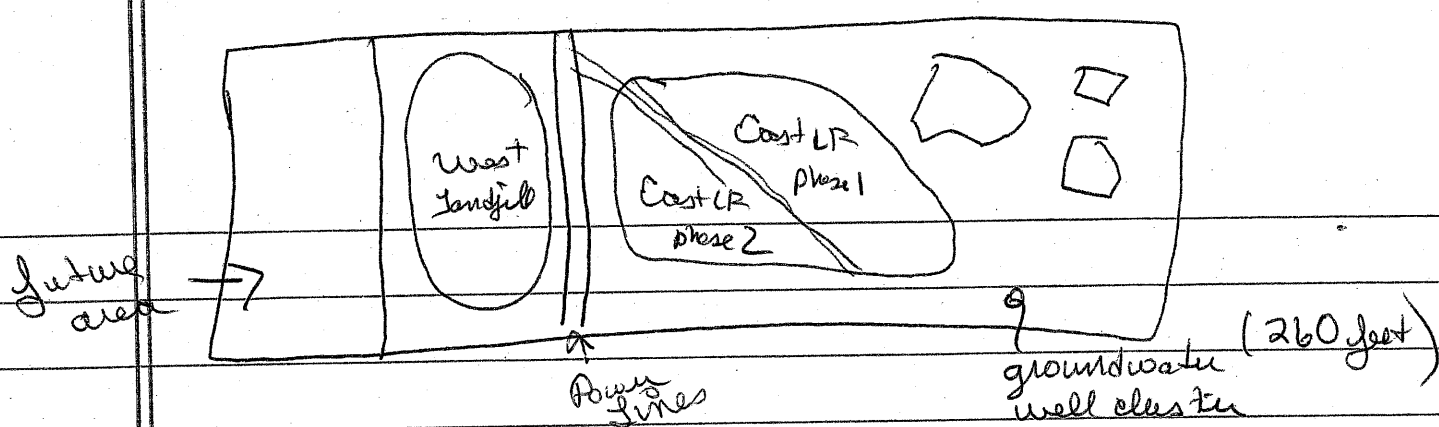

design concept

access of highway required

looking a perimeter berm/screening

Traffic engineer

has designed J turns off Hwy

want rock cushioning - ~~needed~~

public drop off area

aerobic digestion (food waste)

LE Gas to energy

Tentative depth to be determined

have 4 wells already installed on property near

- 1 oil & gas

found 4 potential layers of H₂O

bid in Oct - drilled in Feb

2 bottom areas have water

confining unit - think they have it

Odors are a very big issue

they are aware cannot collect gas for 300 feet wells.

design LF that we can collect gas

200 feet of waste column is target
20-50 feet deep

permitting process w/ KCMO
Local Permitting vs State
made decision to get local permits 1st

plan was

design 1st

Aug submitted to KCMO

now

submit PSI w/ next month

still work w/ KCMO

need to move creek

buffer areas

line of sight

KCMO more concerned w/ buildings/roads
and not landfill

City has 3 public hearing opportunities

12-15 million cubic yards

Duffinberg = 4000 Ton/day

CR 2500 Ton/day

CML 2000-2500 Tons/day

plan is to take our waste & allow others

Traffic study #'s use 2500 tons/day

PSI only for area they own
if acquire more land have to redo PSI etc
on newly acquired property.

located in Jackson County
and inside Kansas City

currently zoned R-80
- residential of 80 acres a more

located on I-50 Highway
I-50 is traffic concern and no where near
they do not own property
below is immediately next to I-50